

- INDEX OF SHEETS
1. TITLE SHEET
 2. BRIDGE QUANTITY SHEET
 3. BRIDGE QUANTITY SHEET (BY GRADES)
 - 4-6. PLAN SHEETS
 - 7-8. PROFILE SHEETS
 9. PLAN & ELEVATION
 - 10-12. $\frac{1}{2}$ " CROSS SECTIONS
 13. SIDE LINE CROSS SECTIONS
 14. CHANNEL CROSS SECTIONS

STATE OF VERMONT
DEPARTMENT OF HIGHWAYS
PROPOSED IMPROVEMENT

**TOWN OF NEWFANE
VERMONT ROUTE #30**

Beginning at a point 0.10 miles north of the intersection of Town Road #17 and Vermont Route #30 and extending north for 0.14 miles.

LENGTH of PROJECT - 0.14 MILES

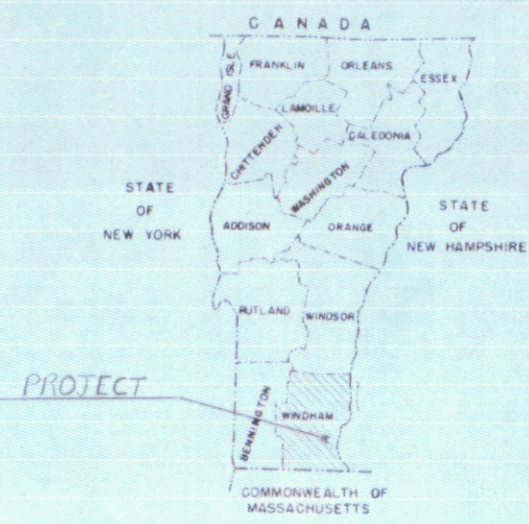
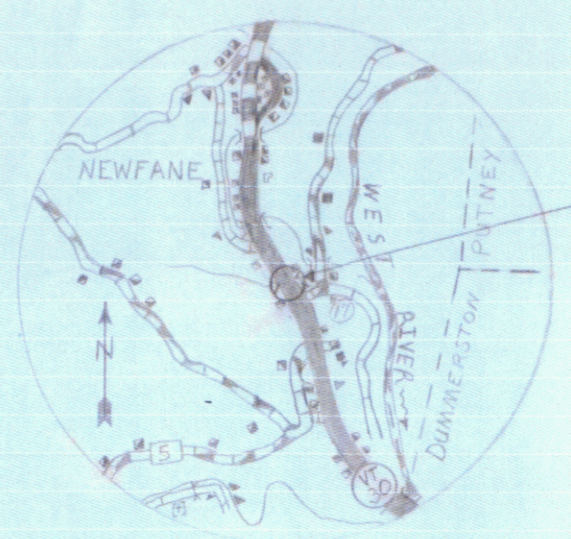

FILE NO.	STATE	PROJECT NO.	DATE	SHEET TOTAL
1	VT			1

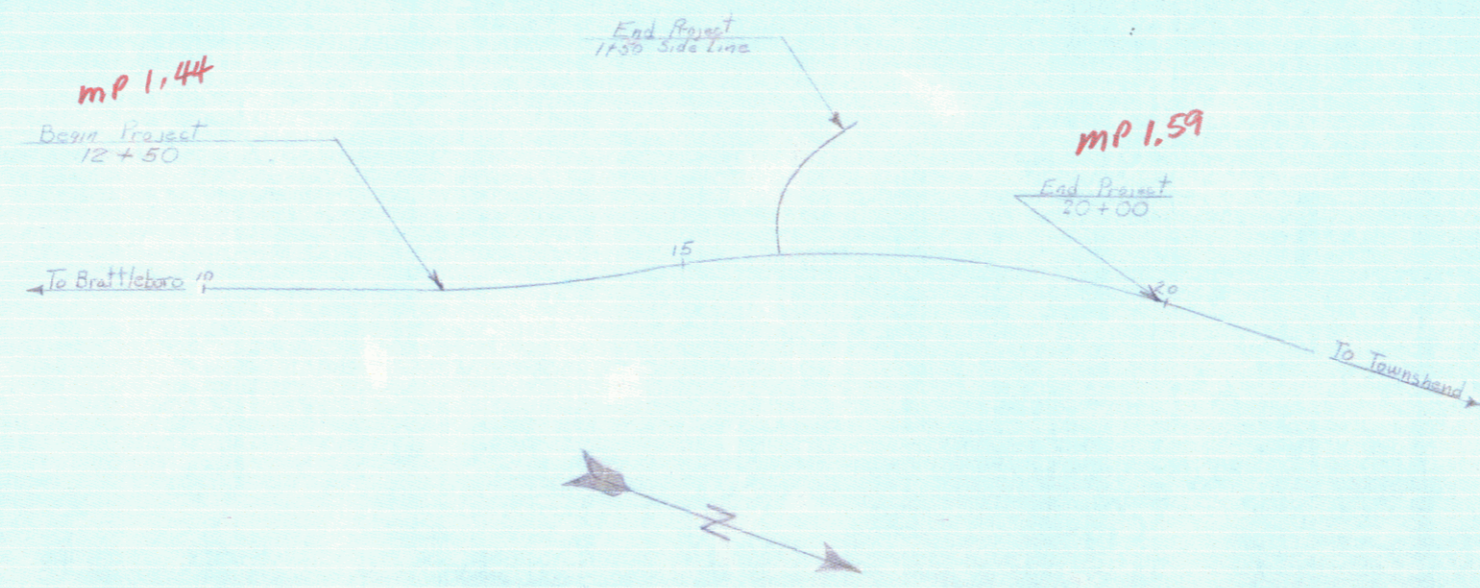

CONVENTIONAL SIGNS

COUNTY LINE	---
TOWN LINE	----
FENCE LINE	-----
STONE WALL	-----
UNFENCED PROPERTY	-----
GUARD RAIL	-----
TRAVELED WAY	-----
RAILROAD	-----
RETAINING WALL	-----
CENTER LINE	-----
SURVEY LINE	-----
GULVERT	-----
DROP INLET	-----
TROLLEY POLE	-----
POWER POLE	-----
TELEPHONE POLE	-----
TREES	-----
WEDGE	-----

GROUND ELEVATION	DATUM	LINE
GRADE ELEVATION	DATUM	LINE
CURVE DATA		
DEFLECTION OF ANGLE	Δ	
DEGREE OF CURVE	D	
RADIUS OF CURVE	R	
TANGENT DISTANCE	T	
LENGTH OF CURVE	L	
EXTERNAL DISTANCE	E	
POINT OF INTERSECTION	PI	
POINT OF CURVE	PC	
POINT OF TANGENT	PT	
POINT ON TANGENT	POT	
POINT ON SUB-TANGENT	POST	

SCALES

TITLE	1" = 100'
TYPICAL	1" = 100'
PLAN	1" = 100'
PROFILE HORIZONTAL	1" = 100'
VERTICAL	1" = 10'
CROSS-SECTIONS	1" = 10'

THESE PLANS ARE SUBJECT TO SUCH REVISIONS AS MAY BE REQUIRED BY THE BUREAU OF PUBLIC ROADS OR THE COMMISSIONER OF HIGHWAYS. CONSTRUCTION IS TO BE CARRIED ON IN ACCORDANCE WITH THE PLANS AND THE STANDARD SPECIFICATIONS FOR HIGHWAY AND BRIDGE CONSTRUCTION OF JANUARY 1956 SUBMITTED TO THE BUREAU OF PUBLIC ROADS AS APPROVED JULY 5, 1956, INCLUDING ALL SUBSEQUENT APPROVED REVISIONS AND SUCH REVISED SPECIFICATIONS AND SPECIAL PROVISIONS AS ARE SUBMITTED WITH THE PLANS.

APPROVED <i>H. Plummer</i> R.O.W. DIRECTOR DATE 5-10-67	APPROVED <i>R. L. Smith</i> CONSTRUCTION ENGINEER DATE 5/16/67	APPROVED <i>J. M. Brown</i> BRIDGE ENGINEER DATE 4/2/67	APPROVED <i>R. O. Plummer</i> DISTRICT ENGINEER DATE 3-27-67	APPROVED <i>E. H. Stebbins</i> ASST. CHIEF ENGINEER DATE 4/5/67	APPROVED <i>W. C. C. [Signature]</i> CHIEF ENGINEER DATE 4/5/67
---	--	---	--	---	---

DEPARTMENT OF COMMERCE BUREAU OF PUBLIC ROADS	
APPROVED <i>W. C. C. [Signature]</i> DIVISION ENGINEER	DATE
PROJECT <i>NEWFANE</i> NO. <i>BP-0119-0026</i>	
SHEET <i>1</i> OF <i>14</i> SHEETS	