

INDEX OF SHEETS

SHEET NO. 1	TITLE PAGE
2	TYPICAL CROSS-SECTION OF IMPROVEMENT GRADING, BASE, DRAINAGE & GUARD RAIL WITH DOUBLE TACK COAT OF REFINED TAR (ITEM 29)
3	BANKING AND WIDENING TABLES
4-8	PLAN AND PROFILE
9	DETAIL OF ABUTMENT NO. 1
10	" " " NO. 2
11	" " PIER NO. 1
12	" " " NO. 2
13	DETAILS OF SUPERSTRUCTURE
14	STRESS SHEET
15	STANDARD STRUCTURE SHEET 5-28 PIPE CULVERTS
16	" " " 5-30 GUARD RAIL
17	" " " 5-31 BOUNDARY MARKERS
18	" " " 5B-11 BARRICADES, SIGN & LIGHTS
19	" " " 5B-5C CABLE GUARD RAIL
20	" " " 5B-20 DETAILS E, K, L & GEN. NOTES
21	" " " 5B-1 DETAILS 55 & 56
22-24	CROSS-SECTIONS

FED. ROAD DIST. NO.	STATE	STATE PROJ. NO.	TOTAL SHEETS	TOTAL SHEETS
9	VT.	159-N	1	34

STATE OF VERMONT  
STATE HIGHWAY DEPARTMENT

PLAN AND PROFILE OF PROPOSED  
STATE HIGHWAY

TOWNS OF DUMMERSTON-NEWFANE

VT ROUTE 30, BRATTLEBORO-NEWFANE ROAD

Pin # 00R347  
Project: ST 159N

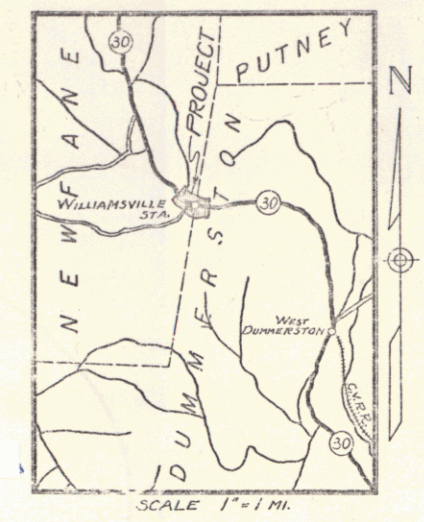

BEGINNING AT A POINT 1061± FT. EAST OF THE DUMMERSTON-NEWFANE TOWN LINE AND EXTENDING WESTERLY 0.383 MI. TO A POINT 963± FT. WEST OF THE DUMMERSTON-NEWFANE TOWN LINE

LENGTH EXCL. BRIDGE	1733.3 FT. = 0.328 MI.
LENGTH OF BRIDGE	291.0 FT. = 0.055 MI.
LENGTH INCL. BRIDGE	2024.3 FT. = 0.383 MI.

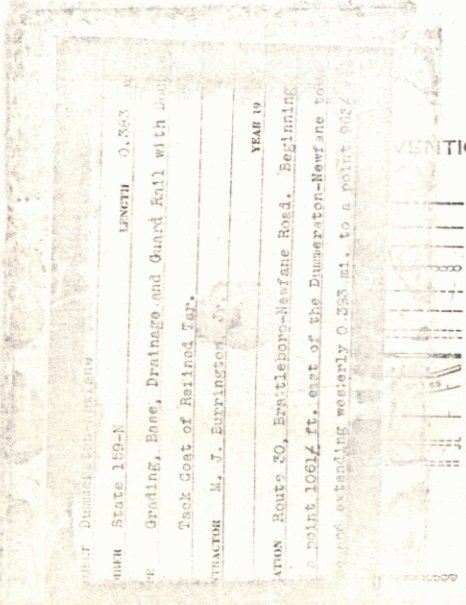

VERTICAL SIGNS

GROUND ELEVATION	DATUM	LINE
GRADE ELEVATION	DATUM	LINE

CURVE DATA

DEFLECTION ANGLE	Δ
DEGREE OF CURVE	D
RADIUS OF CURVE	R
TANGENT DISTANCE	T
LENGTH OF CURVE	L
EXTERNAL DISTANCE	E
POINT OF INTERSECTION	P. I.
POINT OF CURVE	P. C.
POINT OF TANGENT	P. T.
POINT ON TANGENT	P. O. T.

SCALES

TITLE	1" = 300'
TYPICAL	1" = 2'
PLAN	1" = 20'
PROFILE	HORIZ. 1" = 20'
	VERT. 1" = 10'
CROSS SECTION	1" = 5'

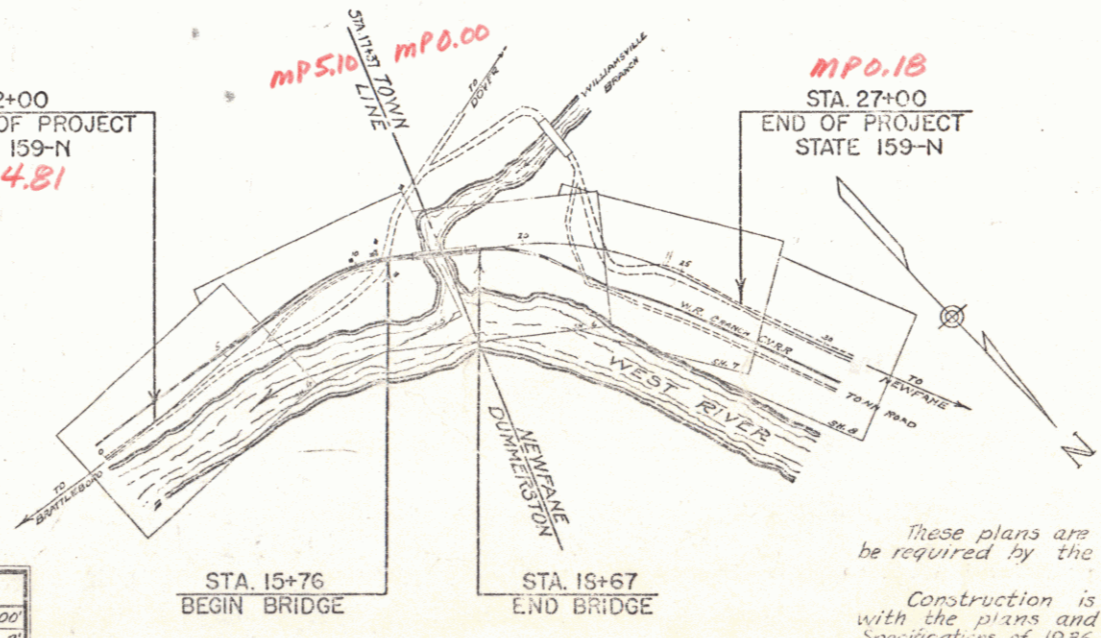

These plans are subject to such revisions as may be required by the Commissioner of Highways.

Construction is to be carried on in accordance with the plans and Standard Road and Bridge Specifications of 1936, as approved December 23, 1936 by the Bureau of Public Roads, including all subsequent approved revisions and such revised specifications and special provisions as are submitted with the plans.

APPROVED: July 15, 1937  
Commissioner of Highways

RECOMMENDED  
DISTRICT ENGINEER  
RECOMMENDED FOR APPROVAL  
CHIEF ENGINEER  
APPROVED  
DIRECTOR-BUREAU OF PUBLIC ROADS

APPROVED: July 15, 1937  
DISTRICT COMMISSIONER  
CORRECTED: July 2, 1937  
DISTRICT ENGINEER  
SERIES 159-N  
SHEET 1

STEARNS R. JENKINS