

THREE CABLE GUARD RAIL WITH STEEL POSTS
 462132-463128 461100-462198.8
 473117-474161

TREATED TIMBER CURB
 461100-461150

CONSTRUCT DRIVE
 Apr 468+71.5 467+50
 @ 3'00" L 475+40-475+90
 475+30

CONSTRUCT APPROACH
 468171.5

EXCAVATION AND REMOVAL OF ROAD SURFACES & PAYMENTS
 461100-464100

DEMOLITION AND DISPOSAL OF BUILDING
 468+85 (#20)

REMOVAL AND DISPOSAL OF PRESENT GUARD RAIL
 469108-469146 468184-469105
 472116-474162 472120-475122

DRILLING AND BLASTING OF SOLID ROCK SUBGRADE
 461+80 - 466+25
 468+71.5 L 1 @
 Appn 0+60 - 1+75

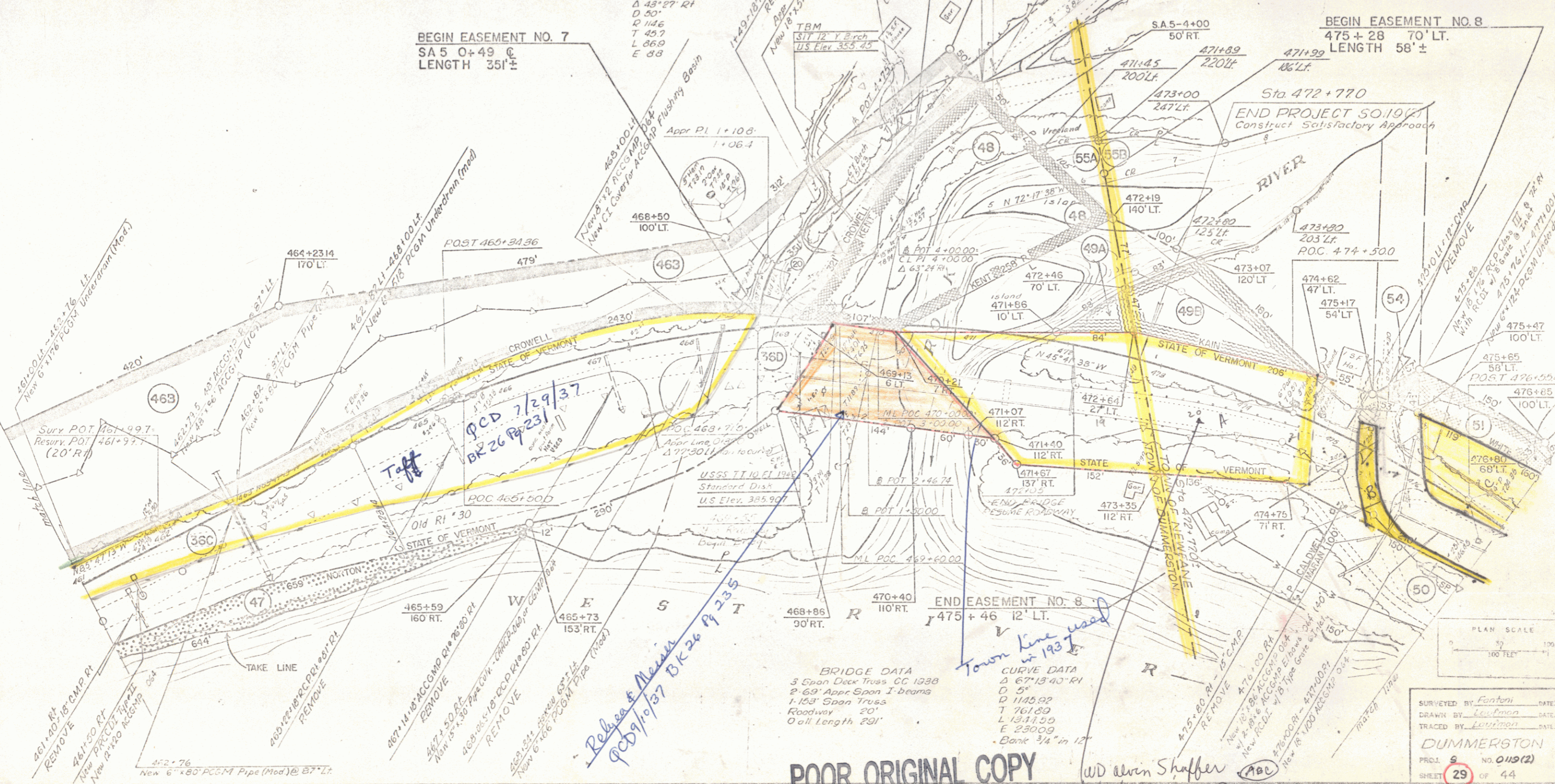

POOR ORIGINAL COPY

WD Alvin Shaffer (ABC)
 8/28/37 BK 29 P 408

SURVEYED BY Fenton DATE May 1897
 DRAWN BY Leffman DATE May 1897
 TRACED BY Leffman DATE May 1897

DUMMERSTON
 PROJ. S NO. 0119(2)
 SHEET 29 OF 44