

THREE CABLE GUARD RAIL WITH STEEL POSTS LH 143+57-143+75 143+50-150+00	STONE FILL (HEAVY TYPE) LH 134+00-137+75 145+75-150+00	UNCLASSIFIED CHANNEL EXCAVATION LH 143+65 145+75-150+00 143+65	CONSTRUCT DRIVE RH 147+50 148+74 135+50	DEMOLITION AND DISPOSAL OF BUILDING LH 147+70-51 130+75(14)
EXCAVATION AND REMOVAL OF ROAD SURFACE ON ROADWAYS LH 134+00-143+50	REMOVAL AND DISPOSAL OF PRESENT GUARD RAIL LH 142+60-144+00 143+16-143+66	12" BLANKET OF GRAVEL BACKFILL RH 134+00-137+75 145+75-148+25	CONSTRUCT SPEC'L DITCH (to be paid for under the item of 103-A-2) LH 134+00-136+75	REMOVAL AND DISPOSAL OF PRESENT GUARD RAIL LH 134+00-134+35 142+60-143+00 143+16-143+66

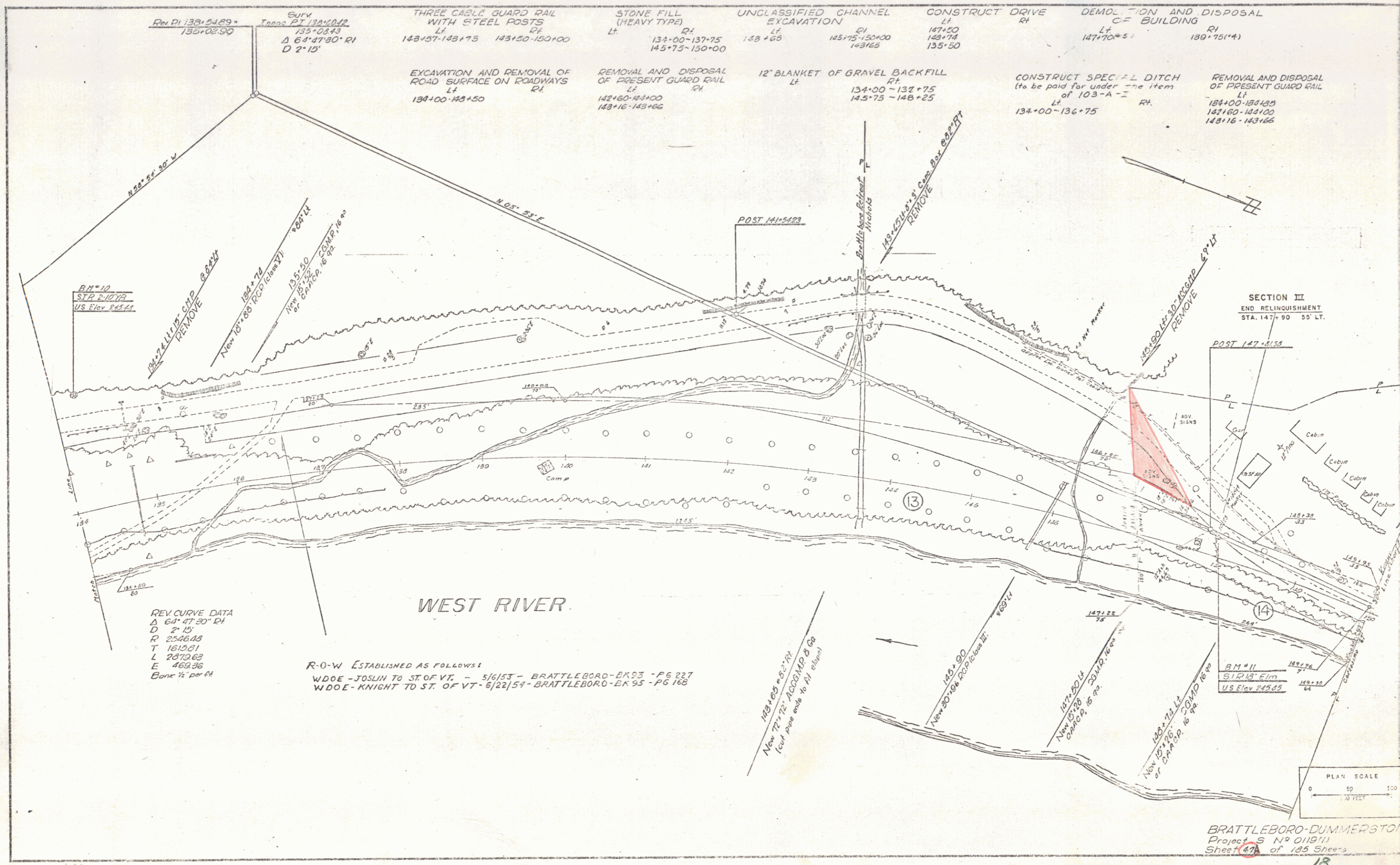

BM #10
STP 2-10-72
US Elev 143.41

REV CURVE DATA
Δ 64° 47' 30" RI
D 2' 15"
R 2546.03
T 1615.31
L 2879.69
E 469.36
Bare 1/2" per ft

R-O-W Established as follows:
WDOE - JOSLIN TO ST. OF VT. - 5/6/53 - BRATTLEBORO-BA93 - PG 227
WDOE - KNIGHT TO ST. OF VT. - 5/22/54 - BRATTLEBORO-BA 95 - PG 168

PLAN SCALE
0 50 100
FEET

BRATTLEBORO-DUMMERSTON
Project S 142 0119(1)
Sheet 47 of 135 Sheets
13