

| | | | | | | | |
|--|--|--|--|---|---|--|--------------------------------------|
| 3' ONE COURSE CEMENT CONCRETE SIDEWALK Lt 25+75-29+73 30+40-26+10 | BITUMINOUS CONCRETE SIDEWALK Lt 41+15-43+00 | GRANITE CURB Lt 29+75-29+79 30+40-33+25 | CONSTRUCT DRIVE Lt 34+30 36+00 37+00 40+00 38+00 | CONSTRUCT APPROACH Lt 30+00 | TREATED TIMBER CURB Lt 28+39-37+03 | THREE CABLE GUARD RAIL WITH STEEL POSTS Lt 28+39-37+03 | MUCK EXCAVATION Lt 37+00-43+00 |
| STONE FILL(LIGHT TYPE) Lt 32+75-43+00 | UNCLASSIFIED CHANNEL EXCAVATION Lt 32+75-36+75 | BITUMINOUS GUTTER Lt Appr Sta 1+78-3+00 | CONSTRUCT TURNOUT Lt 28+50-31+20 | 12" BLANKET OF GRAVEL BACKFILL Lt 32+75-43+00 | EXCAVATION AND REMOVAL OF ROAD SURFACE ON ROADWAYS Lt 36+00-37+00 | 3' GRANULAR BORROW Lt 37+00-43+00 | |
| REMOVAL AND DISPOSAL OF PRESENT GUARD RAIL Lt 33+60-35+00 35+05-40+00 | PAVED SHOULDERS Lt 28+39-37+03 | | | | | | |

- GENERAL NOTES**
- The depth of drop inlets is from the top of the grate or the seat for the cover to the bottom of the opening or floor.
 - Gravel, Item 22P shall be used to stabilize cut slopes, as indicated on the plans or as ordered by the Engineer.
 - All drives shall be constructed with a 12 foot minimum width and a 15 foot minimum flare radius.
 - Use 12' roadway & 10' shoulder typical (sheet 2 of 185) from Sta 31+20 to Sta 57+00 and 12' roadway & 6' shoulder typical (sheet 3 of 185) from Sta 59+00 to Sta 279+366.
 - Paved shoulder from Sta 28+39 Rt to Sta 37+03 Rt to be paved with item 361-B.

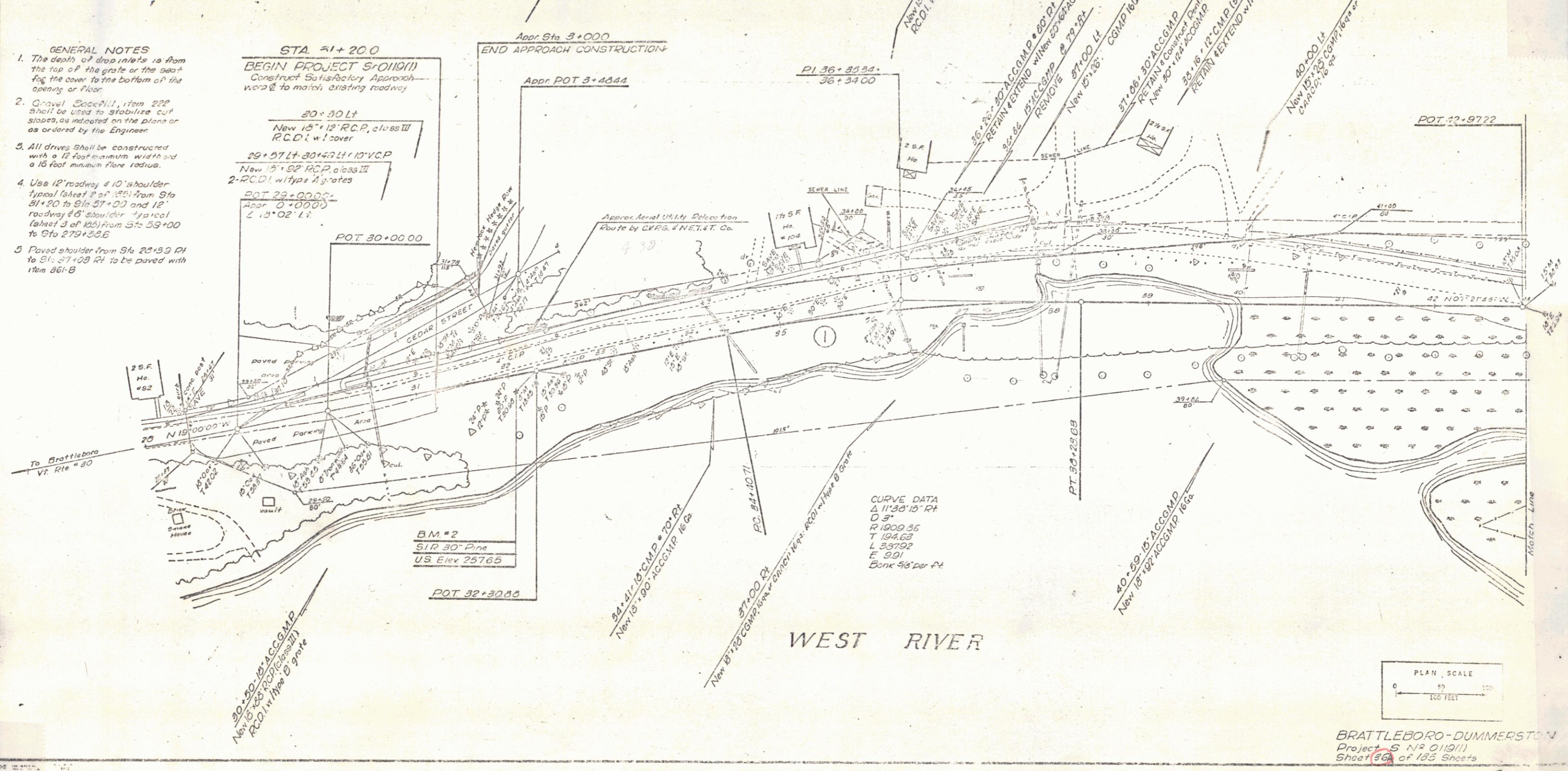

BRATTLEBORO-DUMMERSTON
Project S N 011911
Sheet 36 of 185 Sheets