

GRANITE CURB
 CONSTRUCT DRIVE
 EXCAVATION AND REMOVAL OF ROAD SURFACE ON ROADWAYS
 BITUMINOUS GUTTER
 CONSTRUCT TURNOUT
 UNCLASSIFIED CHANNEL EXCAVATION
 STONE FILL (LIGHT TYPE)
 REMOVAL AND DISPOSAL OF PRESENT GUARD RAIL
 PAVED SHOULDERS
 GRANULAR BORROW

STA 31+20
 BEGIN PROJECT SFO1971
 Construct Satisfactory Approach
 work to match existing roadway

- GENERAL NOTES**
- The depth of drop inlets is from the top of the grate or the seat for the cover to the bottom of the opening or floor.
 - Gravel, Brock III, item 202, shall be used to stabilize cut slopes as indicated on the plans or as ordered by the Engineer.
 - All drives shall be constructed with a 12 inch minimum width and a 15 foot minimum flow width.
 - Use 12" roadway & 10" shoulder. Typical sheet 2 of 1001 from Sta 31+20 to Sta 37+00 and 12" roadway & 10" shoulder. Typical sheet 3 of 1001 from Sta 39+00 to Sta 42+00.
 - Paved shoulder from Sta 39+33.01 to Sta 39+33.01 to be covered with item 301-3.

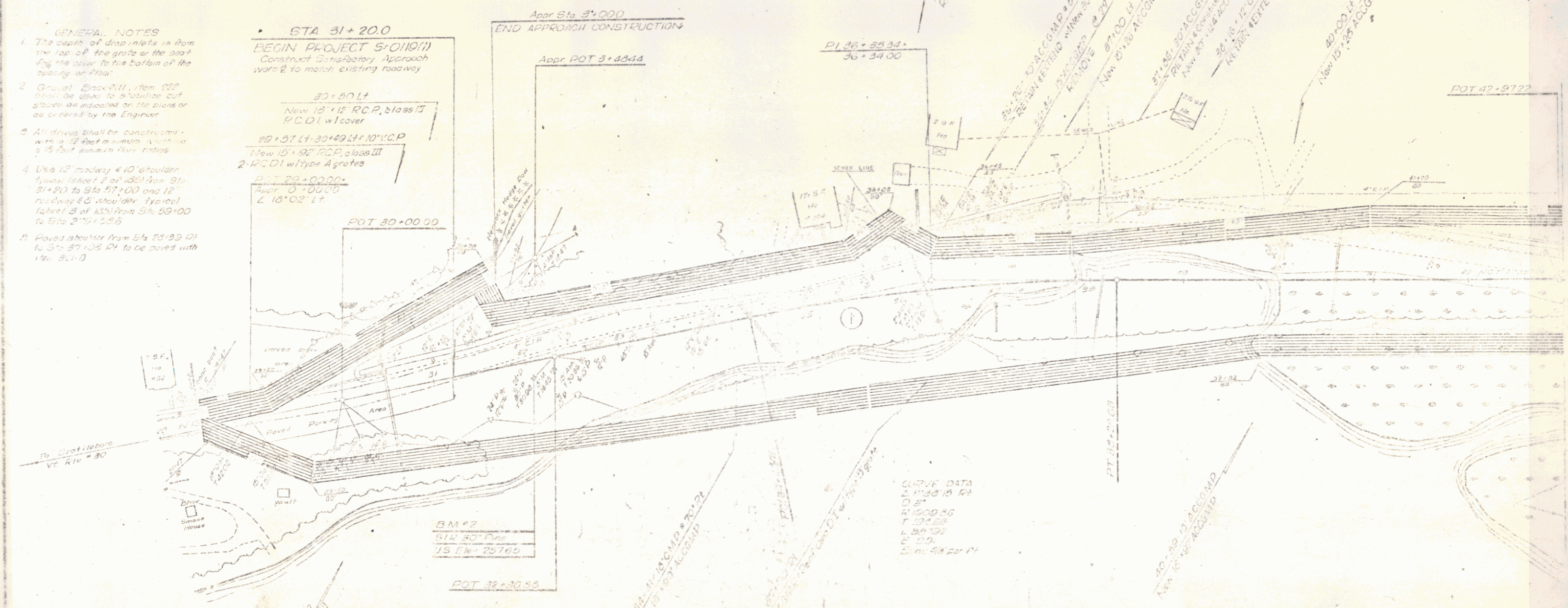

POOR ORIGINAL COPY