

INDEX OF SHEETS

SHEET NO.	TITLE PAGE
1	TYPICAL CROSS-SECTION OF IMPROVEMENT ^{2 1/2"} CRUSHED GRAVEL MIXED IN PLACE SURFACE COURSE, ITEM 25, WITH CUTBACK ASPHALT, ITEM 31, AND PRIME COAT OF ASPHALT TAG, ITEM 30.
2	BANKING AND WIDENING TABLES
3-8	PLAN AND PROFILE
9	STANDARD STRUCTURE SHEET S-28 PIPE CULVERTS
10	" " " S-30 GUARD RAIL
11	" " " S-30A BOUNDARY MARKERS
12	" " " S-40 BARRICADES SIGNS AND LIGHTS
13	" " " S-41 ROUNDING OF SLOPES
14-36	CROSS SECTIONS

STANDARD STRUCTURE SHEETS APPROVED BY THE CHIEF ENGINEER V.S.H.D.
 S-28 APRIL 26 1941
 S-30 MAY 12 1941
 S-30A APRIL 19 1941
 S-40 DEC 18 1945

STATE OF VERMONT

STATE HIGHWAY DEPARTMENT

PLAN AND PROFILE OF PROPOSED STATE HIGHWAY

FEDERAL AID PROJECT SECONDARY

TOWN OF WINHALL

RELOCATION OF A SECTION OF ROUTE 30

BEGINNING AT A POINT ON ROUTE 11 1.020 MILES WESTERLY FROM THE PERU-WINHALL TOWN LINE AND EXTENDING SOUTHERLY ON A RELOCATION 0.881 MILES TO ITS INTERSECTION WITH ROUTE 30.

LENGTH OF MAIN LINE 4652.5 FEET = 0.881 MILES
 LENGTH OF "E" LINE 255.0 FEET = 0.048 MILES
 LENGTH OF PROJECT 4907.5 FEET = 0.929 MILES

FED. ROAD DIST. NO.	STATE	F.A.S. YEAR	TOTAL SHEETS	TOTAL SHEETS
9	Vt.	43(1)	1	36

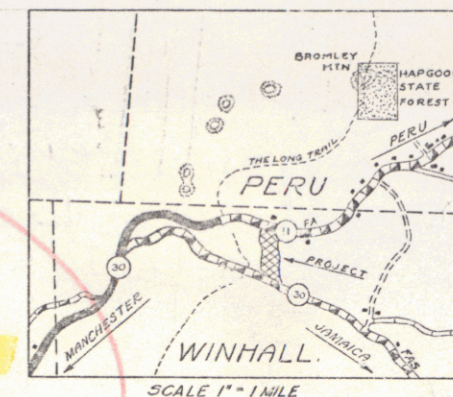

Route: VT 30
 Project: FAS 43(1)
 Pin: OOR 343
 Date: 01/01/1948

RECORD PLANS
 Prepared by: C.F. Roberts
 Resident Engr. - E.H. Strickney
 E.W. Carley
 Inspector - W.H. Henry

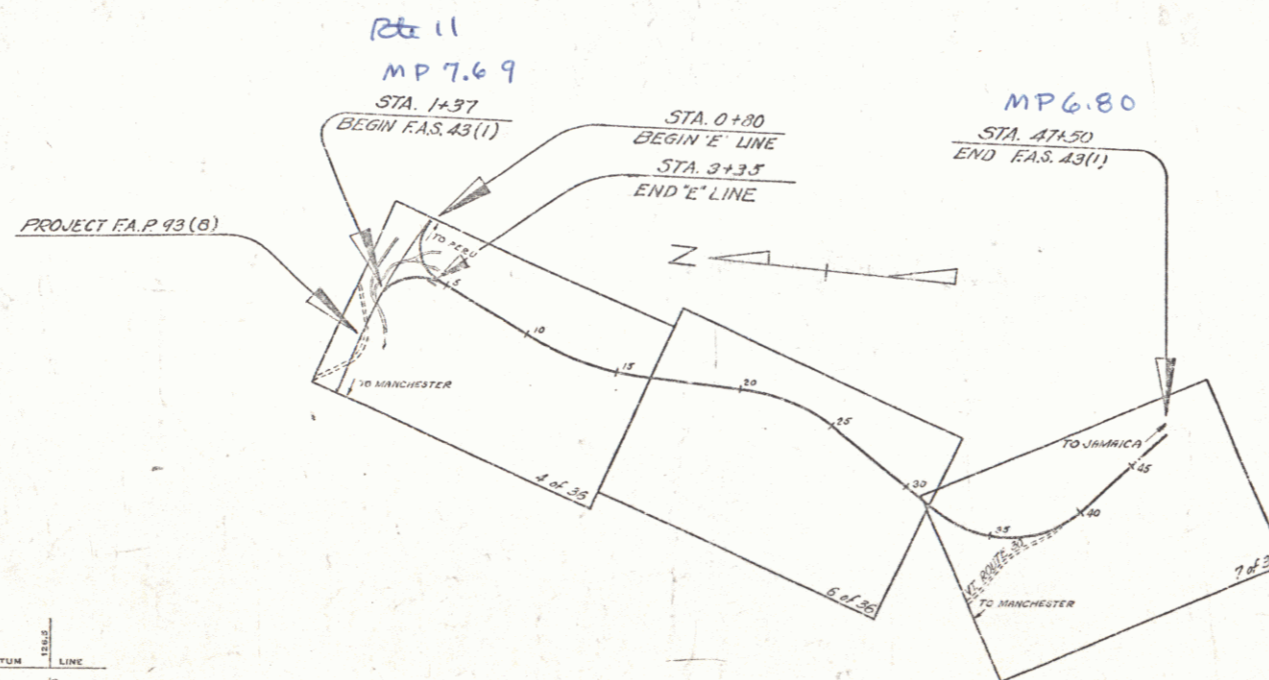

PROJECT	LENGTH
Winhall	0.929 MI.
FAS 43(1)	
TYPE	2 1/2" CRUSHED GRAVEL MIXED IN PLACE SURFACE COURSE WITH CUTBACK ASPHALT AND PRIME COAT OF ASPHALT TAG.
CONTRACTOR	W. H. Strickney, Inc., Balltown, Vermont
DATE	Completed August 1, 1948
LOCATION	Relocation Route 30 at a point on Route 11, 1.020 miles westerly from the Peru-Winhall T.L. extending southerly on a relocation 0.881 mi. to its intersection with R. 30.

RECORDED PLANS
 Winhall - FAS 43(1)
 Council for - F.H. Whitcomb - 1948

GROUND ELEVATION	DATUM	SCALE
.....
GRADE ELEVATION	DATUM	SCALE
.....

CURVE DATA	DEFLECTION ANGLE	DEGREE OF CURVE	RADIUS OF CURVE	TANGENT DISTANCE	LENGTH OF CURVE	EXTERNAL DISTANCE	POINT OF INTERSECTION	POINT OF CURVE	POINT OF TANGENT	POINT ON TANGENT
.....

TITLE	SCALE
TYPICAL	1" = 300'
PLAN	1" = 50'
PROFILE	HORIZONTAL 1" = 50'
	VERTICAL 1" = 10'
CROSS SECTIONS	1" = 0'

THESE PLANS ARE SUBJECT TO SUCH REVISIONS AS MAY BE REQUIRED BY THE PUBLIC ROADS ADMINISTRATION OR THE COMMISSIONER OF HIGHWAYS.
 CONSTRUCTION IS TO BE CARRIED ON IN ACCORDANCE WITH THE PLANS AND THE STANDARD ROAD AND BRIDGE SPECIFICATIONS OF 1936, AS APPROVED DECEMBER 31ST, 1936 BY THE PUBLIC ROADS ADMINISTRATION, INCLUDING ALL SUBSEQUENT APPROVED REVISIONS AND SUCH REVISED SPECIFICATIONS AND SPECIAL PROVISIONS AS ARE SUBMITTED WITH THE PLANS.

APPROVED: [Signature] DISTRICT HIGHWAY COMMISSIONER
 APPROVED: [Signature] DISTRICT HIGHWAY COMMISSIONER
 SERIES FAS NO. 43(1) FILED
 SHEET 1 OF 36

STEARNS R. JENKINS
 12-1-48
 pte 30 1

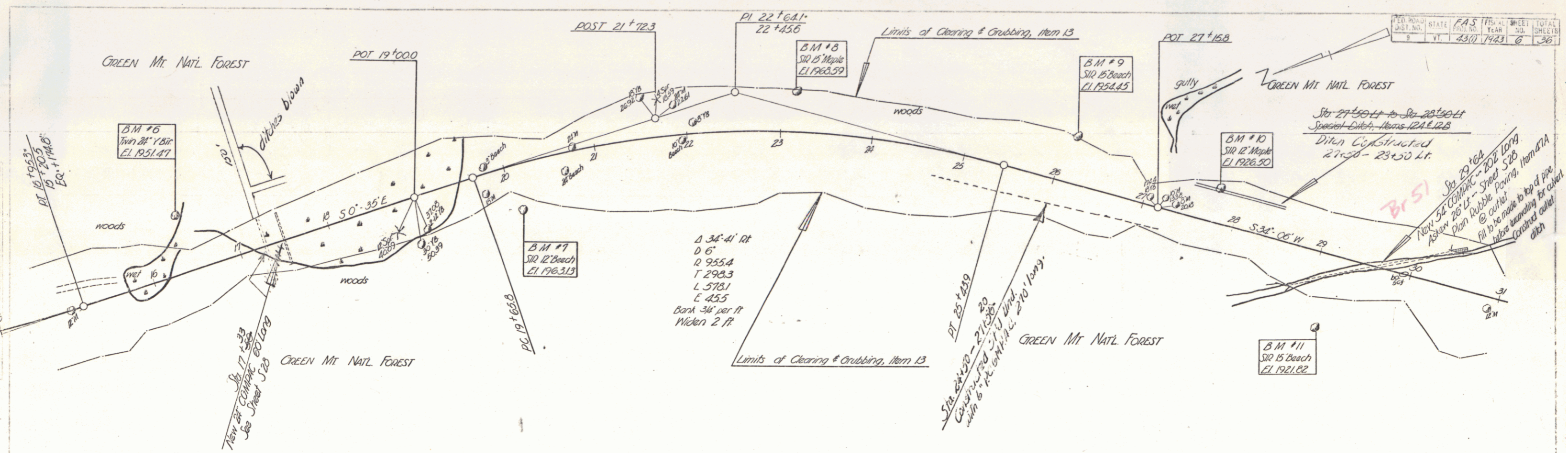

FED. ROAD DIST. NO.	STATE	F.S. NO.	F.S. YEAR	SHEET NO.	TOTAL SHEETS
	VT	4370	1943	6	36

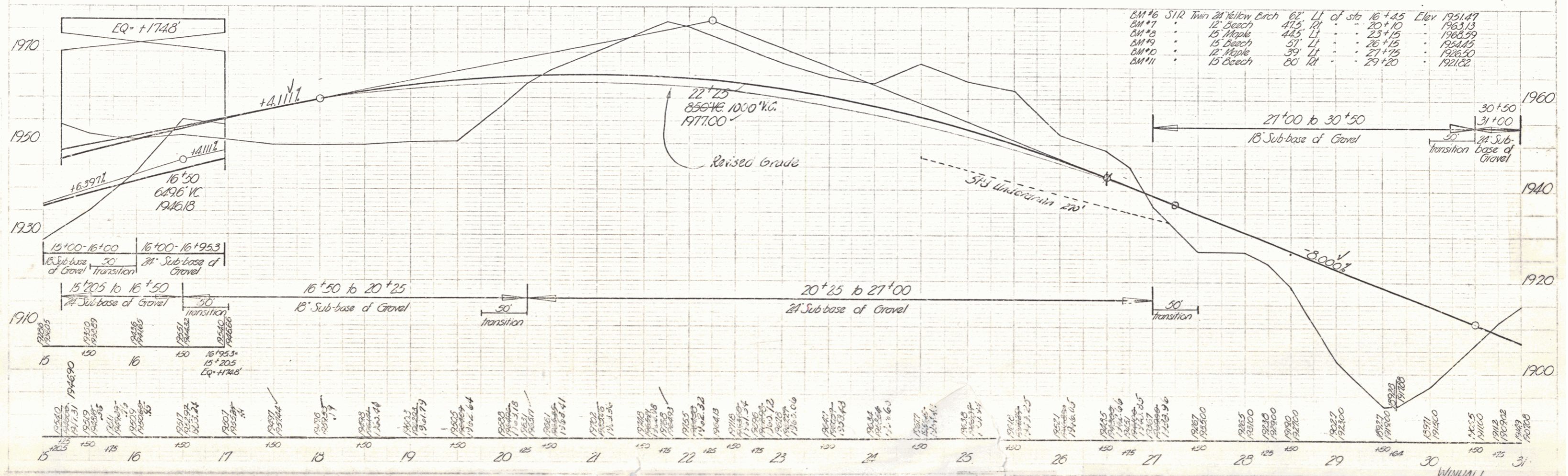

B.M. #6	SIR	Tree	21' Yellow Birch	62'	LI of str	16+45	Elev	1951.47
B.M. #7			12' Beech	47.5'	TL	20+10		1963.13
B.M. #8			15' Maple	44.5'	LI	23+15		1968.59
B.M. #9			15' Beech	51'	LI	26+15		1964.45
B.M. #10			12' Maple	39'	LI	27+15		1968.30
B.M. #11			15' Beech	60'	TL	29+20		1921.82

WINNALL
SERIES 6AS NO. 43 (1)
Sheet 6 of 36 Sheets
3

