

PARCEL	INSTRUMENT	DATE	GRANTOR	GRANTEE	RECORDED TOWN OF	Book	Page	Date	REMARKS
14	WDOE	1-16-56	WILLIAM J. ORHELEIN & CHARLES C. HIGGINS	ST. OF VT.	WINHALL	18	123	2-7-56	See also sheet 28. Also slope rights.
15 A	WDOE	1-19-56	DWIGHT W. & CLARA C. BOURN	ST. OF VT.	WINHALL	18	121	2-3-56	Also slope rights.
16	Cond	7-8-55	PAUL KOLLSMAN	ST. OF VT.	WINHALL	17	445-460	7-3-55	See notice of report of hearing. See also sheet 30.
15 B	WDOE	6-29-56	DWIGHT W. & CLARA C. BOURN	ST. OF VT.	WINHALL	18	155	7-16-56	Culvert Rights

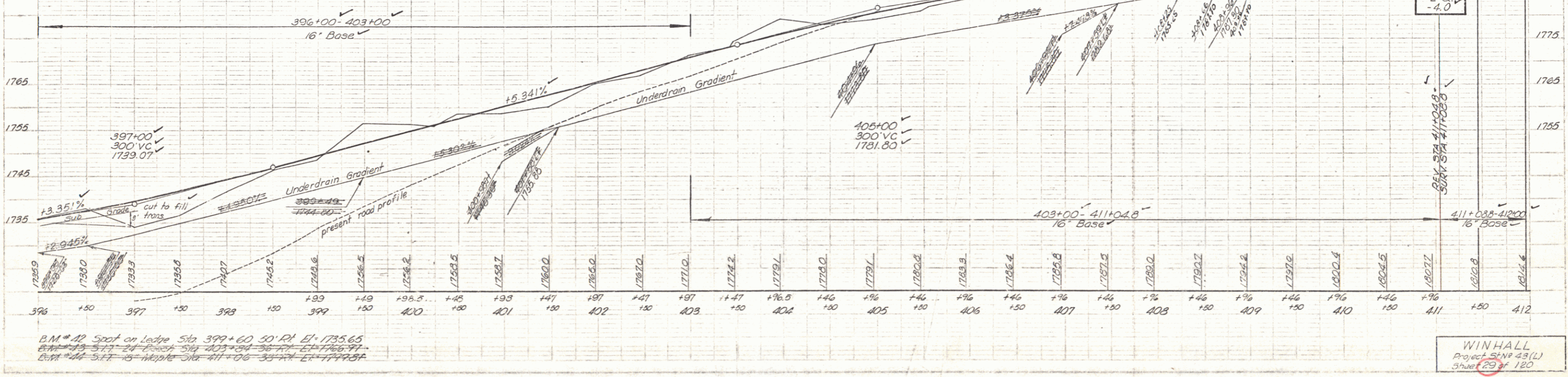

B.M. #42 Spot on Ledger Sta. 399+60.50 RT. El. 1735.65  
 B.M. #15 577-24 Post Sta. 403+34.36 RT. El. 1766.97  
 B.M. #14 577-15 Marker Sta. 411+06.33 RT. El. 1779.87

WINHALL  
 Project 5414 23(L)  
 Sheet 29 of 120

9-54  
 Lawson  
 12-54

1-55  
 Lawson  
 12-54