

INDEX OF SHEETS

SHEET NO. 1	TITLE PAGE
" 2-3	TYPICAL CROSS-SECTION OF IMPROVEMENT (GRADING, BASE & DRAINAGE WITH DOUBLE TACK COAT OF RETINED TAR ITEM 29)
" 4	BANKING AND WIDENING TABLES
" 5-13	PLAN AND PROFILE SHEETS
" 14	STANDARD STRUCTURE SHEET 520; PIPE CULVERTS
" 15	" " " 530; GUARD RAIL
" 16	" " " 531; BOUNDARY MARKERS
" 17	" " " 540; BARRICADES, SIGNS & LIGHTS
" 18-39	CROSS-SECTION SHEETS

Standard Structure Sheet 520 approved by the Chief Engineer on July 14, 1933

Standard Structure Sheet 530 approved by the Chief Engineer on Aug 15, 1933

Standard Structure Sheet 531 approved by the Chief Engineer on July 25, 1934

PER ROAD DIST. NO.	STATE FISCAL YEAR	SHEET NO.	TOTAL SHEETS
9	VT. 180L 1934	1	59

**STATE OF VERMONT
STATE HIGHWAY DEPARTMENT**

**PLAN AND PROFILE OF PROPOSED
STATE HIGHWAY**

STATE PROJECT

TOWN OF JAMAICA

BRATTLEBORO-MANCHESTER ROAD

FROM FRENCH BRIDGE OVER THE WEST RIVER, NORTHERLY
2.095 MILES, TO A POINT 400 FT WEST OF THE BRIDGE OVER
BALL MOUNTAIN BROOK.

11,024.8 2.088

LENGTH OF PROJECT ~~11,024.8~~ FT. = ~~2.095~~ MILES

Projid: ST180L
Route: VT30
Pin: 00R 338
Date 04/20/1936

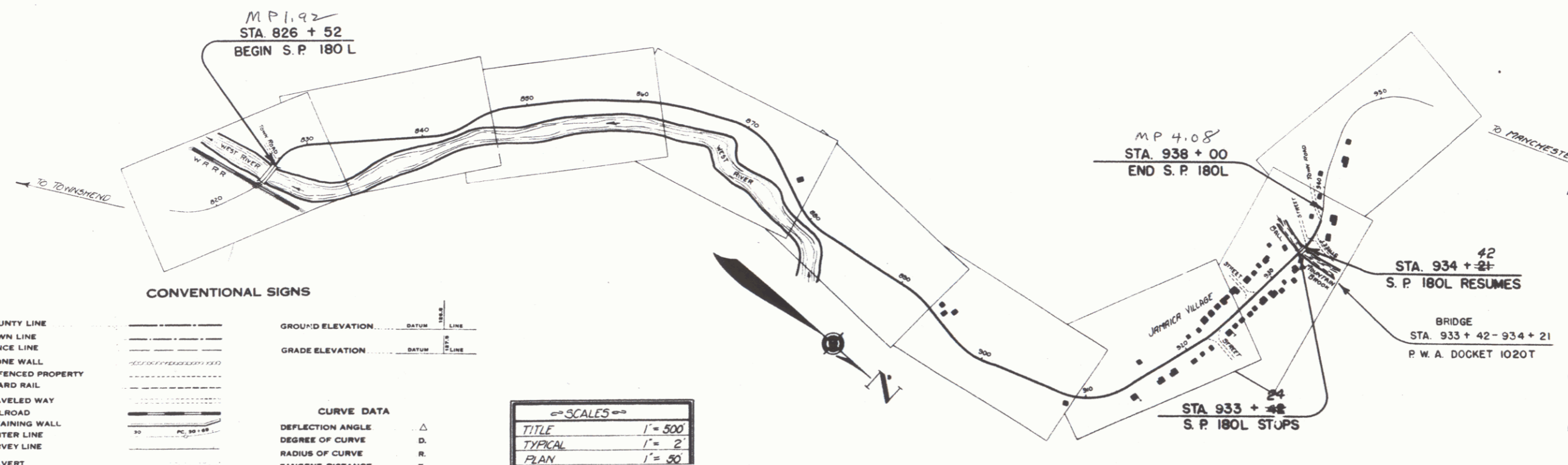
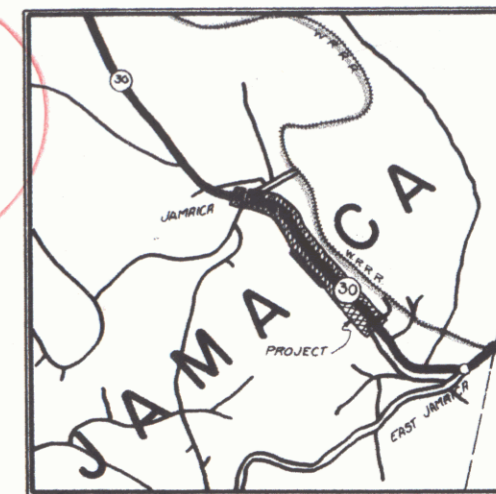

CONVENTIONAL SIGNS

COUNTY LINE	GROUND ELEVATION	DATE	LINE
TOWN LINE	GRADE ELEVATION	DATE	LINE
FENCE LINE			
STONE WALL			
UNFENCED PROPERTY			
GUARD RAIL			
TRAVELED WAY			
RAILROAD			
RETAINING WALL			
CENTER LINE			
SURVEY LINE			
CULVERT			

SCALES

TITLE	1" = 500'
TYPICAL	1" = 2'
PLAN	1" = 50'

APPROVED: APRIL 20 1936
COMMISSIONER OF HIGHWAYS
SUBMITTED BY ORDER OF THE STATE HIGHWAY BOARD

RECOMMENDED: [Signature]
DISTRICT ENGINEER BUREAU OF PUBLIC ROADS

RECOMMENDED FOR APPROVAL: [Signature]
CHIEF ENGINEER