

POOR ORIGINAL COPY

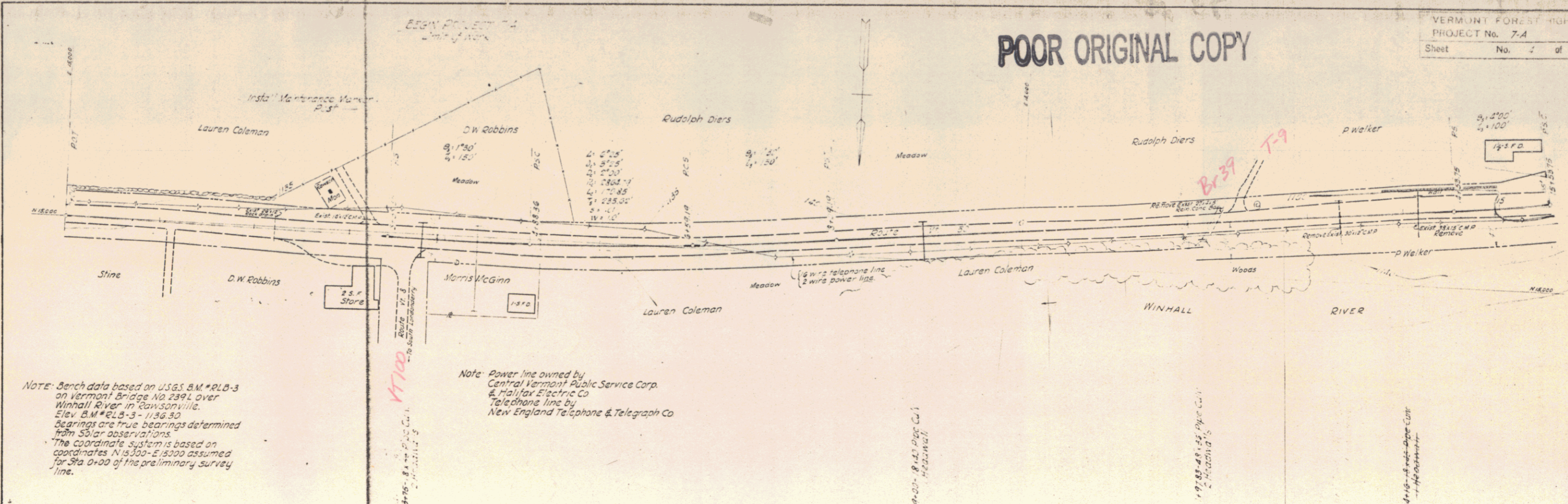

NOTE - Bench data based on USGS B.M. #RLB-3 on Vermont Bridge No. 2391 over Winhall River in Rawsonville. Elev. B.M. #RLB-3 - 1136.50 bearings are true bearings determined from solar observations. The coordinate system is based on coordinates N 15300 - E 13000 assumed for Sta 0+00 of the preliminary survey line.

Note - Power line owned by Central Vermont Public Service Corp. & Halifax Electric Co. Telephone line by New England Telephone & Telegraph Co.

PLAN	DATE

PROFILE	DATE

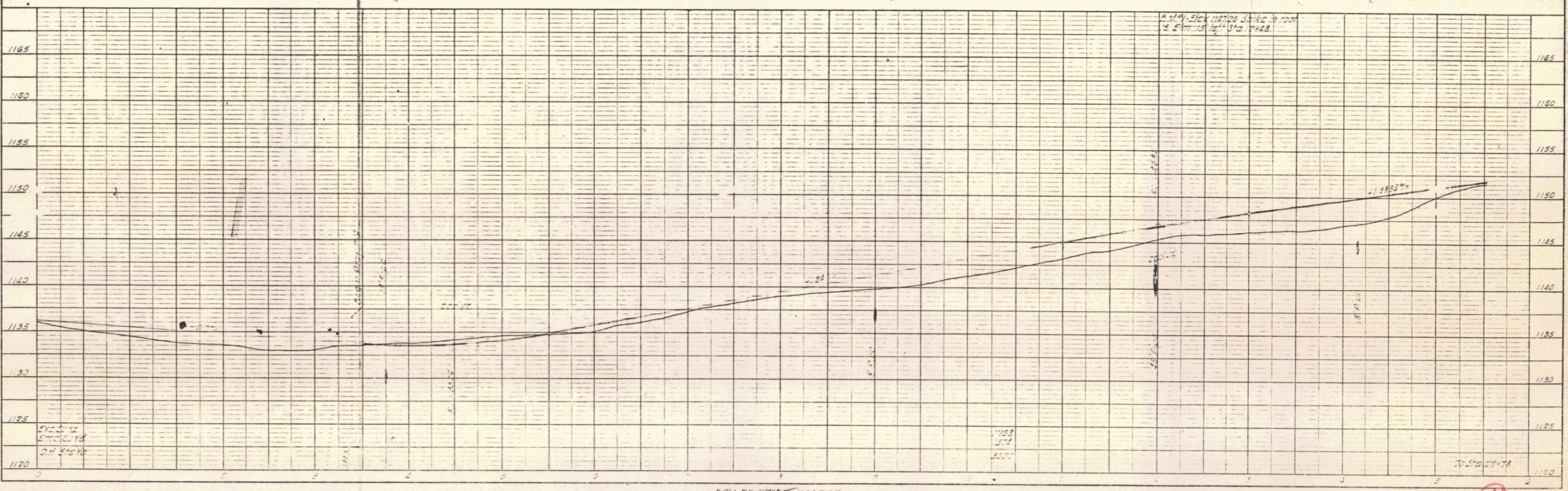

4