

1. TITLE
  2. QUANTITY AND EARTHWORK SHEET
  3. RIGHT OF WAY DETAIL SHEET
  4. PLAN
  5. PROFILE, BORINGS, & TYPICAL SECTION
  6. SUPERSTRUCTURE DETAILS & GENERAL NOTES
  7. ABUTMENT DETAILS
  8. PIER DETAILS
  9. REINFORCING SCHEDULE
  - 10/11. ROADWAY SECTIONS
  - 12-16. CHANNEL SECTIONS
- BRIDGE STANDARDS
17. SCB-DI-71 1-24-72
  18. SCB-D6-71, DET. A 12-14-71
  19. SB-R4-71 12-14-71
- ROADWAY STANDARDS
20. B-5 EMBANKMENT ON EARTH SLOPE 12-6-71
  21. E-3 BRIDGE CONSTRUCTION APPROACH SIGNS 12-14-71
  22. E-5 ROAD CONSTRUCTION SIGNS-BETTERMENT PROJECTS 12-14-71
  23. E-7 BARRICADES 12-14-71
  24. G-16 GUARD RAIL BOX BEAM WITH STEEL POSTS 10-1-71
  25. J-1 ERECTION OF PROJECT MARKERS, BOUNDARY MARKERS 12-6-71

BROWNINGTON BP 0310-7110  
 RECORD PLANS PAVEMENT AREA  
 MATERIALS 709 S.Y.

SUBBASE OF GRAVEL — CALKINS PIT — COVENTRY, VT.  
 BITUMINOUS CONCRETE — L.M. PIKE & SON, INC. — WILLISTON, VT.  
 CONCRETE CLASS B — CALKINS READY MIX — COVENTRY, VT.  
 STEEL PILING & REINFORCING STEEL — PIONEER VALLEY STEEL CO.  
 (BETHLEHEM STEEL) — GREENFIELD, MA.  
 WATER REPELLENT — KIBBY EQUIPMENT CO. — WHITE RIVER JCT, VT.  
 GRANITE BRIDGE CURB — CETRANGOLO FINISHING WORKS, INC. —  
 NORTHFIELD, VT.  
 BRIDGE RAILING — D.W. HUBBELL & SONS, INC. — NEW HARTFORD, N.Y.  
 GUARD RAIL — GRISWOLD FENCE CO. — WILLISTON, VT.

CONTRACTOR  
 BRIDGES INC.  
 MONTPELIER, VT.  
 RES. ENG. — MARK G. HUTCHINS.  
 RECORD PLANS — A.G. SPIDLE.

CONTRACT  
 DATED — JUNE 22, 1972.  
 STARTED — JULY 17, 1972.  
 COMPLETED — DECEMBER 7, 1972.  
 ACCEPTED — DECEMBER 7, 1972.

NOTE: ANY FURTHER INFORMATION CONCERNING  
 FINAL QUANTITIES, ADJUSTS OR OTHER DETAILS  
 RELATIVE TO THIS PROJECT MAY BE FOUND IN  
 EITHER THE FIELD BOOKS OR THE ESTIMATE  
 FILE.

CONVENTIONAL SIGNS

BROWNINGTON BP 0310-7110  
 CONTRACTOR — BRIDGES, INC. — MONTPELIER, VT.  
 RECORD PLANS — A.G. SPIDLE.  
 CONST. COMPLETED — DECEMBER 7, 1972.

STATE OF VERMONT  
 DEPARTMENT OF HIGHWAYS

PROPOSED IMPROVEMENT

BRIDGE PROJECT

TOWN OF BROWNINGTON

ORLEANS COUNTY

VT ROUTE 58, BRIDGE #13 OVER WILLOUGHBY RIVER

BEGINNING ON VT 58 APPROXIMATELY 2.5 MILES WEST OF THE  
 INTERSECTION OF VT 58 AND VT 5A AND EXTENDING  
 350 FEET NORTHWEST ALONG VT. 58

THE PROJECT SHALL CONSIST OF REMOVAL OF EXISTING  
 SUPERSTRUCTURE AND ABUTMENTS, REPAIR OF  
 EXISTING PIERS, CONSTRUCTION OF NEW SUPERSTRUCTURE  
 AND ABUTMENTS, AND NECESSARY APPROACH WORK.

LENGTH OF BRIDGE = 84 FEET = 0.016 MILES.  
 LENGTH OF ROADWAY = 266 FEET = 0.050 MILES.  
 LENGTH OF PROJECT = 350 FEET = 0.066 MILES.

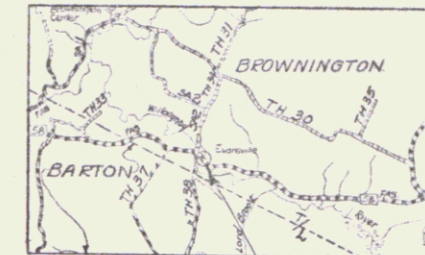

PROJECT-BR0310-7110

Br # 13  
 MP 0.82

RIGHT-OF-WAY DIVISION  
 TOWN FILE

PERPETUAL

Rte  
 Town of VT 58  
 (To Be Returned To R.O.W. Division)

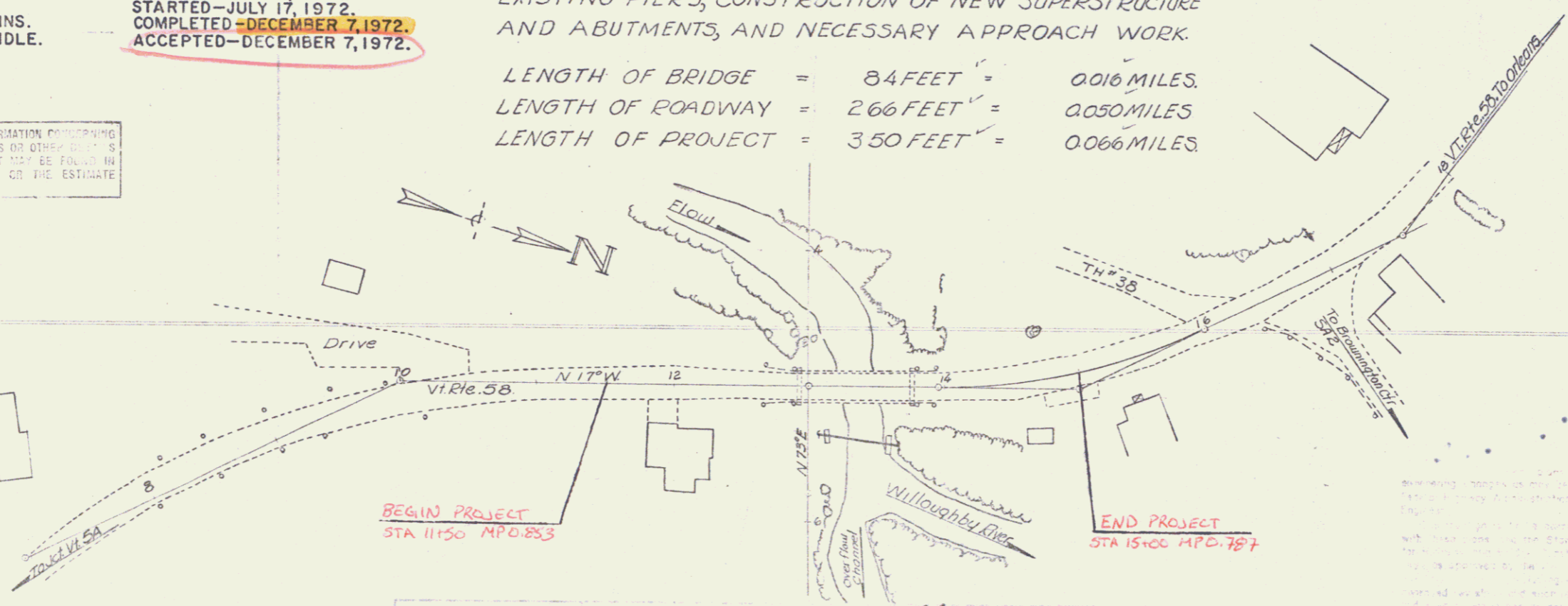

RECOMMENDED FOR APPROVAL  
 DISTRICT ENGINEER 5-2-72

RECOMMENDED FOR APPROVAL  
 CONSTRUCTION ENGINEER 5/17/72

RECOMMENDED FOR APPROVAL  
 E.H. Stebbins 5/4/72

RECOMMENDED FOR APPROVAL  
 BRIDGE 5/4/72

R.H. Arnold 5/4/72

Pin # 00R 335

Project BP 0310-7110

SHEET 1



**SEED ITEM 651.10**  
To be applied as directed by the Engineer

% Wgt.	Lbs./A	Name	Purity %	Germin.
41.67	25	Creeping Red Fescue	98	85
25.00	15	Alfalfa	99	85
8.33	5	Red Top	92	85
16.67	10	Perennial Ryegrass	95	90
8.33	5	Birdsfoot Trefoil (Empire)	98	80
100.00	60			

The seed mixture shall not have a weed content exceeding 0.40% by weight and shall be free from all noxious weed seed.

**FERTILIZER ITEM 651.15**  
Formula 10-20-10 is to be used with Seed, Item 651.10, applied at a rate of 500 lbs./acre.

**HAY MULCH ITEM 651.25**  
To be placed on earth slopes at the rate of 2 Tons/Acre

**CONSTRUCT DRIVE**  
11.90° Rt

**GUARD RAIL BOX BEAM WITH STEEL POSTS ITEM 621.45**  
12.45° Rt - 12.86° Rt.  
12.48° Lt. - 12.85° Lt.  
13.81° Lt. - 14.18° Lt.  
13.82° Rt. - 14.19° Rt.

**EXISTING STRUCTURE**  
TYPE: CONC. TEE BEAM  
LENGTH: 3 SPANS @ 28'-04" OVERALL  
RDWY. WIDTH: 20'  
CLEAR HT: 20' MAX.  
YEAR BUILT: 1929

**Curve Data**  
A 26°20' LI  
D 13"  
R 440.74  
T 103.11  
L 208.56  
E 11.90°

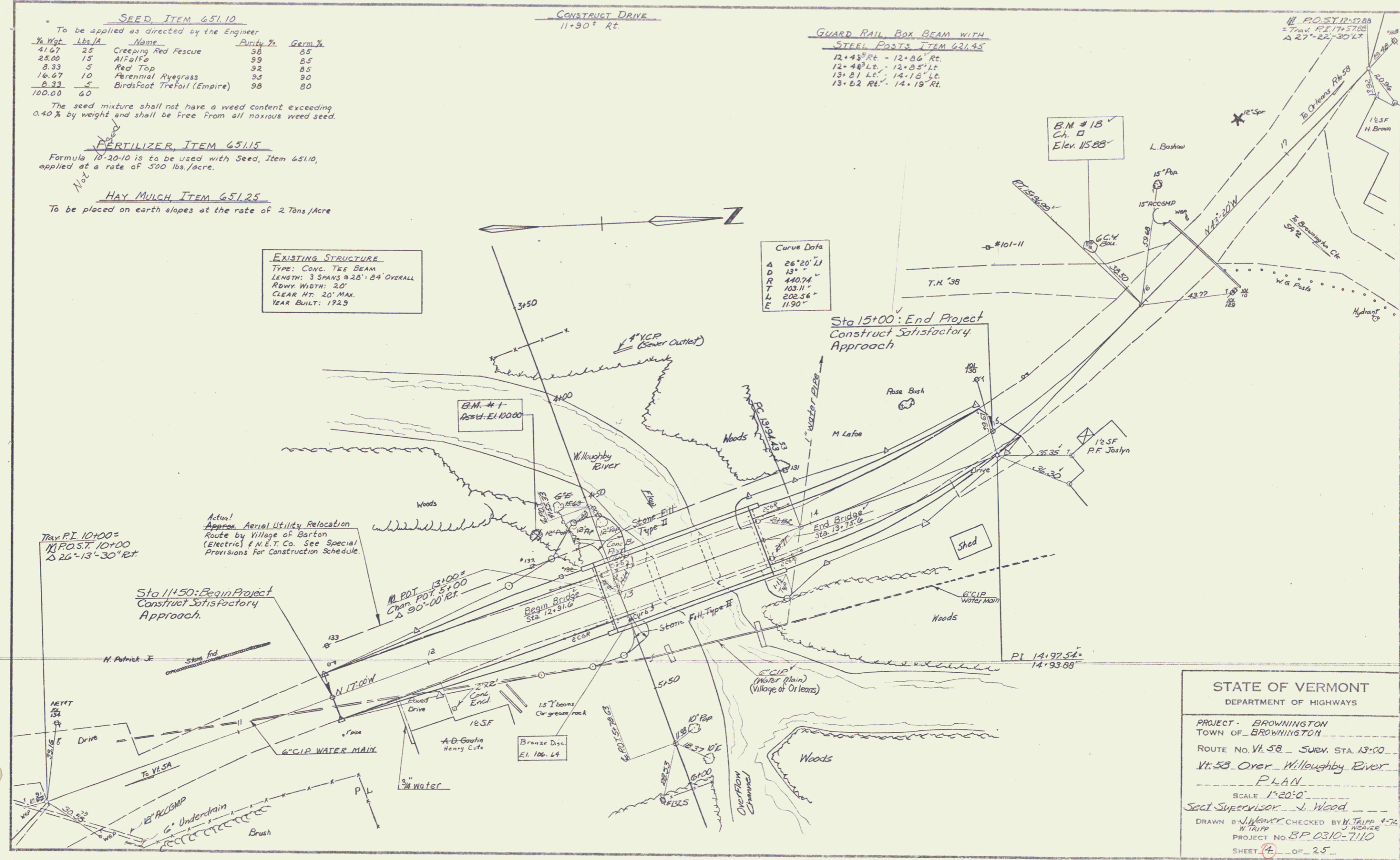

**STATE OF VERMONT**  
DEPARTMENT OF HIGHWAYS

PROJECT - BROWNINGTON  
TOWN OF BROWNINGTON

ROUTE No. Vt. 58 - SURV. STA. 13+00  
Vt. 58 Over Willoughby River

**PLAN**

SCALE 1"=20'-0"

SECT. SUPERVISOR - J. Wood

DRAWN BY J. WENNER CHECKED BY W. TRIPP 4-76  
H. TRIPP J. WENNER

PROJECT NO. B.P. 0310-7110

SHEET 4 OF 25

INDEX OF SHEETS

SHEET NO.	1	TITLE PAGE
"	"	2 TYPICAL CROSS-SECTION OF IMPROVEMENT 24' GRAVEL
"	"	3 PLAN AND PROFILE STA.
"	"	4 SERIES STB NO. 25' SPAN
"	"	5 ABUTMENT DETAILS
"	"	6 SERIES S.P. NO. 1-H27
"	"	7 " S.B. NO. 2 TYPICAL DETAILS
"	"	8 " S.B. NO. 2A
"	"	9 " S.B. NO. 5 CABLE RAIL
"	"	10-11 CROSS SECTIONS
"	"	12 SERIES S.NO. 22 STANDARD STRUCTURES

FED. ROAD DIST. NO.	STATE	FED. AID PROJ. NO.	FISCAL YEAR	SHEET NO.	TOTAL SHEETS
9	VT.			1	12

STATE OF VERMONT  
STATE HIGHWAY DEPARTMENT

PLAN AND PROFILE OF PROPOSED  
STATE HIGHWAY

TOWN OF BROWNINGTON

EVANSVILLE BRIDGE  
LOCATED IN VILLAGE OF EVANSVILLE  
ON THE ROAD TO LAKE WILLOUGHBY  
LENGTH 225 FEET-04 2 MILES

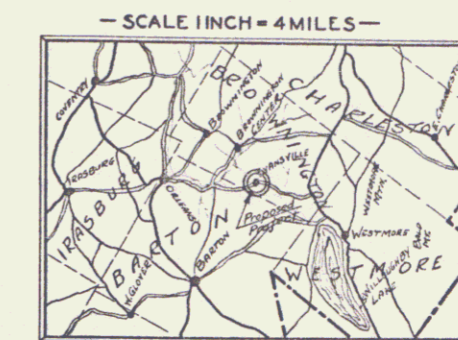

FOR LAYOUT SEE SHEET NO. 3

SCALES  
PLAN.....20 FEET-1 INCH  
VERTICAL...20 FEET-1 INCH  
HORIZONTAL 20 FEET-1 INCH  
SECTIONS...20 FEET-1 INCH

THIS PROJECT TO BE CONSTRUCTED IN ACCORDANCE WITH STANDARD SPECIFICATIONS ON FILE WITH THE U.S. BUREAU OF PUBLIC ROADS. APPROVED 7/7/26.

THESE PLANS ARE SUBJECT TO SUCH REVISIONS AS MAY BE REQUIRED BY THE BUREAU OF PUBLIC ROADS OR THE CHIEF ENGINEER.

*Br # 13*

*MP 0.82*

RIGHT-OF-WAY DIVISION  
TOWN FILE

PERPETUAL

*Rte*  
Town of *Ut 58*

(To Be Returned To R.O.W. Division)

APPROVED: April 12, 1929

*H.E. Saigent*  
CHIEF ENGINEER

SUBMITTED BY ORDER OF THE STATE HIGHWAY BOARD

COMMISSIONER OF HIGHWAYS

CONVENTIONAL SIGNS

- COUNTY LINE.....
- TOWN LINE.....
- FENCE LINE.....
- STONE WALL.....
- UNFENCED PROPERTY.....
- GUARD RAIL.....
- TRAVELED WAY.....
- RAILROAD.....
- RETAINING WALL.....
- CENTER LINE.....
- SURVEY LINE.....
- CULVERT.....
- DROP INLET.....
- TROLLEY POLE.....
- POWER POLE.....
- TELEPHONE POLE.....
- TREES.....
- HEDGE.....

- GROUND ELEVATION..... DATUM..... LINE.....
- GRADE ELEVATION..... DATUM..... LINE.....

- CURVE DATA
- DEFLECTION ANGLE..... Δ
  - DEGREE OF CURVE..... D
  - RADIUS OF CURVE..... R
  - TANGENT DISTANCE..... T
  - LENGTH OF CURVE..... L
  - EXTERNAL DISTANCE..... E
  - POINT OF INTERSECTION..... P. I.
  - POINT OF CURVE..... P. C.
  - POINT OF TANGENT..... P. T.
  - POINT ON TANGENT..... P. O. T.

BRIDGE NO. 9-297  
DISTRICT NO. 12  
BROWNINGTON

*Ut 58, Rt 13 over Willoughby River*

RECOMMENDED  
DISTRICT ENGINEER BUREAU OF PUBLIC ROADS

RECOMMENDED FOR APPROVAL  
CHIEF ENGINEER BUREAU OF PUBLIC ROADS

APPROVED  
DIRECTOR - BUREAU OF PUBLIC ROADS

SERIES F. No. FILED  
SHEET 1 OF 12

