

SEED ITEM 651.10
To be applied as directed by the Engineer

% Wgt.	Lbs./A	Name	Purity %	Germin.
41.67	25	Creeping Red Fescue	98	85
25.00	15	Alfalfa	99	85
8.33	5	Red Top	92	85
16.67	10	Perennial Ryegrass	95	90
8.33	5	Birdsfoot Trefoil (Empire)	98	80
100.00	60			

The seed mixture shall not have a weed content exceeding 0.40% by weight and shall be free from all noxious weed seed.

FERTILIZER ITEM 651.15
Formula 10-20-10 is to be used with Seed, Item 651.10, applied at a rate of 500 lbs./acre.

HAY MULCH ITEM 651.25
To be placed on earth slopes at the rate of 2 Tons/Acre

CONSTRUCT DRIVE
11.90° Rt

GUARD RAIL BOX BEAM WITH STEEL POSTS ITEM 621.45
12.45° Rt - 12.86° Rt.
12.48° Lt. - 12.85° Lt.
13.81° Lt. - 14.18° Lt.
13.82° Rt. - 14.19° Rt.

EXISTING STRUCTURE
TYPE: CONC. TEE BEAM
LENGTH: 3 SPANS @ 28'-04" OVERALL
RDWY. WIDTH: 20'
CLEAR HT: 20' MAX.
YEAR BUILT: 1929

Curve Data
A 26°20' LI
D 13"
R 440.74'
T 103.11'
L 208.56'
E 11.90°

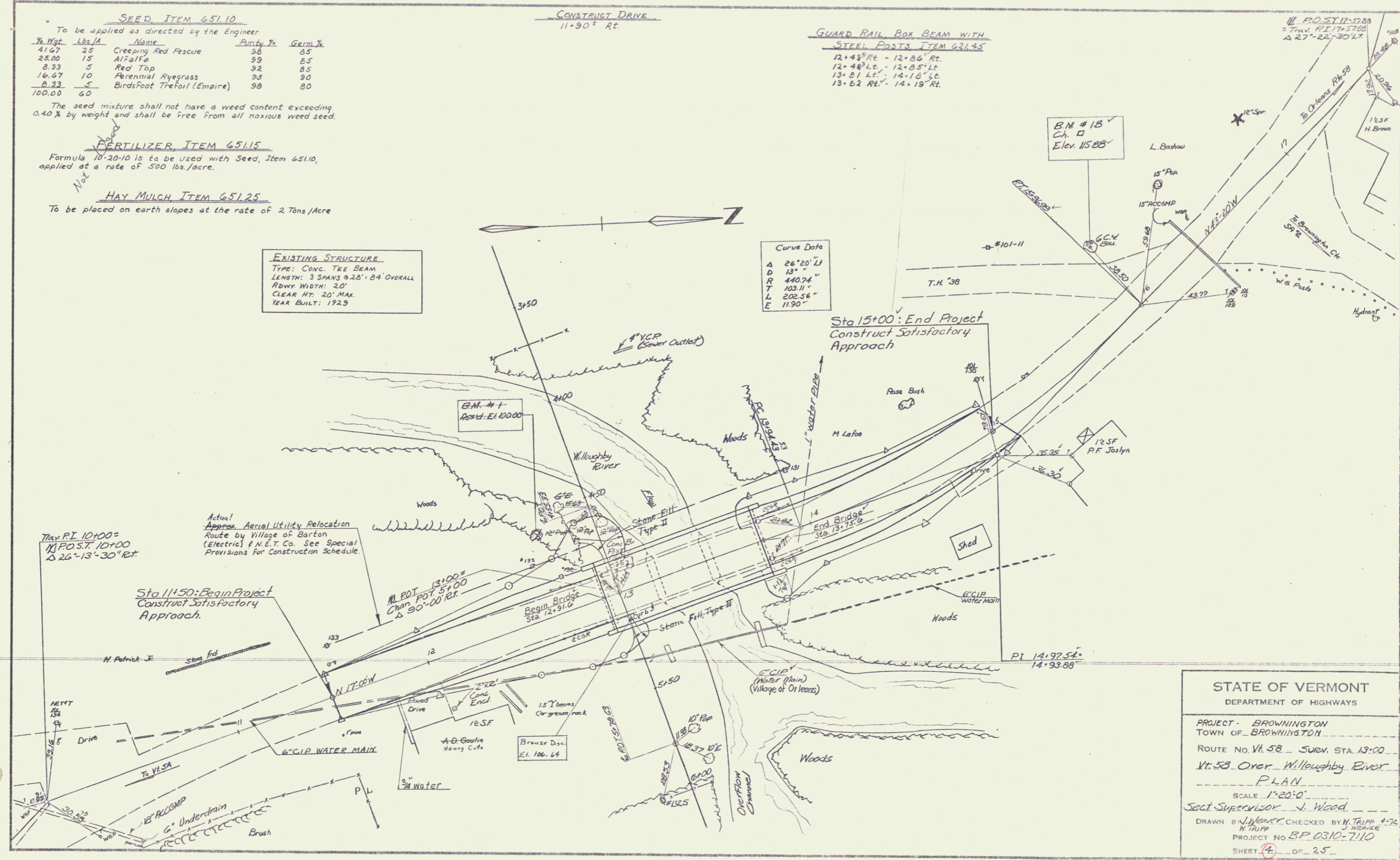

STATE OF VERMONT
DEPARTMENT OF HIGHWAYS
PROJECT - BROWNINGTON
TOWN OF BROWNINGTON
ROUTE No. Vt. 58 - SURV. STA. 13+00
Vt. 58 Over Willsoughby River
PLAN
SCALE 1"=20'-0"
SECT. SUPERVISOR - J. Wood
DRAWN BY J. WENNER CHECKED BY W. TRIPP 4-76
H. TRIPP J. WENNER
PROJECT NO. B.P. 0310-7110
SHEET 4 OF 25