

Dec. 15, 1958.
 Land out 3 rd highway
 Book 2 pages 315-327

Present Bridge Data
 5' x 5' Field Stone
 Partial Concrete Raced Stone walls
 Railroad Rails

PROJ # BMA 6225
 TOWN # WEST WINDSOR
 PIN # L. 00R323
 Route # VT 44
 Date: 01/01/1969

PLAN
 SCALE
 1" = 40'

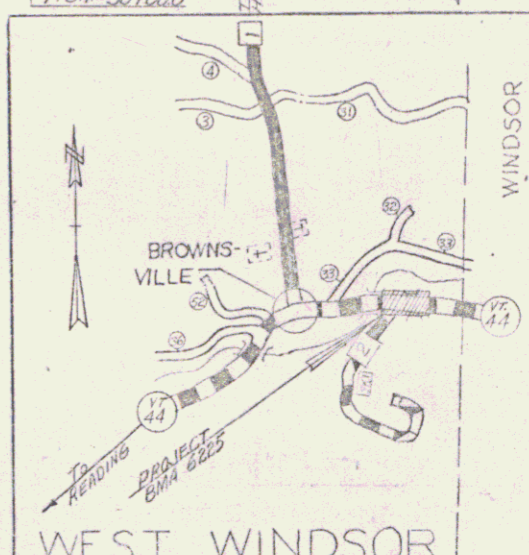
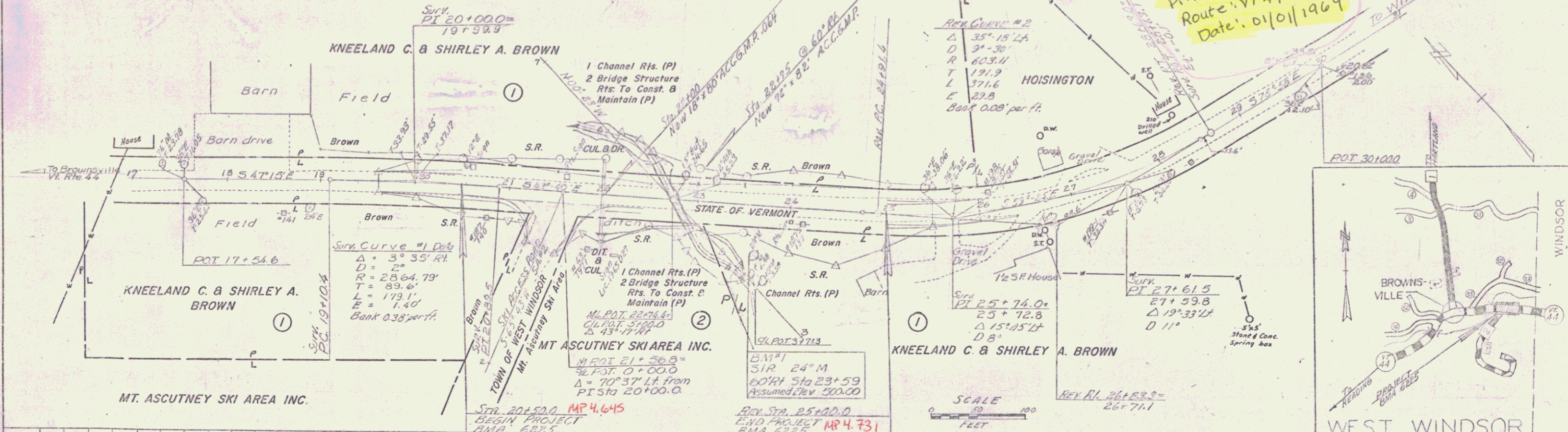

STATION	PARCEL #	DESCRIPTION	BEARING	DISTANCE	AREA
520	KNEELAND C. & SHIRLEY A. BROWN	20+20 RT - 21+21 RT	S.R. (P)	871'	4356'
		23+07 RT - 23+35 RT	S.R. (P)	28'	
		23+07 RT - 23+65 RT	CHANNEL RTS. (P)	871'	
510	KNEELAND C. & SHIRLEY A. BROWN	20+20 LT - 22+00 LT	S.R. (P)	1522'	2614'
		22+00 LT - 23+00 LT	CHAN. & DRAIN RTS. (P)	2614'	
		23+00 LT - 23+75 LT	S.R. (P)	2178'	
300	KNEELAND C. & SHIRLEY A. BROWN	22+45 LT - 23+70 LT	BRIDGE STRUCT. RTS. TO CONST. & MAINTAIN (P)		45.0 A
		22+45 LT - 23+70 LT	CULVERT & DRAIN RTS. (P)		
430	TOTAL ACREAGE TAKING-ABOVE RTS. ONLY				45.0 A
480	PARCEL #1 WDOE RECORDED 10-16-72 WEST WINDSOR BK 19 PG 14-15				
470	MT. ASCUTNEY SKI AREA INC.	21+00 RT - 22+70 RT	S.R. (P)	1742'	1100 A
		22+70 RT - 23+35 RT	CHANNEL RTS. (P)	1622'	
	TOTAL ACREAGE TAKING-ABOVE RTS. ONLY				1100 A
	PARCEL #2 WDOE RECORDED 10-11-72 WEST WINDSOR BK 19 PG 16-17				

- INDEX SHEETS
1. PLAN & PROFILE
 2. TYPICAL SECTION
 3. DRAINAGE & DITCH CULVERTS
 4. EARTHWORK SHEET
 5. BRIDGE SECTIONS
 6. APPROACH SECTIONS
 7. CURB & GUTTER
 8. DRAINAGE STRUCTURES
 9. EARTHWORK SHEETS
 10. C.T. EMBANKING TENDERS
 11. DITCH & SWALES
 - 12-15. C&G's Standard Roadward Rail and Special Details
 16. B.A. Grade Posts & Worker Posts
 17. A.T. Boundary Markers

Recommended by	DATE
For Approval	DATE
Recommended by	DATE
For Approval	DATE
Recommended by	DATE
For Approval	DATE
Approved by	DATE

RIGHT-OF-WAY DIVISION
 TOWN FILE
 PERPETUAL
 No. of 44
 (To Be Returned To R.O.W. Division)

SCALE
 1" = 40'
 WEST WINDSOR
 BMA 6225
 Bridge #8 VT 44
 Sheet 1 of 15