

Dec. 15, 1958.  
 Land out 3 rd highway  
 Book 2 pages 315-327

Present Bridge Data  
 5' x 5' Field Stone  
 Partial Concrete Raced Stone walls  
 Railroad Rails

PROJ H: BMA 6225  
 TOWN: WEST WINDSOR  
 PIN # 1. 00R323  
 Route: VT 44  
 Date: 01/01/1969

PLAN  
 SCALE  
 1" = 40'

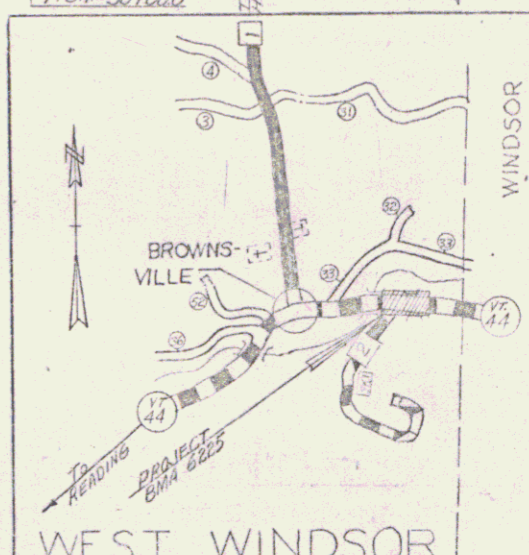
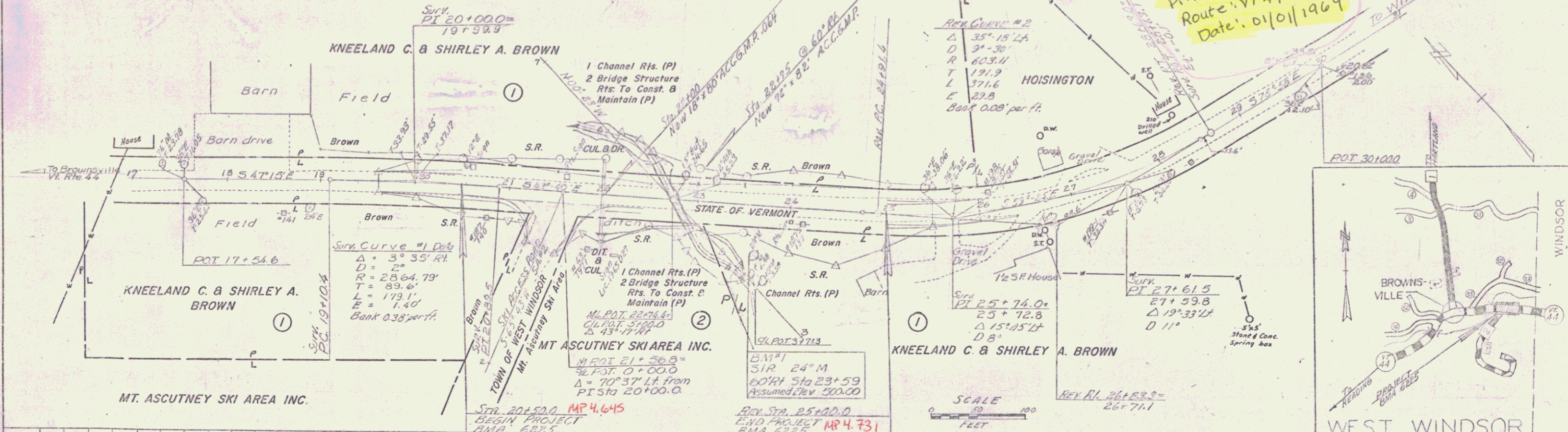

STATION	PARCEL #	DESCRIPTION	BEARING	DISTANCE	AREA
520	KNEELAND C. & SHIRLEY A. BROWN	20+20 RT - 21+21 RT	S.R. (P)	871'	4356'
		23+07 RT - 23+35 RT	S.R. (P)	28'	
		23+07 RT - 23+65 RT	CHANNEL RTS. (P)	871'	
510	KNEELAND C. & SHIRLEY A. BROWN	20+20 LT - 22+00 LT	S.R. (P)	1522'	2614'
		22+00 LT - 23+00 LT	CHAN. & DRAIN RTS. (P)	2614'	
		23+00 LT - 23+75 LT	S.R. (P)	2178'	
300	KNEELAND C. & SHIRLEY A. BROWN	22+45 LT - 23+70 LT	BRIDGE STRUCT. RTS. TO CONST. & MAINTAIN (P)		45.0 A±
		22+45 LT - 23+70 LT	CULVERT & DRAIN RTS. (P)		
430	TOTAL ACREAGE TAKING-ABOVE RTS. ONLY				45.0 A±
480	PARCEL #1 WDOE RECORDED 10-16-72 WEST WINDSOR BK 19 PG 14-15				
470	PARCEL #2 WDOE RECORDED 10-11-72 WEST WINDSOR BK 19 PG 16-17				
	TOTAL ACREAGE TAKING-ABOVE RTS. ONLY				1100 A±
	TAKING-ABOVE RTS. ONLY				0.08 A

- INDEX SHEETS
1. PLAN & PROFILE
  2. TYPICAL SECTION
  3. DRAINAGE & EROSION CONTROL
  4. EARTHWORK SHEET
  5. COST SHEETS
  6. APPROX. SECTIONS
  7. APPROX. SECTIONS
  8. CURVE DATA
  9. DRAINAGE DATA
  10. C.T. BEARING TABLES
  11. D.D. SCHEDULES
  - 12-15. C.R.G.C. Standard Roadward Rail and Signal Plans
  16. S.A. Grade Posts & Worker Posts
  17. S.T. Boundary Worksheets

Recommended by	DATE
For Approval	DATE
Recommended by	DATE
For Approval	DATE
Recommended by	DATE
For Approval	DATE
Approved by	DATE

RIGHT-OF-WAY DIVISION  
 TOWN FILE  
 PERPETUAL  
 No. of 44  
 (To Be Returned To R.O.W. Division)

WEST WINDSOR  
 BMA 6225  
 Bridge #8 VT 44  
 Sheet 1 of 15