

INDEX OF SHEETS

SHEET NO.	TITLE PAGE
1	TYPICAL CROSS-SECTION OF IMPROVEMENT—CRUSHED GRAVEL MIXED IN PLACE SURFACE COURSE
2	BANKING AND WIDENING TABLES WITH REFINED TAR ITEMS 25 & 30
3	PLAN AND PROFILE
4-10	BRIDGE DETAILS
11-13	BRIDGE BARRICADES, SIGNS, & LIGHTS
14	STANDARD BRIDGE DETAILS
15	STANDARD W/ BEAM BRIDGE
16	STA 67+85
17	STA 86+15
18	PIPE CULVERTS
19	GUARD RAIL
20	BOUNDARY MARKERS
21	BARRICADES, SIGNS, & LIGHTS
22	ROUNDING OF SLOPES
23	CROSS SECTIONS

STANDARD STRUCTURE SHEETS APPROVED BY THE CHIEF ENGINEER

S-28 APRIL 28, 1941
 S-30 MAY 12, 1941
 S-30A APRIL 19, 1941
 S-40 SEPT. 5, 1941

ADDITIONAL SHEETS @ BRIDGE
 STA. 88+23 to 88+56.8

- SHEET NO 9A PLAN & PROFILE
- 13A PLAN BRIDGE WIDENING
- 13B DETAILS ABUT #1
- 13C DETAILS ABUT #2
- 47A RE-CROSS SECTIONS
- 48A RE-CROSS SECTIONS
- 49A RE-CROSS SECTIONS
- 13D STANDARD DETAILS - S.B.*5 - Dated Feb. 1930

STATE OF VERMONT
 STATE HIGHWAY DEPARTMENT

PLAN AND PROFILE OF PROPOSED
 STATE HIGHWAY

SECONDARY PROJECT

TOWN OF TOPSHAM

VERMONT ROUTE 25

BARRE - BRADFORD ROAD

BEGINNING AT A POINT 0.619 MILE SOUTHERLY OF THE INTERSECTION OF U.S. ROUTE 302 AND VERMONT ROUTE 25 AND EXTENDING SOUTHERLY AND WESTERLY 1.434 MILES

7497.2 1.420
 LENGTH OF ROADWAY ~~7537.0~~ FEET = ~~1.428~~ MILES
 LETH. BRIDGE 58+64 to 59+08 44.0 FEET = 0.008 MILES
 LENGTH OF BRIDGE ~~44.0~~ FEET = ~~0.008~~ MILES
 LETH. BRIDGE 88+23.0 to 88+56.8 33.8 FEET = 0.006 MILES
 LENGTH OF PROJECT 7575.0 FEET = 1.434 MILES

FED. ROAD DIST. NO.	STATE	PROJ. NO.	FISCAL YEAR	SHEET NO.	TOTAL SHEETS
9	Vt	5 169(2)	1946	1	60



SCALE: 1 INCH = 1 MILE

Pin 00R314

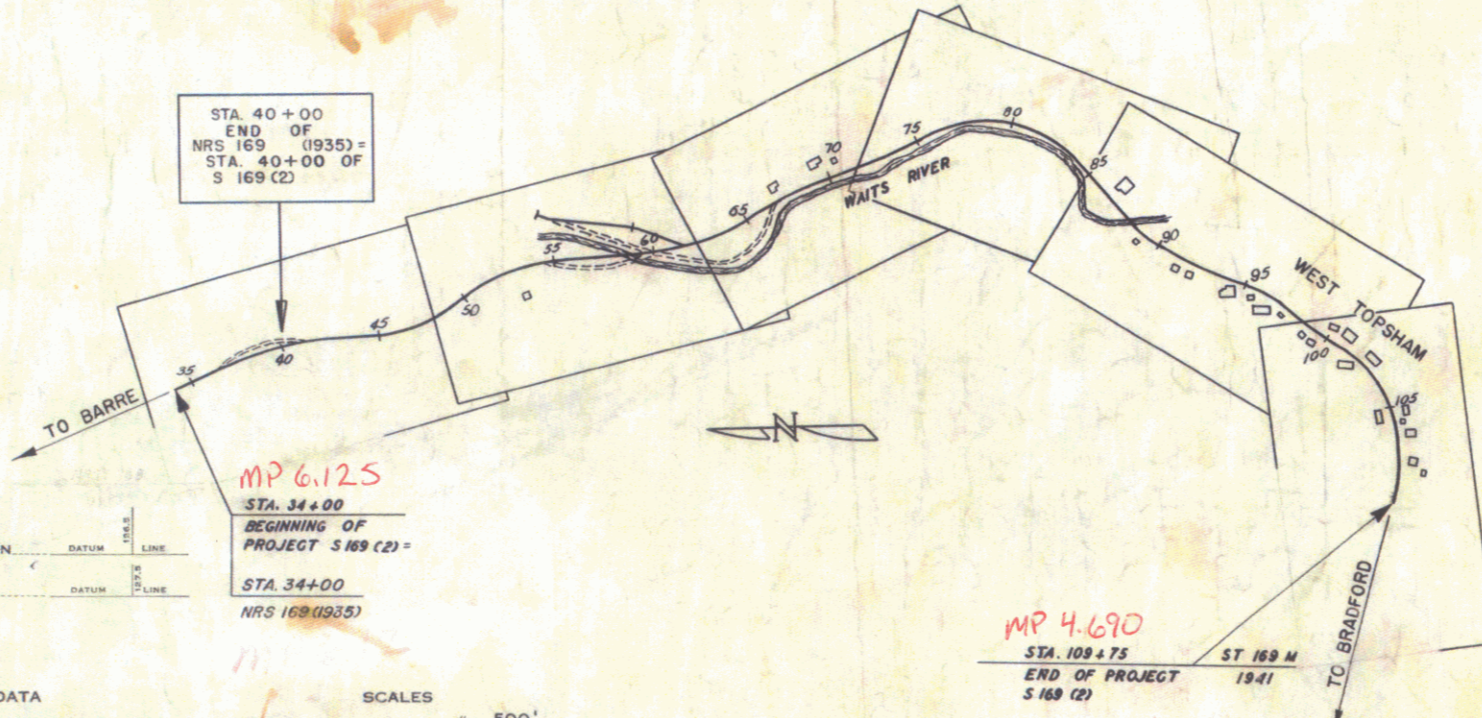

COUNTY LINE _____
 TOWN LINE _____
 FENCE LINE _____
 STONE WALL _____
 UNFENCED PROPERTY _____
 GUARD RAIL _____
 TRAVELED WAY _____
 RAILROAD _____
 RETAINING WALL _____
 CENTER LINE _____
 SURVEY LINE _____
 CULVERT _____
 DROP INLET _____
 TROLLEY POLE _____
 POWER POLE _____
 TELEPHONE POLE _____
 TREES _____
 HEDGE _____

PROJECT: Topsham (14.46 to 25)
 NUMBER: 5169(2)
 TYPE: 2 1/2 in Crushed Gravel, M.P.
 CONTRACTOR: _____
 LOCATION: Vermont Route 25, 0.619 mi. South of the intersection of U.S. Route 302, extending Southward and Westward 1.434 mi.

ROUND ELEVATION	DATUM	LINE
RADE ELEVATION	DATUM	LINE

CURVE DATA

REFLECTION ANGLE	Δ
DEGREE OF CURVE	D
RADIUS OF CURVE	R
TANGENT DISTANCE	T
LENGTH OF CURVE	L
EXTERNAL DISTANCE	E
POINT OF INTERSECTION	P. I.
POINT OF CURVE	P. C.
POINT OF TANGENT	P. T.
POINT ON TANGENT	P. O. T.

SCALES

TITLE	1" = 500'
TYPICAL	1" = 2'
PLAN	1" = 50'
PROFILE HORIZONTAL	1" = 50'
PROFILE VERTICAL	1" = 10'
CROSS SECTIONS	1" = 5'

THESE PLANS ARE SUBJECT TO SUCH REVISIONS AS MAY BE REQUIRED BY THE PUBLIC ROADS ADMINISTRATION OR THE COMMISSIONER OF HIGHWAYS.

CONSTRUCTION IS TO BE CARRIED ON IN ACCORDANCE WITH THE PLANS AND THE STANDARD ROAD AND BRIDGE SPECIFICATIONS OF 1936, AS APPROVED DECEMBER 21ST, 1936, BY THE PUBLIC ROADS ADMINISTRATION, INCLUDING ALL SUBSEQUENT APPROVED REVISIONS AND SUCH REVISED SPECIFICATIONS AND SPECIAL PROVISIONS AS ARE SUBMITTED WITH THE PLANS.

APPROVED: *Mar. 25 1946*
J. E. Sargent
 COMMISSIONER OF HIGHWAYS

SUBMITTED BY ORDER OF THE STATE HIGHWAY BOARD

RECOMMENDED FOR APPROVAL

APPROVED

APPROVED: *March 25, 1946*
J. E. Sargent
 HIGHWAY ENGINEER

APPROVED: *March 30, 1946*
W. D. Mansueti
 DISTRICT HIGHWAY COMMISSIONER

SERIES 5 NO. 169(2) FILED
 SHEET 1 OF 60