

INDEX OF SHEETS

SHEET NO. 1	TITLE PAGE
2	TYPICAL CROSS-SECTION OF IMPROVEMENT
3	BROWNING AND WASHINGTON TABLES
4-5	PLAN AND PROFILE SHEETS
6	STANDARD STRUCTURE SHEET 5-28 PIPE CULVERTS
7	5-30 GUIDED RAIL
8	BARRICADES, SIGNS AND LIGHTS 5B-11
9	S.L.B. NO. 10 CR. (15' CLEAR SPAN)
10	EQUIPMENT DETAILS
11	S.B. NO. 2 TYPICAL DETAILS - 3.204, 3.220, 3.221
12	S.B. NO. 2.0
13	S.B. NO. 2.1
14-19	CROSS SECTIONS

Standard sheet 5-28 submitted to the Chief Engineer on May 10, 1933.
Standard sheet 5-30 submitted to the Chief Engineer on Aug. 15, 1933.

FED. ROAD DIST. NO.	STATE	PROJECT NO.	FISCAL YEAR	SHEET NO.	TOTAL SHEETS
9	VT.	149-B	1933	1	19

STATE OF VERMONT
STATE HIGHWAY DEPARTMENT

PLAN AND PROFILE OF PROPOSED
STATE HIGHWAY

NATIONAL RECOVERY SECONDARY PROJECT

TOWN OF BRADFORD
BRADFORD - BARRE ROAD

FROM A POINT 45 FT. SOUTH FROM THE RESIDENCE OF H.L. PRESCOTT NORTHERLY 0.384 MILES TO A POINT 200 FT. SOUTH FROM STEEL BRIDGE OVER WAIT'S RIVER

LENGTH OF PROJECT 2026.1 FT. = 0.384 MILES
1023.7 0.383

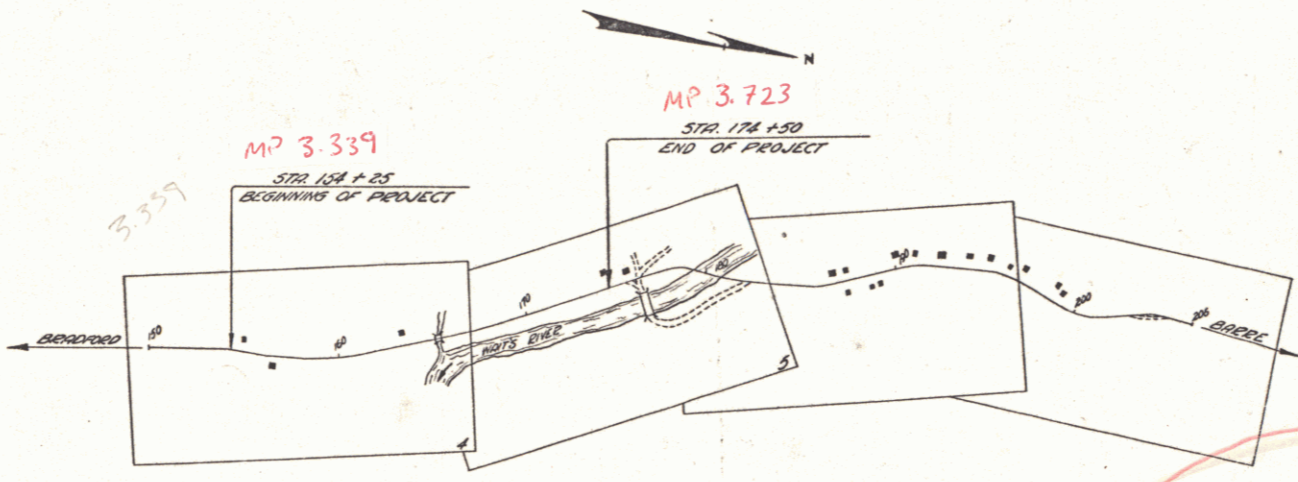
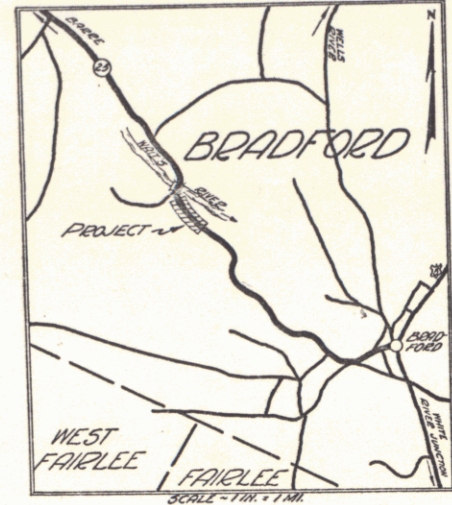

SCALES

TITLE	1" = 500'
PLAN	1" = 50'
PROFILE	1" = 20'
CROSS SECTIONS	1" = 5'

RECORD PLANS

RIGHT-OF-WAY DIVISION
TOWN FILE

PERPETUAL

Town of VT 25
(To Be Returned To Approved Dec. 13, 1933)

H.E. Prescott
Commissioner of Highways
SUBMITTED BY ORDER OF THE STATE HIGHWAY BOARD

PROJECT: Bradford
NUMBER: NRS 149-B
TYPE: C.L. Road
CONTRACTOR: S. & F. Rice Assoc.
LOCATION: See Site Card
YEAR: 1933

CONVENTIONAL SIGNS

GROUND ELEVATION	DATUM	LINE
GRADE ELEVATION	DATUM	LINE
CURVE DATA		
DEFLECTION ANGLE	Δ	
DEGREE OF CURVE	D	
RADIUS OF CURVE	R	
TANGENT DISTANCE	T	
LENGTH OF CURVE	L	
EXTERNAL DISTANCE	E	
POINT OF INTERSECTION	P. I.	
POINT OF CURVE	P. C.	
POINT OF TANGENT	P. T.	
POINT ON TANGENT	P. O. T.	

Date 12/13/1933
Proj # NRS 149-B
Plan # 00R 303
Note:
These plans are subject to such revisions as may be required by the Bureau of Public Roads or the Commissioner of Highways. Construction is to be carried on in accordance with the Standard Road and Bridge Specifications of 1930 with all subsequent approved revisions and such specifications and special provisions as are submitted with the plans.

NOTE: ANY FURTHER INFORMATION CONCERNING FINAL QUANTITIES, AMOUNTS OR KINDS OF MATERIALS RELATIVE TO THIS PROJECT MAY BE FOUND IN EITHER THE FIELD BOOKS OR THE ESTIMATE FILE.

RECOMMENDED _____
DISTRICT ENGINEER BUREAU OF PUBLIC ROADS

RECOMMENDED FOR APPROVAL _____
CHIEF ENGINEER BUREAU OF PUBLIC ROADS

APPROVED _____
DIRECTOR - BUREAU OF PUBLIC ROADS