

Construct Drives
 95+00 - 95+40 Lt.
 96+00 - 96+75 Rt.
 96+80 - 97+20 Rt.
 99+00 - 100+00 Lt. 77+15
 101+25 Rt.
 94+80 Lt.

Vertical Granite Curb, Item 556-B
 96+00 - 96+00 Rt. 97+00
 94+80 - 95+00 Lt.
 95+00 - 95+00 Lt.
 95+00 - 96+00 Lt. 37
 96+00 - 97+00 Lt.
 97+00 - 101+00 Lt.
 99+67 - 100+15 Rt.

Granite Slope Edging, Item 556-A
 (For Island Area)
 96+35 - 97+15 R.
 99+67 - 100+15 R.

Bit. Conc. Surf. for Gutters
 and Traffic Islands, Item 554 Mod
 100+15 - 100+40 Lt.
 96+35 - 97+15 R.
 99+67 - 100+15 Lt.
 101+00 - 101+30 Lt. Gutter

Stone Fill for Slope
 Protection (Light Type)
 101+25 - 101+60 Rt.
 101+30 - 101+80 Lt.

Overhead Traffic Sign Support, Item 708

Approximate location of new 8" water line to be installed by employees or agents of the Bradford Water Commission at or before the time of construction. To be inspected and approved by the engineer. See Special Provisions.

Telephone manholes and underground conduit to be installed by others at or before the time of construction. To be inspected and approved by the engineer. See Special Provisions.
 Approximate manhole locations: 916+00 - 93 Lt. & 924+90 - 29 Lt.

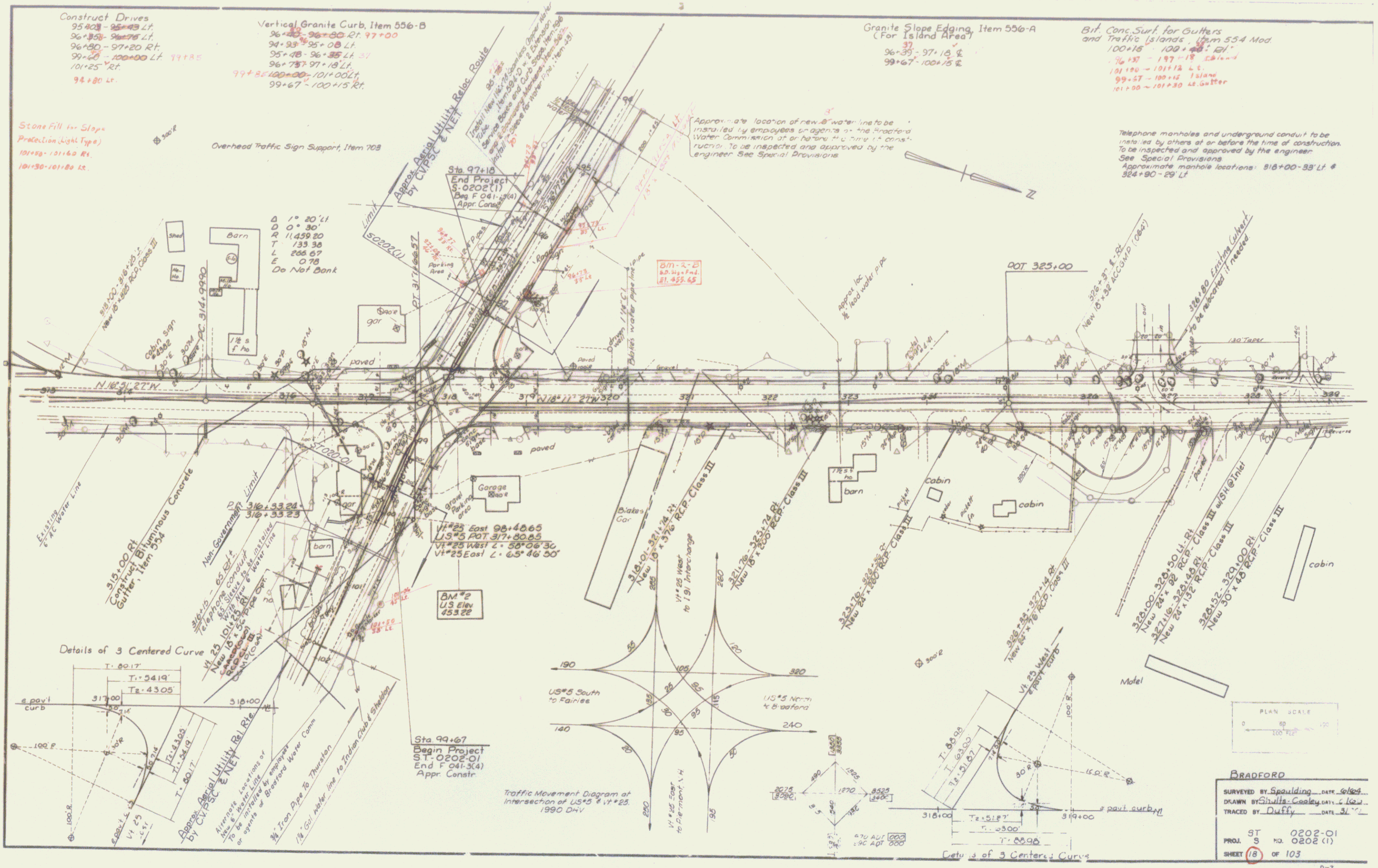

Details of 3 Centered Curve

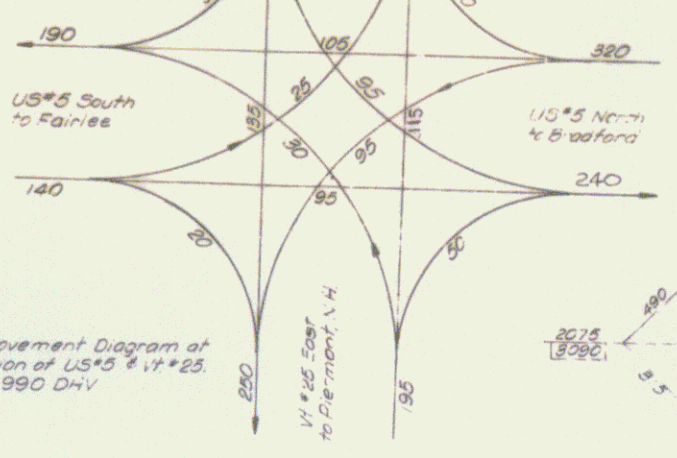
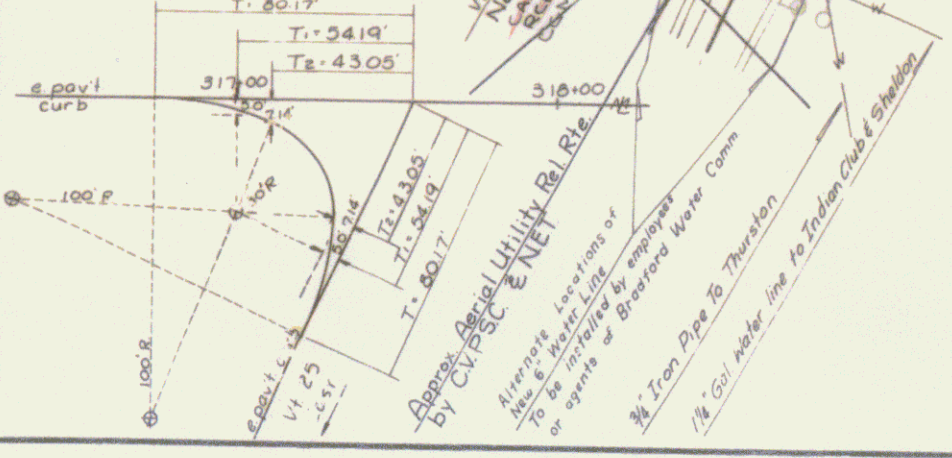

Sta 99+67
 Begin Project
 ST. 0202-01
 End F 041-3(4)
 Appr. Constr.

Traffic Movement Diagram at Intersection of US 5 & VT 25, 1990 Div

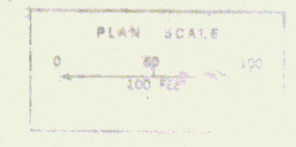

BRADFORD
 SURVEYED BY Spaulding DATE 6/16/64
 DRAWN BY Shultz-Cooley DATE 6/16/64
 TRACED BY Duffy DATE 3/1/71
 ST 0202-01
 PROJ. 5 NO. 0202(1)
 SHEET 18 OF 103