

INDEX OF SHEETS

- Title Page
- Typical Sheet of Improvements, Bituminous Conc. Pavement, Item 301-Misc.
- Summary of Items
- Drawings - Item Detail Summary
- Surveys and Grades
- Plan and Profile
- Water Main Relocation Detail Sheets
- Cattle Pass Details, Sta. 50+50
- Blank
- Traffic Sign Locations
- Traffic Signs and Detail Section Summary Sheet
- Traffic Signs, Trailing Type Ground Mounted Steel Support
- Overlays, Paved Sign Assembly and Construction Details
- And: Typical Sections on Solid Rock
- 8-1 Banking Tables
- 8-2 Typical Slope Grading
- 8-10 Drainage on a Slope
- 8-11 Slope Stabilization
- 9-1 Cuts
- 9-2 Cuts
- 9-3 Embankment, C.S.M., Underdrain
- 9-4 Butters, Jute Matting
- 9-5 Flushing Basins
- 9-6 Joint Conc. Drop Inlets for Ditches
- 9-8 Drop Inlets
- 9-10 Drop Inlet Ties
- 9-11 Grates
- 9-12 Pre-Cast Conc. Curb D.I. and Grates
- 9-13
- 9-14
- 9-15
- 9-16
- 9-17
- 9-18
- 9-19
- 9-20
- 9-21
- 9-22
- 9-23
- 9-24
- 9-25
- 9-26
- 9-27
- 9-28
- 9-29
- 9-30
- 9-31
- 9-32
- 9-33
- 9-34
- 9-35
- 9-36
- 9-37
- 9-38
- 9-39
- 9-40
- 9-41
- 9-42
- 9-43
- 9-44
- 9-45
- 9-46
- 9-47
- 9-48
- 9-49
- 9-50
- 9-51
- 9-52
- 9-53
- 9-54
- 9-55
- 9-56
- 9-57
- 9-58
- 9-59
- 9-60
- 9-61
- 9-62
- 9-63
- 9-64
- 9-65
- 9-66
- 9-67
- 9-68
- 9-69
- 9-70
- 9-71
- 9-72
- 9-73
- 9-74
- 9-75
- 9-76
- 9-77
- 9-78
- 9-79
- 9-80
- 9-81
- 9-82
- 9-83
- 9-84
- 9-85
- 9-86
- 9-87
- 9-88
- 9-89
- 9-90
- 9-91
- 9-92
- 9-93
- 9-94
- 9-95
- 9-96
- 9-97
- 9-98
- 9-99
- 1000

**RECORD PLANS
PAVEMENT AREAS
(1)-11,448 S.Y. & -01-1,421 S.Y.**

MATERIALS
SUBBASE OF GRAVEL-HEATH PIT & PARKER-
WYNN PIT-PIERMONT, N.H.
GOODELL PIT-POMPANOOSUC, VT.
PLANT MIXED BASE COURSE & BITUMINOUS
CONCRETE-LAMPKE PLANT-WLEBANON, N.H.
ASPHALT-HUMBLE OIL CO-EVERETT, MA.
WHITE GRITS-DEMERS QUARRY-SHELburne, VT.
CONCRETE CLASS B-MILLER CONCRETE PLANT-
BRADFORD, VT.
REINFORCING STEEL-VERMONT STRUCTURAL
STEEL CORP.-BURLINGTON, VT.
METAL CULVERT PIPE-NEW ENGLAND METAL
CULVERT CO.-WHITE RIVER JCT, VT.
REINFORCED CONCRETE PIPE-HUME PIPE CORP.-
WINDSOR, VT.
CONCRETE CATCH BASIN OR MANHOLE & CAST
IRON GRATES-E.L. LEBARON FOUNDRY CO.-
BROCKTON, MA.
UNDERDRAIN-KAISER ALUMINUM & CHEM-
ICAL SALES, INC.-SCHENECTADY, N.Y.
SLEEVES FOR WATER PIPES-NEW HAMPSHIRE
SUPPLY-MANCHESTER, N.H.
CAST IRON PIPE & FITTINGS-GRIFFIN PIPE PRODUCTS
CO.-FLORENCE, N.H.
COPPER TUBING-HALSTEAD MANUFACTURING CO.-
PITTSBURG, PA.
EXTENSION SERVICE BOX & CURB STOP-CAPITOL PLUMB-
ING & SUPPLY CO.-CONCORD, N.H.
PRECAST REIN. CONC. D.I., TRAFFIC SIGNS, GUARD RAIL &
EROSION CONTROL ITEMS-S.T. GRISWOLD-WILLISTON, VT.
GRANITE EDGING & CURB-BARRETTO GRANITE CO-MILFORD, N.H.

**STATE OF VERMONT
DEPARTMENT OF HIGHWAYS**

PROPOSED IMPROVEMENT

FEDERAL AID SECONDARY PROJECT

**TOWN OF BRADFORD,
COUNTY OF ORANGE**

VERMONT ROUTE 25

BARRE, VT.-PIERMONT, N. H. ROAD

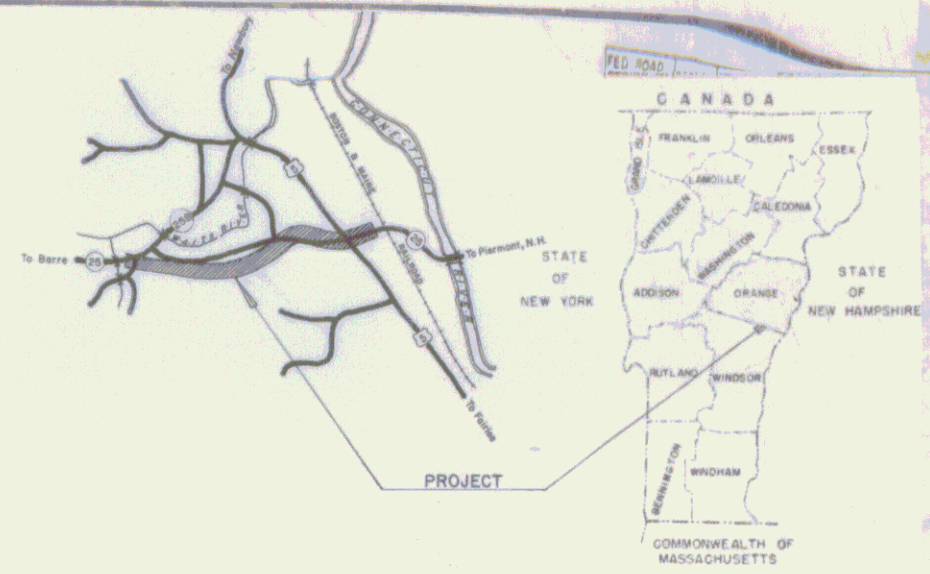

Beginning at a point approximately 1.278 miles westerly of the
U.S. Route 5-Vermont Route 25 intersection and extending easterly
1.254 miles, excepting 0.440 of a mile being constructed under a
separate contract.

LENGTH OF ROADWAY - 4295.85 feet = 0.814 mile
LENGTH OF PROJECT - 4295.85 feet = 0.814 mile

TRAFFIC DATA

	west	east
1970 ADT	1075	1075
1990 ADT	2340	3540
1990 DHV	380	575
D	51%	51%
T	6%	6%
V	50mph	50mph

**PROJECT ST 0202-01
NON-GOV'T PARTICIPATION**

Beginning at a point approximately 0.022 of a mile easterly of
the U.S. Route 5-Vermont Route 25 intersection and extending
easterly 0.101 of a mile.

LENGTH OF ROADWAY - 533.00 feet = 0.101 mile
LENGTH OF PROJECT - 533.00 feet = 0.101 mile

TRAFFIC DATA

1970 ADT	1370
1990 ADT	2785
1990 DHV	445
D	56%
T	8%
V	50mph

**CONTRACTOR-PALAZZI CORR.
HOOKSETT, N.H.
RESIDENT ENGINEER-LEON TESSIER
INSPECTORS-J. COUTURE, R. TOFANI, A. BOYD
& F. HALL, JR.
RECORD PLANS-N. MURRAY.**

**CONTRACT
DATED-MAY 13, 1971.
STARTED-MAY 14, 1971.
COMPLETED-OCTOBER 22, 1971.
ACCEPTED-OCTOBER 22, 1971.**

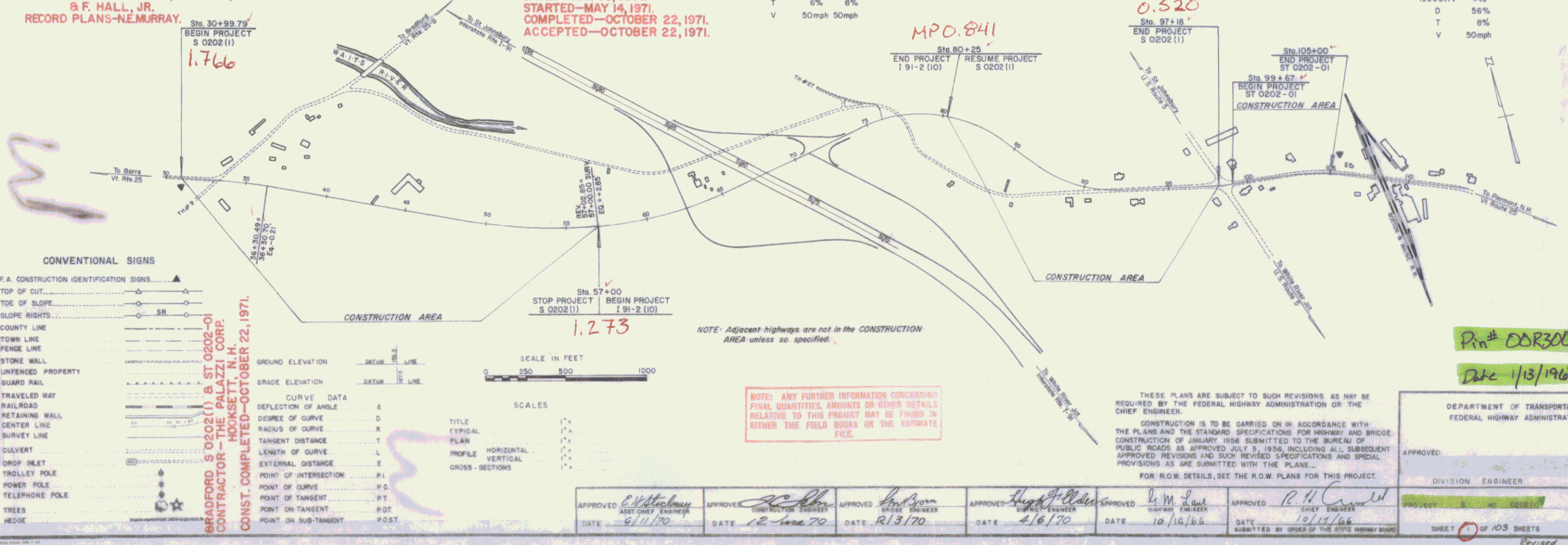

CONVENTIONAL SIGNS

F.A. CONSTRUCTION IDENTIFICATION SIGNS

- TOP OF CUT
- TOP OF SLOPE
- SLOPE RIGHTS
- COUNTY LINE
- TOWN LINE
- FENCE LINE
- STONE WALL
- UNFENCED PROPERTY
- GUARD RAIL
- RAILROAD
- RETAINING WALL
- CENTER LINE
- SURVEY LINE
- CULVERT
- DROP INLET
- TROLLEY POLE
- POWER POLE
- TELEPHONE POLE
- TREES
- HEDGE

SCALE IN FEET

0 250 500 1000

SCALES

TITLE	SCALE
TYPICAL	1" = 10'
PLAN	1" = 100'
PROFILE HORIZONTAL	1" = 100'
PROFILE VERTICAL	1" = 10'
GROSS SECTIONS	1" = 10'

NOTE: ANY FURTHER INFORMATION CONCERNING
FINAL QUANTITIES, AMOUNTS OR OTHER DETAILS
RELATIVE TO THIS PROJECT MAY BE FOUND IN
EITHER THE FIELD BOOKS OR THE ESTIMATE
FILE.

THESE PLANS ARE SUBJECT TO SUCH REVISIONS AS MAY BE
REQUIRED BY THE FEDERAL HIGHWAY ADMINISTRATION OR THE
CHIEF ENGINEER.

CONSTRUCTION IS TO BE CARRIED ON IN ACCORDANCE WITH
THE PLANS AND THE STANDARD SPECIFICATIONS FOR HIGHWAY AND BRIDGE
CONSTRUCTION AS APPROVED JULY 5, 1966, INCLUDING ALL SUBSEQUENT
APPROVED REVISIONS AND SUCH REVISED SPECIFICATIONS AND SPECIAL
PROVISIONS AS ARE SUBMITTED WITH THE PLANS.

FOR R.O.W. DETAILS, SEE THE R.O.W. PLANS FOR THIS PROJECT.

DEPARTMENT OF TRANSPORTATION
FEDERAL HIGHWAY ADMINISTRATION

APPROVED: _____
DIVISION ENGINEER DATE _____

PROJECT: ST 0202-01
SHEET: 1 OF 103 SHEETS

APPROVED	APPROVED	APPROVED	APPROVED	APPROVED	APPROVED
DATE	DATE	DATE	DATE	DATE	DATE
6/11/70	12-1-70	2/13/70	4/6/70	10/19/66	10/19/66

Pin # DOR300
Date 1/13/1967

STATE OF VERMONT
DEPARTMENT OF HIGHWAYS
RIGHT-OF-WAY PLANS
DETAIL SHEET
1 OF 3

TABLE OF PROJECT PROPERTY ACQUISITION

PARCEL NO.	GRANTOR	SHEET NO.	BEGINNING STATION	ENDING STATION	TAKING	RCM	RIGHTS	TITLE TAKEN	DATE	TOWN OR CITY	AC. FT.	REMARKS
1	Carl S. Welley	G	25+32+07	25+33+58	0.22A1	1.2A1		WD	5/29/68	Bradford	39.61	Area Computed
2	Leonid J. Couillard	G	25+31+76	25+32+23	0.03A1	1.3A1		WD	1/30/69	Bradford	39.327, 328	
3	Lawrence Catherine Benjamin	G	25+32+01	25+32+65	0.05A1	0.33A1		WD	1/8/69	Bradford	39.301	
4	Perley C. & Muriel H. Brainerd	G	25+32+57 25+33+33.01 25+33+42.01 25+33+60.01	25+38+22 25+33+94.01 25+34+25.01	1.0A1	3.3A1	Slope 4,875 Sq. Ft. (T) Slope 490 Sq. Ft. (T) Drive (T)	WD	5/19/68	Bradford	39.40	Area Computed
5	John N. & Olive E. Osgood	G	25+33+65 25+33+84.61 25+33+114.01 25+33+130.11	25+38+30 25+36+45.01 25+38+13.11	0.1A1	1.32A1	Water Pipeline (P) Slope 330 Sq. Ft. (T) Drive (T)	WD	6/8/68	Bradford	39.63	Area Computed All Right Title and Interest
6	Frances Fairbanks	G	25+38+29 25+38+50.11 12+60 E	25+38+75 25+35+85.01	0.04A1	2.1A1	Water Pipeline (P) Water Pipe Crossing	WD	5/11/68	Bradford	39.46	All Right Title and Interest
7A	Louise E. Hutchinson	G	25+36+05 25+36+35.01	25+37+43	0.46A2	0.22A1	Drive (T)	WD	12/13/68	Bradford	39.280	
7B			25+36+05	25+37+18	1.870 SF ±							Non-Participating Area Computed

TABLE OF REVISIONS

REVISION NO.	SHEET NO.	DESCRIPTION OF REVISION	DATE	MADE BY	APPROVED BY
1	G	Parcel No 6, Add pipe crossing and correct 1400. per Change Order No 775	7-18-67	def	JL
2	G	Additional Topo between Sta 44+00 - 46+00 ft. per Change Order No 799	8-3-67	def	JL
3	G	Parcel # 7 changed. Remainder from 0.52 Ac. to 0.52 Ac. per change Order # 873	10-25-67	M.A.R.	JL
4	G	Parcel # 10 added Slope Rights of 700' to Detail Sheet per Change Order # 1033	3-19-68	M.A.R.	JL
5	G	PARCEL # 7 NON-PARTICIPATING PARCEL CREATED PER CHANGE ORDER # 1089	4-18-68	DEB	JL
6	G	PARCEL # 7B CHANGED LOCATION OF PARCEL FROM SOUTH OF ROUTE 25 TO NORTH OF ROUTE 25 PER CHANGE ORDER # 1124.	5-8-68	DEB	JL
7	G	PARCEL # 7B DELETED PARCEL PER CHANGE ORDER # 1187	6-24-68	DEB	JL
8	10	Parcel # 11A Added drive at Sta 85+50.11. Per Change Order # 1204.	7-1-68	M.H.M.	JL
9	G	PARCEL # 7B CREATED THIS PARCEL AS A NON-PARTICIPATING PARCEL AND ADDED BUILDINGS TO LAYOUT SHEET # 6 PER CHANGE ORDER # 1261	10-16-68	WJM	JL
10	4, 6, 8, 9	PARCEL # 9 SHOW AREA TO BE QUIT - CLAIMED TO APPLETON. ADD PARCEL # 9A NEW AREA TO BE ACQUIRED FROM APPLETON. PER CHANGE ORDER # 1851	3-22-71	DEB	JL

MADE BY J.S. HANCOCK DATE 8-28-68
CHECKED BY A.R. GOSWAMI DATE 8-25-68

PRESENT R.O.W.
--- TAKING WITHOUT ACCESS
--- TAKING WITHOUT ACCESS ALONG PROPERTY LINES
--- TAKING WITH ACCESS
(P) PERMANENT EASEMENT
(T) TEMPORARY EASEMENT

LEGEND
--- SLOPE RIGHTS
--- PROPERTY LINE
--- TOP OF CUT
--- TOP OF SLOPE

APPROVED Thomas C. Rowland DATE 1-2-67
APPROVED J.M. Lane DATE 1-9-67
APPROVED H.P. Ransom DATE 1-10-67

PROJECT **BRADFORD**
NO **S0202 (I)**
SHEET **3** OF **11**
103

STATE OF VERMONT
DEPARTMENT OF HIGHWAYS
RIGHT-OF-WAY PLANS
DETAIL SHEET
2 OF 3

TABLE OF PROJECT PROPERTY ACQUISITION

TABLE OF REVISIONS

PARCEL NO.	GRANTOR	SHEET NO.	BEGINNING STATION	ENDING STATION	TAKING	REM.	RIGHTS	TITLE TAKEN	DATE	TOWN OR CITY RECORDED	BK.	PG.	REMARKS	REVISION NO.	SHEET NO.	DESCRIPTION OF REVISION	DATE	MADE BY	APPROVED BY	
8	Roger J. & Louise W. Courtemanche	6	25+37+18 25+39+20.1 25+37+45.81	25+38+81 25+38+35.1	0.2A1	1.8A1	Slope 30.5 sq. ft. (7)	WD	6/26/68	Bradford	39	101	Demolition and Disposal of Building - Shed							
9	Hennetta W. & Durol L. Appleton, William G. Appleton & Kenneth A. Appleton	6 5	25+37+43 25+37+57.94 25+38+31.42 25+38+43.04 25+38+80.04 25+38+80.04 25+38+85.04 25+38+85.04 25+38+85.04 25+38+85.04 25+38+85.04	25+37+00 25+38+30.04 25+40+92.11 25+39+30.04 25+38+32.04 25+38+85.04 25+38+80.04	7.8A1		Slope 200 sq. ft. (7) Slope 2,500 sq. ft. (7) Slope 270 sq. ft. (7) Slope 250 sq. ft. (7) Slope 2,500 sq. ft. (7) Water Pipeline (2) Spring (2) Drainage (2) Ditch and Drainage (2)	Cond.	1/23/68	Bradford	39	255- 257	Demolition and Disposal of Building 25+42+90.6 Chicken Coop All Right Title and Interest All Right Title and Interest							
10	Arthur L. & Frances R. Hyde	10	25+20+25 25+22+19.1 25+22+50.1	25+26+17 25+24+35.04	2.9A1		Water Pipeline (2) Drainage (2)	Cond.	1/23/68	Bradford	39	255- 257	Area Computed All Right Title and Interest All Right Title and Interest							
11A 11B	Lyle G. & Margaret E. Cheney	10	25+24+88 25+27+52 25+27+00.04 25+26+35.04 7+25.04 25+25+50.1	25+27+58 25+28+10 25+27+00.04	0.6A1 0.1A1	0.9A1	Slope 625 sq. ft. (7) Easement to Abandon Strip Driveway DRIVE	WD	1/9/69	Bradford	39	303	Area Computed Shed							
12	Joseph A. Mann	10	25+27+44 1+25.04	25+28+18	0.05A1		Drive	WD	8/23/68	Bradford	39	133								
13	Roger M. Emery	10	25+28+33 25+28+33.04 25+27+50.04	25+28+97 25+28+28.04	1.1A1		Slope 2,125 sq. ft. (7) Drive	Cond.	1/23/68	Bradford	39	255- 257	Area Computed							

MADE BY J.S. Weldon DATE 8-28-66
CHECKED BY A.R. Gregory DATE 8-25-66

PRESENT R.O.W.
---|---|--- TAKING WITHOUT ACCESS
---|---|--- TAKING WITHOUT ACCESS ALONG PROPERTY LINES
---|---|--- TAKING WITH ACCESS
(P) PERMANENT EASEMENT
(T) TEMPORARY EASEMENT

LEGEND
SR SR SLOPE RIGHTS
P P PROPERTY LINE
- - - - - FOR OF CUT
- - - - - TOE OF SLOPE

APPROVED Thomas C. Dunphy DATE 1-2-67
SUPERVISOR
APPROVED J.M. [Signature] DATE 1-2-67
PROJECT ENGINEER
APPROVED H.P. [Signature] DATE 1-10-67
DISTRICT ENGINEER

PROJECT BRADFORD
NO. S0202(1)
SHEET 9 OF 11

STATE OF VERMONT
DEPARTMENT OF HIGHWAYS
RIGHT-OF-WAY PLANS
DETAIL SHEET
OF

TABLE OF PROJECT PROPERTY ACQUISITION

PARCEL NO.	GRANTOR	SHEET NO.	BEGINNING STATION	ENDING STATION	TAKING	REM.	RIGHTS	FILE TAKEN	DATE	TOWN OR CITY RECORDED	BK.	PG.	REMARKS
9 A	KENNETH W. & PEARL L. APPLETON	6	RT. 25° 37' 43"	25° 57' 00"	0.7A±			WD	4/21/71	Bradford	41	25, 26	
	KENNETH A. APPLETON	8	25° 38' 80 LT	25° 41' 20 LT			SLOPE 1300 SF (P)						
	WILLIAM G. APPLETON		25° 37' 25 RT	25° 39' 50 RT			SLOPE 850 SF (P)						ADDITIONAL REQUIRED
			25° 52' 75 RT	25° 54' 60 RT			SLOPE 1980 SF (P)						ADDITIONAL REQUIRED
			25° 48' 10 LT				DRIVE (T)						
			25° 49' 00 RT				DRIVE (T)						
			25° 40' 50 RT	25° 44' 20 RT			DRIVE (T)						
			25° 43' 50 LT				DRAINAGE (P)						
			25° 50' 35 LT	25° 50' 70 LT			DITCH & DRAINAGE (P)						

TABLE OF REVISIONS

REVISION NO.	SHEET NO.	DESCRIPTION OF REVISION	DATE	MADE BY	APPROVED BY

MADE BY: gpa DATE 12-21-70
CHECKED BY: RGG DATE 12-21-70

--- PRESENT R.O.W.
--- TAKING WITHOUT ACCESS
--- TAKING WITHOUT ACCESS ALIGNED PARALLEL TO RT.
--- TAKING WITH ACCESS
--- PERMANENT EASEMENT
--- TEMPORARY EASEMENT

LEGEND
--- SR --- SLOPE RIGHTS
--- P --- PROPERTY LINE
--- TOP OF CUT
--- TOP OF SLOPE

APPROVED: [Signature] DATE 3-15-71
CHIEF PLANS & TITLE
APPROVED: G. M. Lane DATE 3-15-71
HIGHWAY ENGINEER
APPROVED: [Signature] DATE 3-15-71
DISTRICT ENGINEER

PROJECT **BRADFORD**
NO **S0202(1)**
SHEET 4A OF 11
9A

STATE OF VERMONT
DEPARTMENT OF HIGHWAYS
RIGHT-OF-WAY PLANS
DETAIL SHEET
3 OF 3

TABLE OF PROJECT PROPERTY ACQUISITION

PARCEL NO.	GRANTOR	SHEET NO.	BEGINNING STATION	ENDING STATION	TAKING	REM.	RIGHTS	TITLE TAKEN	DATE	TOWN OR CITY RECORDED	BK.	PG.	REMARKS
14	Ralph E. & Lavina C. Pierson	10	25+90.70 25+91.00PT	25+91.88 25+91.88PT	26M ²	18.0AT 15.0	Slope 190 Sq.Ft. (T)	Cond. 11/23/68		Bradford	39	255 247	REFER TO PROJECTS S0202(1) SHEETS 4, 5 AND P041-5(4) FOR REMAINDERS.
15	Wilfred & Elsie Couillard	10	25+90.190 25+91.251P	25+91.88	0.06A1	0.08A1	Drive (T)	Cond. 11/23/68		Bradford	39	255 247	
16	Lionel & Regine LaMontagne	10	25+83+85L1	25+85+00M			Water Pipeline (P)	Cond. 11/23/68		Bradford	39	255 247	All Right Title and Interest
17	William V. & Edith M. McGregor		12+75	37+18 36+70	0.02A1	.70A1	Water Line	WD 5/24/68		Bradford	39	57	All Right Title and Interest
18	Mary Bellou Tallier		34+70 258+11+45 R1	36+12 258+12+22 R1	0.26A	.12A2	Slope Rights (700 ^{sq})	WD 5/13/68		Bradford	39	48	

TABLE OF REVISIONS

REVISION NO.	SHEET NO.	DESCRIPTION OF REVISION	DATE	MADE BY	APPROVED BY

MADE BY: U.S. Walker DATE: 8-25-66
CHECKED BY: A.R. Green DATE: 8-25-66

PRESENT R.O.W.
--- TAKING WITHOUT ACCESS
--- TAKING WITHOUT ACCESS ALONG PROPERTY LINES
--- TAKING WITH ACCESS
(P) PERMANENT EASEMENT
(T) TEMPORARY EASEMENT

LEGEND
SR SR SLOPE RIGHTS
P L PROPERTY LINE
Δ Δ TOP OF CUT
--- TOE OF SLOPE

APPROVED: Thomas C. Brantly DATE: 1-2-67
CHIEF OF ACQUISITION
APPROVED: J.M. Conley DATE: 1-9-67
HIGHWAY ENGINEER
APPROVED: H.P. Emerson DATE: 1-10-67
R.T.W. DIRECTOR

PROJECT **BRADFORD**
NO. **S0202(1)**
SHEET 5 OF 11
10 103

STATE OF VERMONT
DEPARTMENT OF HIGHWAYS
RIGHT-OF-WAY PLANS
DETAIL SHEET
/ OF /

TABLE OF PROJECT PROPERTY ACQUISITION

PARCEL NO.	GRANTOR	SHEET NO.	BEGINNING STATION	ENDING STATION	TAKING	REM.	RIGHTS	TITLE TAKEN	DATE	TOWN OR CITY RECORDED	BK.	PG.	REMARKS
1	THURSTON, CHARLES H.	4, 5, 6	101+50 Lt 102+40 Lt 102+13 Lt 101+50 Lt	103+60 Lt 102+66 Lt 103+60 Lt	0.16A± 2.8A±	2.8A±	DRIVE (T) DRAINAGE (T) SLOPE (T) 0.12R±	Cond.	11-23-66	Bradford	39	253 254	
2	MARTIN, LEON B.	5	105+13 Lt 106+00 Lt 105+14 Lt 104+30	107+12 Lt 105+84 Lt 104+53±	0.14A± 1.7A±	1.7A±	DRIVE (T) SLOPE (680°) (T) DRAINAGE & DITCH (P)	WD	5-22-66	Bradford	39	49	
3	WELCH, PHOEBE M. & HOOKER, GRACE D.	5	106+96 Lt 107+10 Lt	108+02 Lt	2871° 0.8A±	0.8A±	DRIVE (T)	WD	4-30-66	Bradford	39	22 23	
4	BOSTON & MAINE R.R.	5	107+70 Rt	108+20 Rt	3390° N/A	N/A		Cond.	11-28-66	Bradford	39	253 254	
5	ROUSE, STUART A. & ABRAMS, BERNARD	5	104+04 Rt 106+50 Rt 107+90 Rt 104+19 Rt	107+88 Rt 106+15 Rt	0.28A± 3.4A±	3.4A±	DRIVE (T) DRIVE (T) SLOPE (0.19A±) (T)	Cond.	11-25-66	Bradford	39	253 254	
6	SHELDON, CHARLES H. & SHELDON, ELIZABETH H. (d.w.)	5 & 6	103+50 Lt 103+40 Lt	105+25 Lt 105+13 Lt	0.12A± 12.46A±	12.46A±	SLOPE (0.25A±) (T)	WD	5-10-66	Bradford	39	44	
7	TOWN OF BRADFORD	5 & 6	99+00	108+14	N/A	N/A	R.T. & I. IN SECTION OF Vt. Rte 25	Cond.	11-23-66	Bradford	39	253 254	
8	Deleted												
9	GIBBS, JOHN A.	5	102+00 RT 102+21 RT	104+04 CL 104+19 RT	7525°± 5.05A±	5.05A±	EXPLOSION (P)	Cond.	11-23-66	Bradford	39	253 254	Formerly: Blake Chevrolet Co. Inc.

TABLE OF REVISIONS

REVISION NO.	SHEET NO.	DESCRIPTION OF REVISION	DATE	MADE BY	APPROVED BY
1	5	Parcel #5, Changed Slope Rights to Avoid House Trailer. Per Change Order # 2945	11/1/67	JAB	JAB
2	5	PARCEL #2 RELOCATED BERM #1-1-68 OUTLET DITCH FROM STA 104+30-105+00 RT-LT TO 104+30-104+53 RT-LT PER CHANGE ORDER #1049		R.Z.S.	JAB

MADE BY: PL DATE 8-24-66
CHECKED BY: A.M.S. DATE 8/2/66

PRESENT R.O.W.
--- TAKING WITHOUT ACCESS
--- TAKING WITHOUT ACCESS ALONG PROPERTY LINES
--- TAKING WITH ACCESS
(P) PERMANENT EASEMENT
(T) TEMPORARY EASEMENT

LEGEND
SR --- SR SLOPE RIGHTS
P --- P PROPERTY LINE
△ --- △ TOP OF CUT
--- TOE OF SLOPE

APPROVED: Thomas C. Bennett DATE 10-26-66
CHIEF OF ACQUISITION
APPROVED: J. W. ... DATE 10/26/66
DISTRICT ENGINEER
APPROVED: J.P. ... DATE 10-4-66
TOWN ENGINEER

NON Govt Part.
PROJECT BRADFORD
NO. 97 0202-01
SHEET 11 OF 7

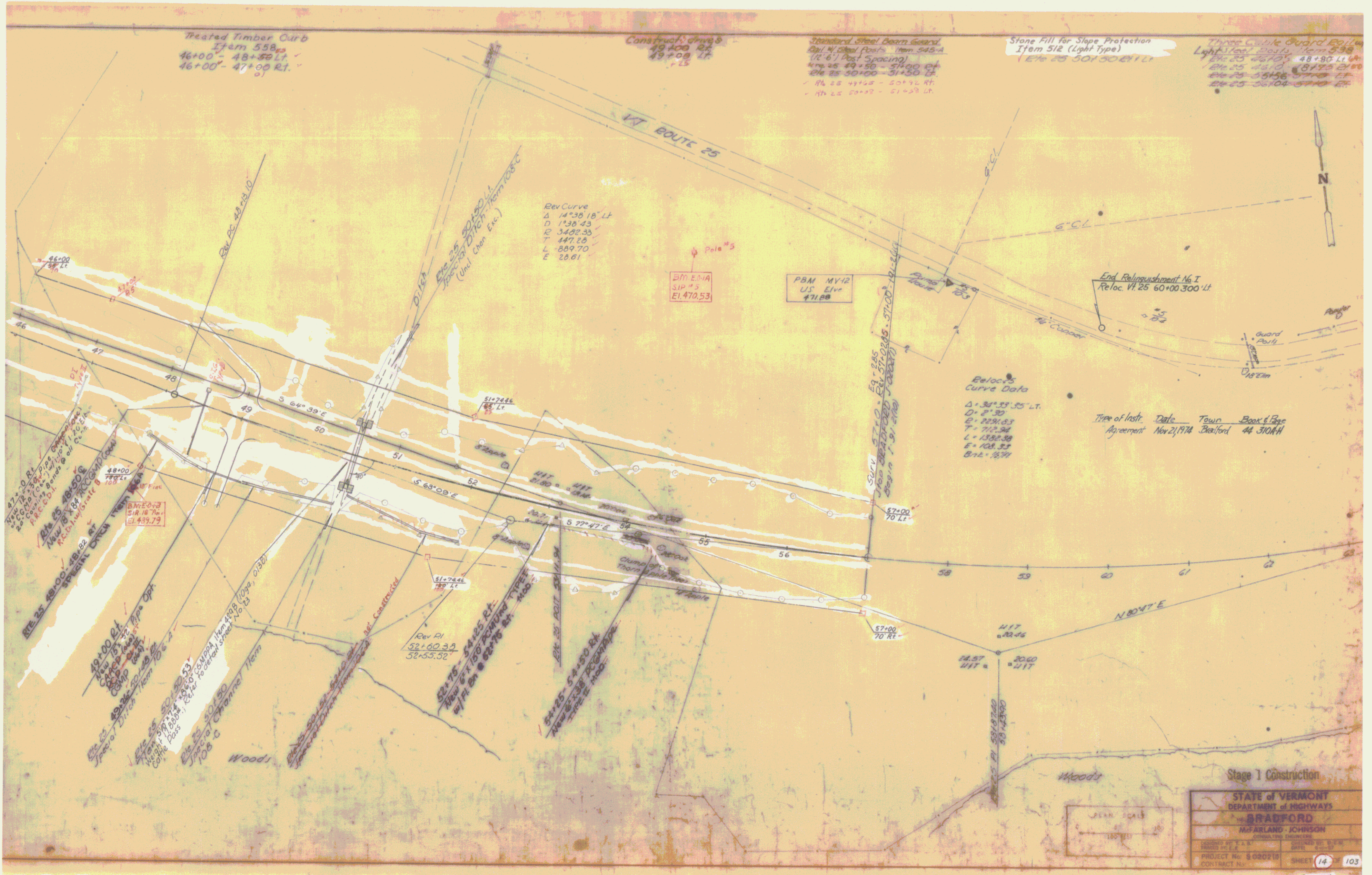

Treated Timber Curb
Item 558
46+00 - 48+50 LT
46+00 - 47+00 RT

Construct. Drive
49+00 RT
49+00 LT

Standard Steel Beam Guard
Rail (6' Post Spacing)
Item 545-A
49+25 - 50+00 - 51+50 LT
49+25 - 50+00 - 51+50 RT

Stone Fill for Slope Protection
Item 512 (Light Type)
49+25 - 50+00 LT

Three Cable Guard Rail
Light Type Posts Item 538
48+80 - 49+00 LT
48+80 - 49+00 RT
49+00 - 50+00 LT
49+00 - 50+00 RT

Rev Curve
Δ 14°36'18" LT
D 138.43
E 3452.35
T 447.28
L 889.70
E 28.61

Pole #5
SIP #5
E1 470.53

PBM MY-12
US Elev
471.88

End Relinquishment No. 1
Reloc. VT 25 60+00.300 LT

Reloc. Curve Data
Δ 34°25'25" LT
D 71.30
E 225.123
T 712.94
L 1382.38
E 108.33
BTL 1.371

Type of Instr. Date Town Book & Page
Agreement Nov 2/1974 Bradford 44 310AH

Stage 1 Construction

STATE OF VERMONT
DEPARTMENT OF HIGHWAYS
BRADFORD
MORLAND JOHNSON
CHIEF ENGINEER

PROJECT NO. 800010
SHEET 14 103
Revised

8

Excavation & Removal of Road Surfaces (for Pavement) Item 119
 Rte 25 88+20-89+00 PL (Existing Rte 25)

Three Cable Guard Rail w/ 11' Clear Path Item 538
 Rte 25 80+25-81+00 LT
 Rte 25 80+25-81+00 LT

Steel Guide Post's Item 591-D
 Rte 25 Connector 0+25-0+20 PL
 Rte 25 Connector 0+25-0+20 PL

Demolition and Disposal of Building Item 586
 Rte 25 85+32 PL No. 9

Treated Timber Curb Item 538
 Rte 25 80+25-85+00 RT

Reloc 25
 Curve Data
 Δ = 37°28'00" LR
 D = 7°30"
 R = 763.94'
 T = 209.07'
 L = 499.56'
 E = 42.73'
 Bat = 196.71'

Approximate location of new 8" water line to be installed by employees or agents of the Bradford Water Commission at or before the time of construction to be inspected and approved by the engineer for further information see Special Provisions

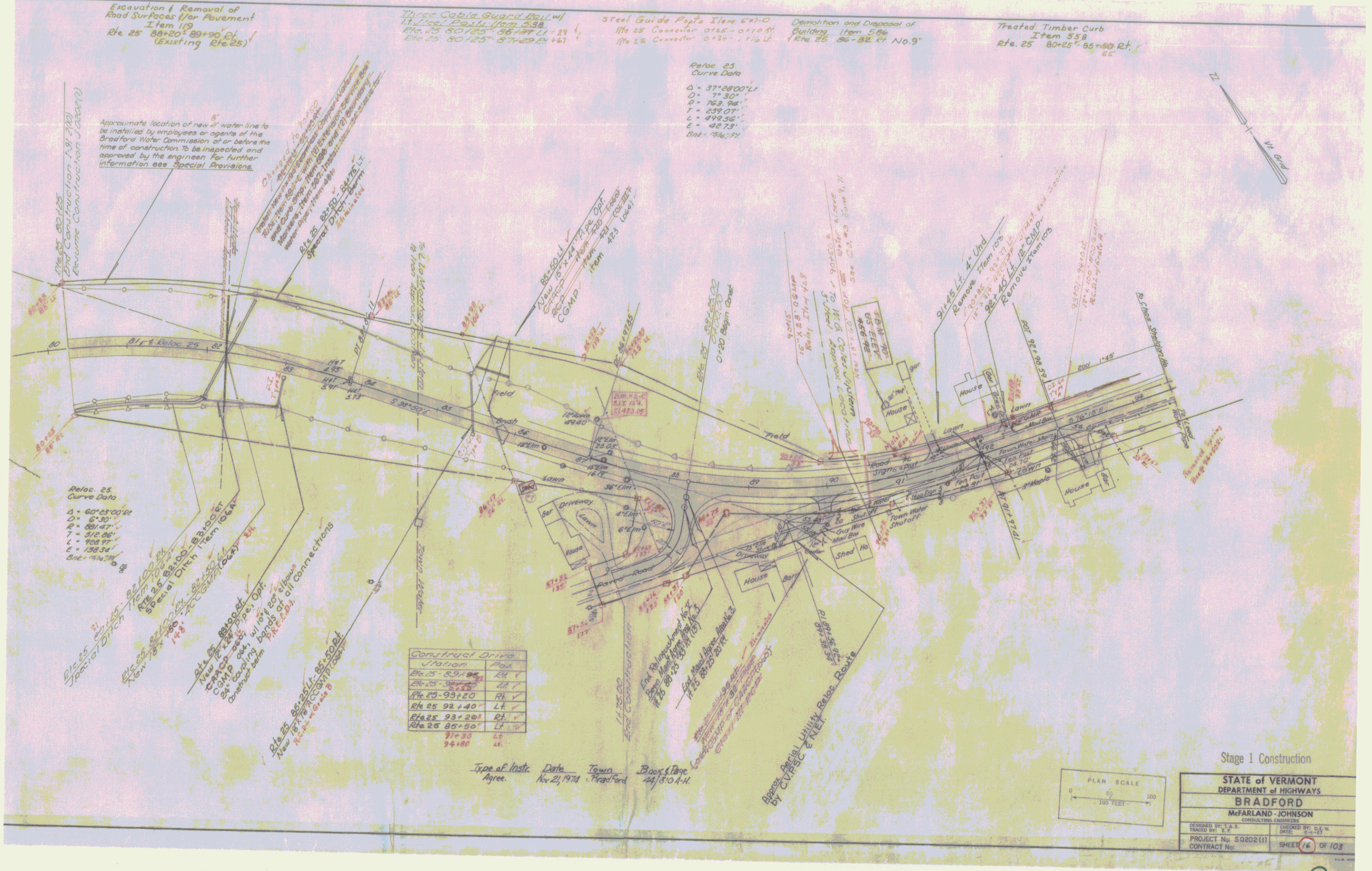

Type of Instr. Date Town Book & Page
 Agree. Nov 21, 1974 Bradford 44/310 4-4

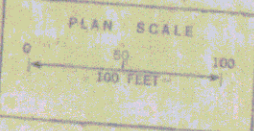

Stage 1 Construction
 STATE of VERMONT
 DEPARTMENT of HIGHWAYS
 BRADFORD
 McFARLAND-JOHNSON
 CONSULTING ENGINEERS
 DESIGNED BY: T.A.S. CHECKED BY: D.E.W.
 TRACED BY: S.F. DATE: 8-1-75
 PROJECT No. S0202(11) SHEET 76 OF 103
 CONTRACT No.

Construct Drives
 95+00 - 95+45 Lt.
 96+00 - 96+75 Rt.
 96+80 - 97+20 Rt.
 99+00 - 100+00 Lt. 77+15
 101+25 Rt.
 94+80 Lt.

Vertical Granite Curb, Item 556-B
 96+00 - 96+00 Rt. 97+00
 94+80 - 95+00 Lt.
 94+80 - 95+00 Lt.
 95+00 - 96+00 Lt. 37
 96+00 - 97+00 Lt.
 97+00 - 101+00 Lt.
 99+67 - 100+15 Rt.

Granite Slope Edging, Item 556-A
 (For Island Area)
 96+35 - 97+15 R.
 99+67 - 100+15 R.

Bit. Conc. Surf. for Gutters
 and Traffic Islands, Item 554 Mod
 100+15 - 100+40 Lt.
 96+35 - 97+15 R.
 99+67 - 100+15 R.
 101+00 - 101+30 Lt. Gutter

Stone Fill for Slope
 Protection (Light Type)
 101+95 - 101+60 Rt.
 101+90 - 101+80 Lt.

Overhead Traffic Sign Support, Item 708

Approximate location of new 8" water line to be installed by employees or agents of the Bradford Water Commission at or before the time of construction. To be inspected and approved by the engineer. See Special Provisions.

Telephone manholes and underground conduit to be installed by others at or before the time of construction. To be inspected and approved by the engineer. See Special Provisions.
 Approximate manhole locations: 916+00-33 Lt. & 324+90-29 Lt.

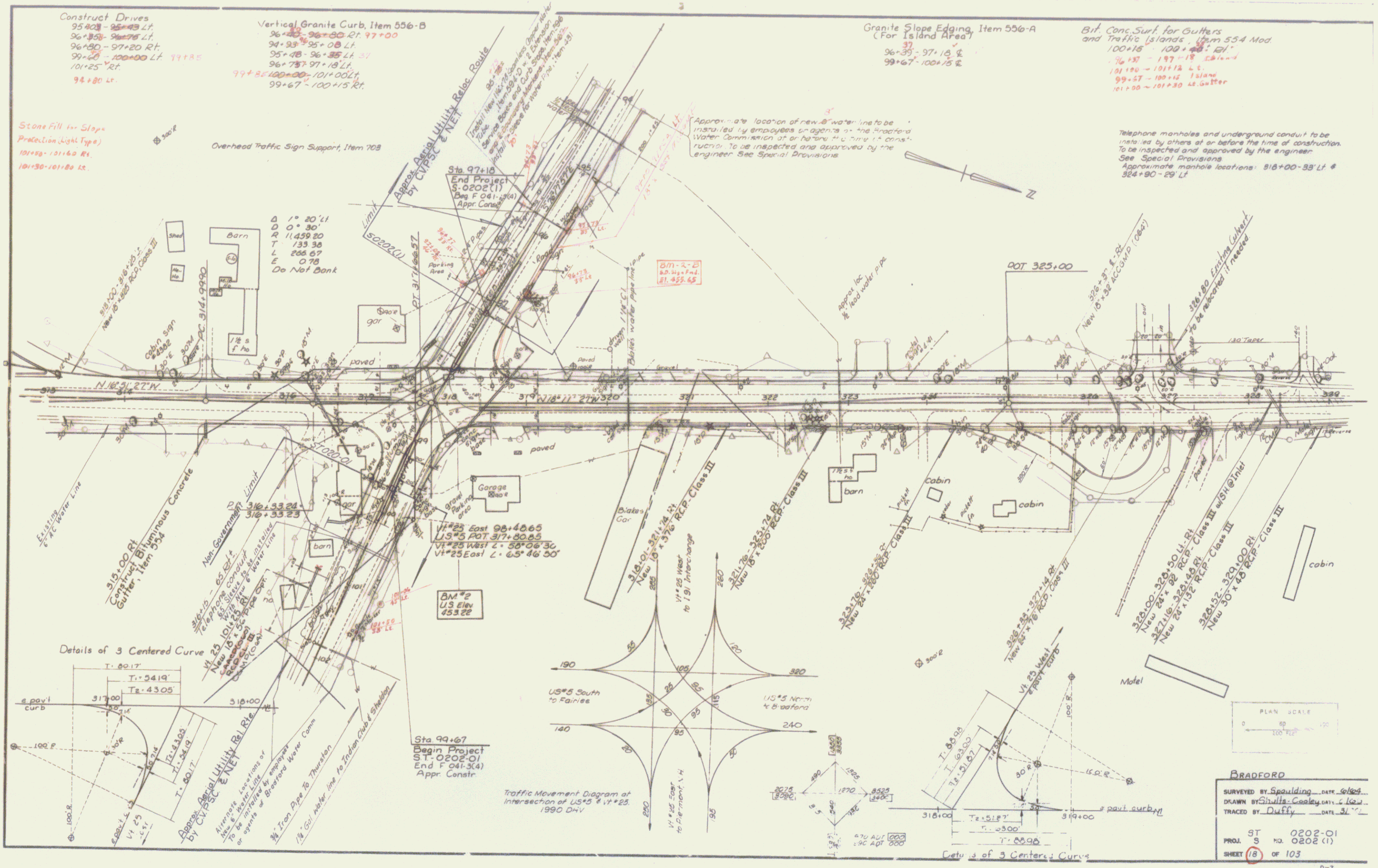

Details of 3 Centered Curve

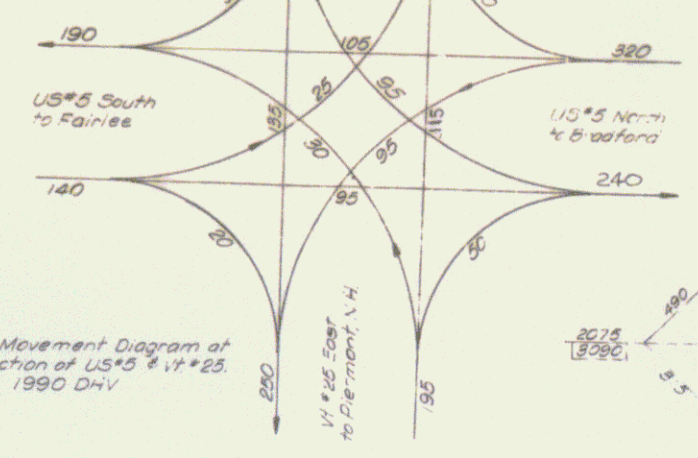
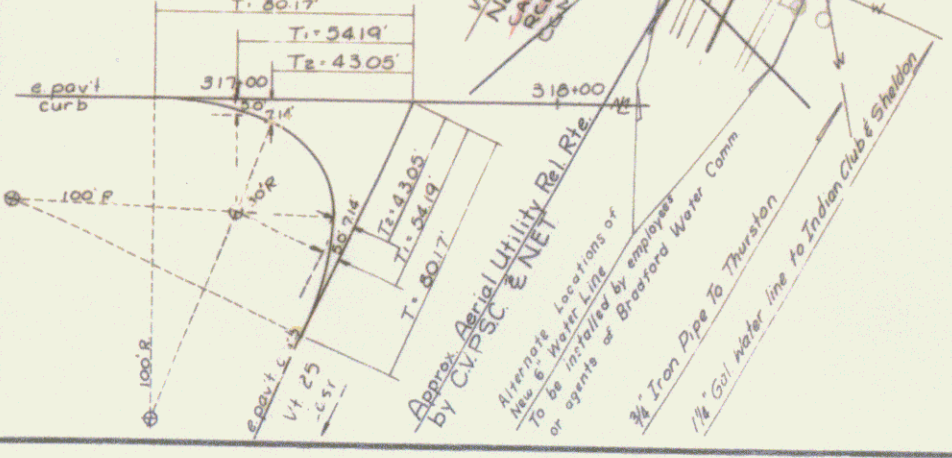

Sta 99+67
 Begin Project
 ST. 0202-01
 End F 041-3(4)
 Appr. Constr.

Traffic Movement Diagram at Intersection of US 5 & VT 25, 1990 Div

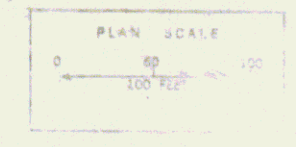

BRADFORD
 SURVEYED BY Spaulding DATE 6/16/64
 DRAWN BY Shultz-Cooley DATE 6/16/64
 TRACED BY Duffy DATE 3/1/71
 ST 0202-01
 PROJ. 5 NO. 0202(1)
 SHEET 18 OF 103