

NEW REINK CONCR PIPE & NEW DROP INLETS

STA	DIAM	LENG	GRATE	CONCR	STEEL
24+30 to 25+32 RT	15"	36'	1	2.3	193"
25+32 RT	~	~	1	2.0	176"
25+32 RT to 25+40 LT	15"	36'	~	~	~
25+40 LT	~	~	~	~	~
25+40 LT to 25+40 LT	~	~	~	0.2 ex	50" (Solid Top)

CHANGING ELEVATIONS OF CATCH BASINS

STATION	LT. OR RT.
16+85	LT.
17+91	RT.
18+03	LT.
18+29	RT.
18+41	LT.
20+07	RT.
22+00	LT.
23+00	RT.

SECTION SHOWING D.I. & GRATE WITH 6" OPENING IN D.I. STA. 25+40 LT.

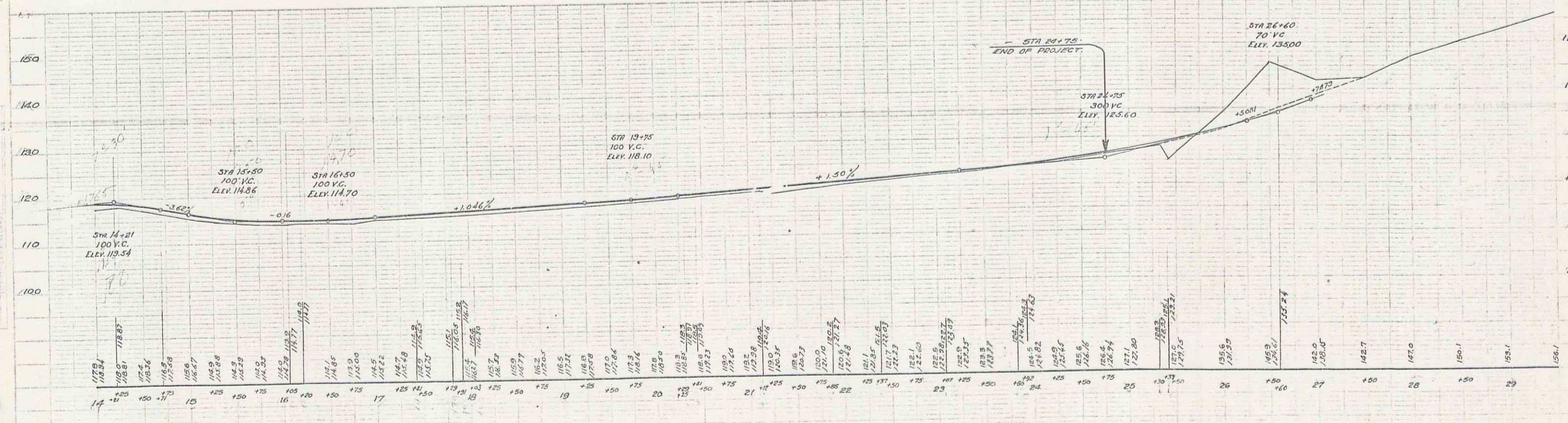
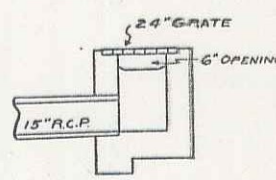

6