

NEW BRICK CATCH BASINS REQUIRED		NEW REIN. CONC. PIPE REQUIRED		DROP INLETS REQUIRED	
STATION	STATIONS	DIAM.	LENGTH	STATION	CONCA. STEEL GRATES
0+44 LT.	0+00LT - 0+44LT.	24	44	12+05RT.	1, 99
2+75 LT.	0+44LT - 2+75LT.	24	230		
4+05 LT.	2+75LT - 4+05LT.	18	132		
6+30 LT.	4+05LT - 6+30LT.	18	226		
7+75 LT.	6+30LT - 7+75LT.	18	88		
8+00 LT.	7+75LT - 8+00LT.	15	28		
8+75 LT.	8+00LT - 8+75LT.	15	96		
10+10 LT.	8+75LT - 10+10LT.	15	140		
10+65 RT.	10+10LT - 10+65RT.	15	60		
11+72 LT.	10+65RT - 11+72LT.	18	94		
12+05 RT.	11+72LT - 12+05RT.	18	8		
12+95 LT.	12+05RT - 12+95LT.	15	144		
13+50 RT.	12+95LT - 13+50RT.	15	128		

1931 1 13

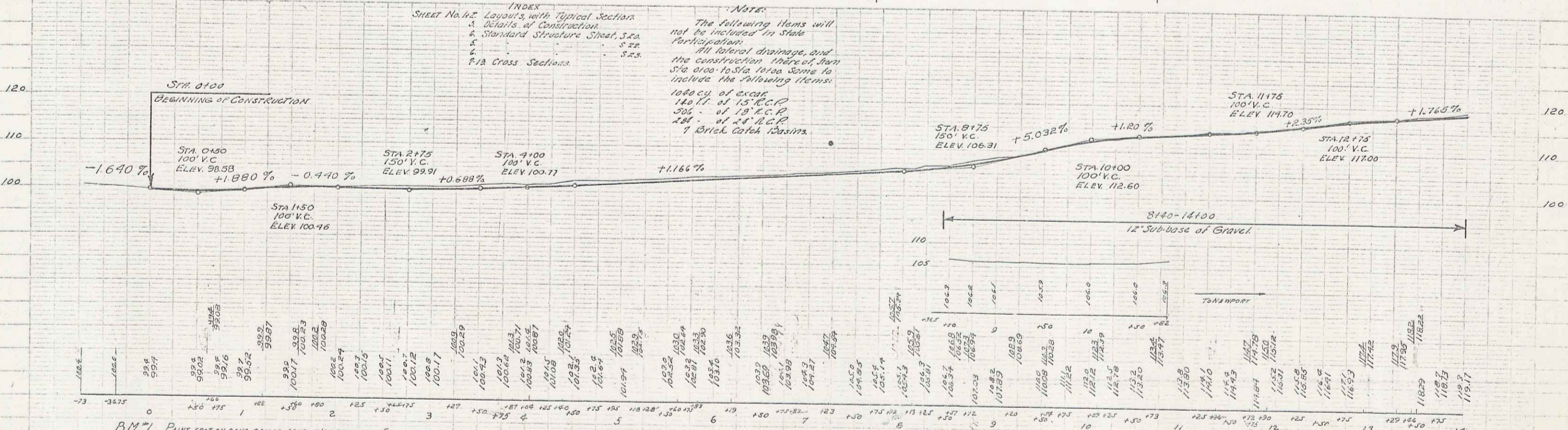
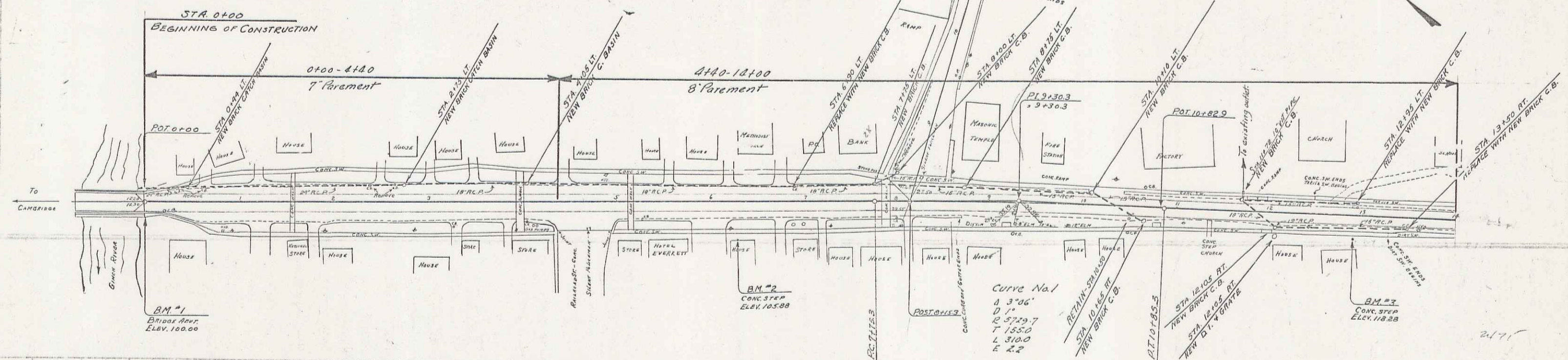

INDEX
 SHEET No. 12
 1. Layouts, with Typical Section
 2. Details of Construction
 3. Standard Structure Sheet, S.S.A.
 4. S.S.
 5. S.S.
 6. S.S.
 P/A Cross Sections

NOTE:
 The following items will not be included in State Participation:
 All lateral drainage, and the construction thereof, from STA 0+00 to STA 10+00. Some to include the following items:
 100% of 15' R.C.P.
 50% of 18' R.C.P.
 28' of 24' R.C.P.
 7 Brick Catch Basins.

BM #1 PAINT SPOT ON CONC. BRIDGE ABUT. 17 RT. STA. 0+00 ELEV. 100.00
 BM #2 RIDDLE BRGS. STAKE. PAINT SPOT ON CONC. STEP RAIL 915 RT. STA. 6+25 ELEV. 105.88
 BM #3 PAINT SPOT ON CONC. STEP 25 RT. STA. 12+30 ELEV. 118.28.

TOWN OF ULMERSON
 PROPOSED STREET IMPROVEMENT ON ROUTE 13
 CAMBRIDGE - MORRISVILLE ROAD
 SHEET 1 OF 13