

**GUARD RAIL REQUIRED ON LEFT**

Sta. 109+00	to Sta. 109+50	Length	50'
Sta. 112+64	to Sta. 113+12	"	48'
Sta. 116+23	to Sta. 116+47	"	24'
Sta. 121+70	to Sta. 121+94	"	24'
<b>ON RIGHT</b>			
Sta. 112+76	to Sta. 113+00	"	24'
Sta. 116+23	to Sta. 116+47	"	24'
Sta. 121+70	to Sta. 121+94	"	24'
<b>Total This Sheet</b>			<b>268'</b>

**CULVERT REPAIRS REQUIRED**

Sta. 112+88	2x2 Concrete	31'
1-2-4	"	8.24 Cu.Yd.
1-3-6	"	8.06 "
116+35	12" Corr. Iron Pipe	28'
Concrete Headwalls 1-2-4		1.0 Cu.Yd.
121+82	12" Corr. Iron Pipe	28'
Concrete Headwalls 1-2-4		1.0 Cu.Yd.

VEG. REMOVAL	TOTAL	ADJ.	SHOUL.	TOTAL
sq. ft.	sq. ft.	sq. ft.	sq. ft.	sq. ft.
0	17	24	120	161

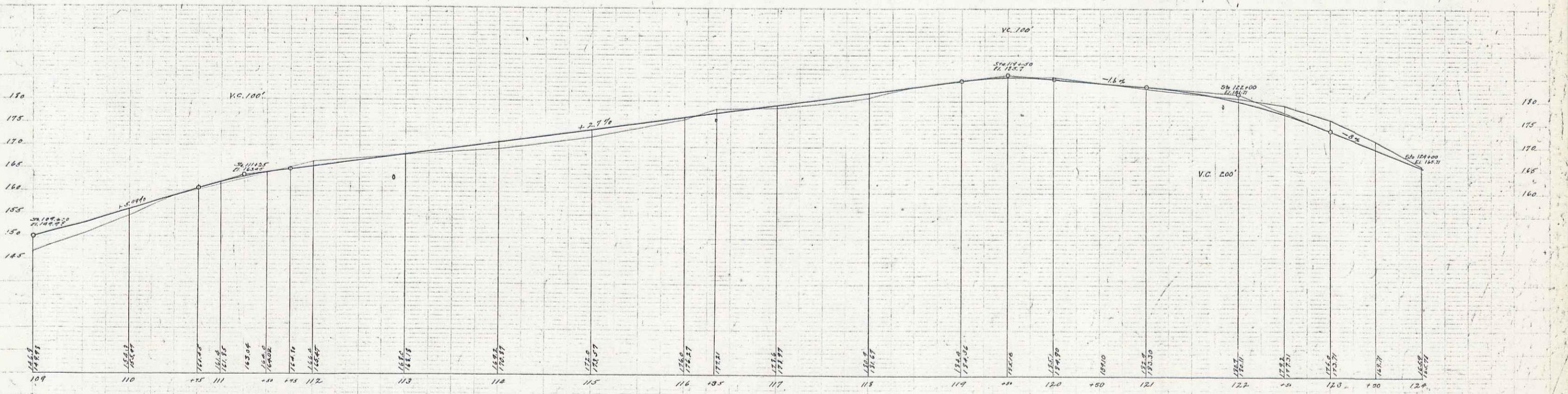
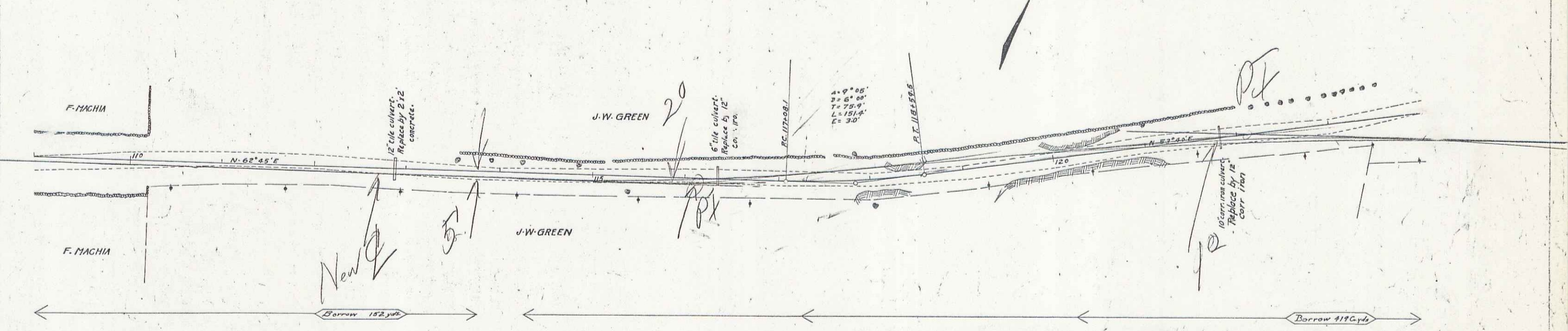

B.P. On Rock So. of Sta. 113+85 Elev. 171.48  
 B.P. Nail in Willow Tree No. of Sta. 122+20 Elev. 161.47

Series F No. 24 Plan  
 Sheet 10 of 58