

BR

INDEX OF SHEETS

SHEET NO	TITLE PAGE
2	TYPICAL CROSS-SECTION OF IMPROVEMENT
3	PLAN AND PROFILE STA. 0+00 TO STA. 15+00
4	" " " " " " 15+00 " " 31+00
5	" " " " " " 31+00 " " 47+00
6	" " " " " " 47+00 " " 63+00
7	" " " " " " 63+00 " " 79+00
8	" " " " " " 79+00 " " 93+00
9	" " " " " " 93+00 " " 109+00
10	" " " " " " 109+00 " " 124+00
11	" " " " " " 124+00 " " 140+00
12	" " " " " " 140+00 " " 153+00
13	" " " " " " 153+00 " " 169+00
14	" " " " " " 169+00 " " 185+00
15	" " " " " " 185+00 " " 200+00
16	" " " " " " 200+00 " " 213+00
17-18	BRIDGE AT STA. 17+56
19-38	CROSS SECTIONS
39	PLAN AND PROFILE STA. 0+00 TO STA. 11+00 B 0
40	" " " " " " 11+00 B " " 13+35 B 0
41-42	CROSS-SECTIONS. 0

STATE OF VERMONT  
STATE HIGHWAY DEPARTMENT

PLAN AND PROFILE OF PROPOSED  
STATE HIGHWAY

FEDERAL AID PROJECT

TOWN OF CAMBRIDGE  
LAMOILLE RIVER ROAD  
FROM SMUGGLERS NOTCH ROAD 2130 FT. EASTERLY  
EXTENDED 1315 FT. WESTERLY AUG. 1922

Plan: 1" = 50' E  
Scale: Profile-Hor. 1" = 50' Vert. 1" = 10' E  
Cross-Sections: 1" = 5' E

FED. ROAD DIST. NO.	STATE	FED. AID PROJ. NO.	FISCAL YEAR	SHEET NO.	TOTAL SHEETS
3	V.T.	29	1921	1	42

*Maro Wilmes*

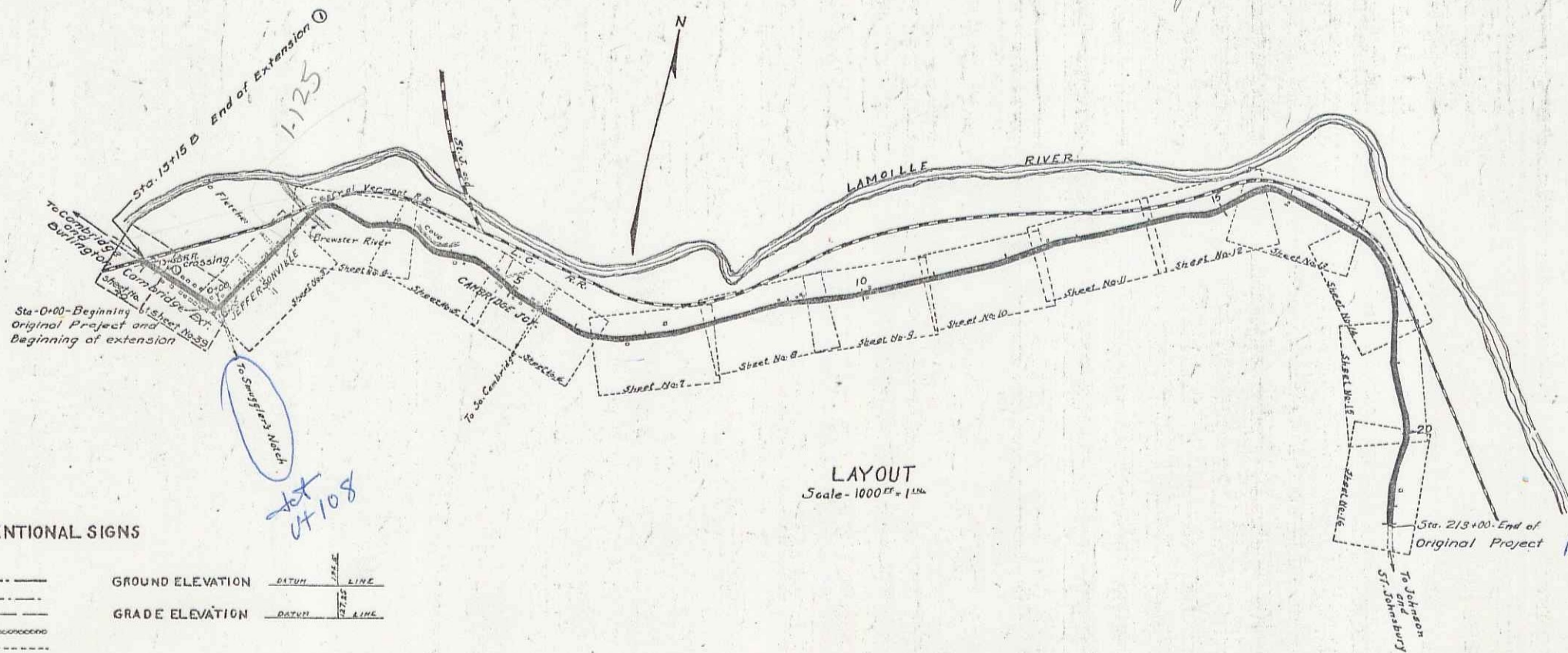

RIGHT-OF-WAY DIVISION  
TOWN FILE  
PERPETUAL  
Town of UTIS  
(To Be Returned To R.O.W. Division)

CONVENTIONAL SIGNS

COUNTY LINE	-----	GROUND ELEVATION	-----
TOWN LINE	-----	GRADE ELEVATION	-----
FENCE LINE	-----		
STONE WALL	-----		
UNFENCED PROPERTY	-----		
GUARD RAIL	-----		
TRAVELCO WAY	-----		
RAILROAD	-----		
RETAINING WALL	-----		
BASE OR SURVEY LINE	-----		
CULVERT	-----		
DROP INLET	-----		
TROLLEY POLE	-----		
POWER POLE	-----		
TELEPHONE POLE	-----		
TREES	-----		
HERSE	-----		

RECOMMENDED \_\_\_\_\_  
STATE ENGINEER  
APPROVED \_\_\_\_\_  
GOVERNOR  
SUBMITTED \_\_\_\_\_  
STATE HIGHWAY COMMISSIONER

RECOMMENDED \_\_\_\_\_  
DISTRICT ENGINEER  
BUREAU OF PUBLIC ROADS  
RECOMMENDED FOR APPROVAL \_\_\_\_\_  
CHIEF ENGINEER - BUREAU OF PUBLIC ROADS  
APPROVED \_\_\_\_\_  
DIRECTOR - BUREAU OF PUBLIC ROADS

Series F. No. 29 Filed  
Sheet 1 of 42 @

© 8-9-22 O.E.G.

RT 2