

INDEX OF SHEETS

SHEET NO. 1	TITLE PAGE
" 2	TYPICAL CROSS-SECTION OF IMPROVEMENT PLACE SURFACE COURSE WITH CRUSHED GRAVEL MIXED-IN
" 3	BANKING AND WIDENING TABLES
" 4-12	PLAN AND PROFILE STA
" 13	STANDARD STRUCTURE SHEET 5-28 PIPE CULVERTS
" 14	" " " 5-29 BOX CULVERTS
" 15	" " " 5-30 GUARD RAIL
" 16	" " " 5-31 BOUNDARY MARKERS
" 17	" " " 5-35 CONCRETE CRIBBING
" 18	" " " 5-40 BARRICADES, LIGHTS, SIGNS
" 19	" " " 5-41 ROUNDED SLOPES
" 20-65	CROSS SECTIONS

STANDARD STRUCTURE SHEETS APPROVED BY THE CHIEF ENGINEER
 5-28 & 29 JULY 11, 1933
 5-30 AUG 15, 1933
 5-31 JULY 25, 1934

STATE OF VERMONT
 STATE HIGHWAY DEPARTMENT
 PLAN AND PROFILE OF PROPOSED
 STATE HIGHWAY
 FEDERAL AID PROJECT

FED. ROAD DIST. NO.	STATE	FED. AID PROJ. NO.	FISCAL YEAR	SHEET NO.	TOTAL SHEETS
9	VT.	COUL 2	1940	7	63

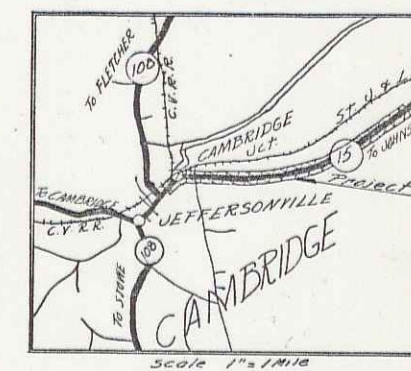

TOWN OF CAMBRIDGE Pin # 00R293
 CAMBRIDGE MORRISVILLE ROAD
 BEGINNING AT A POINT 671 FT. EASTERLY FROM ITS INTERSECTION WITH ROUTE 108 TO ENOSBURG & EXTENDING N. EASTERLY 2.337 MILES.

LENGTH OF PROJECT 12341.9 FEET = 2.337 MILES

STA. 3+51 F.A.P. 24 CONT. 2 =
 STA. 18+15.5 F.A.P. 24 CONT. 1
 BEGINNING OF PROJECT
 F.A.P. 24 CONT. 2

MP 580+
 5.25

RECORD PLANS
 GOVERNMENT PLANS NOT AVAILABLE

STA. 127+00
 END OF PROJECT
 F.A.P. 24 CONT. 2
 142+64 OF F.A.P. 24
 CONTRACT 1

7.57
 MP 269

RIGHT-OF-WAY DIVISION
 TOWN FILE

PERPETUAL
 Town of U-15
 (To Be Returned To R.O.W. Division)

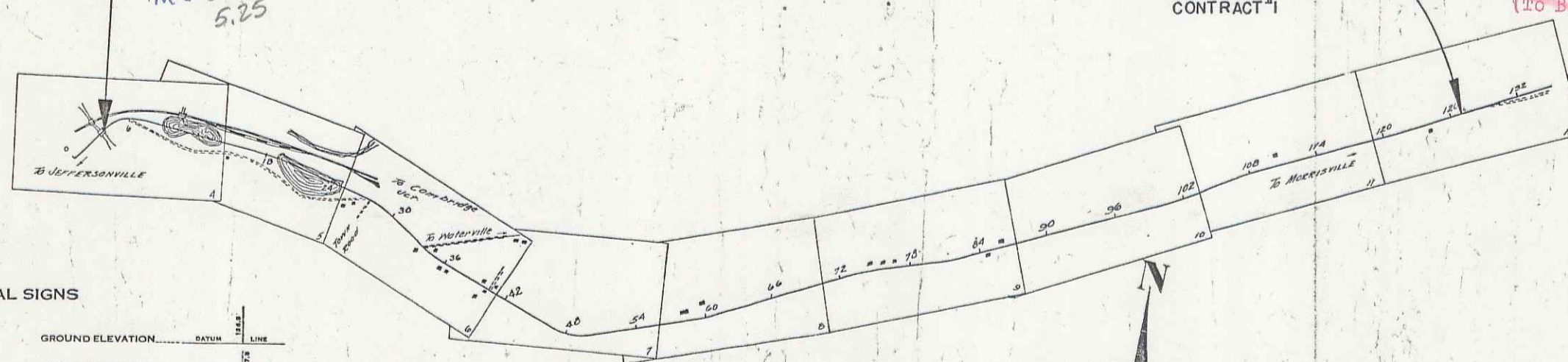

CONVENTIONAL SIGNS

COUNTY LINE	GROUND ELEVATION - DATUM
TOWN LINE	GRADE ELEVATION - DATUM
FENCE LINE	
STONE WALL	
UNFENCED PROPERTY	
GUARD RAIL	
TRAVELED WAY	
RAILROAD	
RETAINING WALL	
CENTER LINE	
SURVEY LINE	
CULVERT	
DROP INLET	
TROLLEY POLE	
POWER POLE	
TELEPHONE POLE	
TREES	
HEDGE	

CURVE DATA

DEFLECTION ANGLE	Δ
DEGREE OF CURVE	D
RADIUS OF CURVE	R
TANGENT DISTANCE	T
LENGTH OF CURVE	L
EXTERNAL DISTANCE	E
POINT OF INTERSECTION	P. I.
POINT OF CURVE	P. C.
POINT OF TANGENT	P. T.
POINT ON TANGENT	P. O. T.

These plans are subject to such revisions as may be required by the Bureau of Public Roads or the Commissioner of Highways. Construction is to be carried on in accordance with the plans and standard engineering specifications of 1936 as approved December 23, 1936 by the Bureau of Public Roads including all subsequent approved revisions and such revised specifications and special provisions as are submitted with the plans. Approval of the construction is given on the fact that the State Highway Board reserves the right to extend this project at the same contract price. Such cost of extension not to exceed 25% of the amount of the contract.

* PLAN SET INCLUDES 1926'S SURVEY

SCALES

TITLE	1" = 600'
TYPICAL	1" = 20'
PLAN	1" = 50'
PROFILE	HOR. 1" = 50'
CROSS SECTIONS	1" = 5'

APPROVED: Oct 1, 1937
 Commissioner of Highways

SUBMITTED BY ORDER OF THE STATE HIGHWAY BOARD

RECOMMENDED [Signature]
 DISTRICT ENGINEER
 BUREAU OF PUBLIC ROADS
 RECOMMENDED FOR APPROVAL [Signature]
 CHIEF ENGINEER
 BUREAU OF PUBLIC ROADS
 APPROVED [Signature]
 DIRECTOR - BUREAU OF PUBLIC ROADS

APPROVED [Signature] CORRECT Oct 1, 1937
 DISTRICT ENGINEER ROAD ENGINEER
 SERIES F.A.P. No. 24 Cont. 2 FILED
 SHEET 1 OF 63