

**INDEX OF SHEETS**

SHEET NO.	TITLE PAGE	CRUSHED GRAVEL MIXED-IN-PLACE SURFACE COURSE WITH REPAVED TIE
1	TYPICAL CROSS-SECTION OF IMPROVEMENT BANKING AND WIDENING TABLES	
2	PLAN & PROFILE SHEETS	
3	STANDARD STRUCTURE SHEET 3-28	Pipe Culvert
4	10	3-29 Box
5	11	3-30 Guard Rail
6	12	3-31 Boundary Markers
7	13	3-40 Barricaded Signs & Lights
8	14	
9	15	
10	16	
11	17	
12	18	
13	19	
14	20	
15	21	
16	22	
17	23	
18	24	
19	25	
20	26	
21	27	
22	28	
23	29	
24	30	
25	31	

STANDARD STRUCTURE SHEETS APPROVED BY THE CHIEF ENGINEER  
 SHEETS 328 & 329 JULY 11, 1933  
 " 330 " " " AUG. 15, 1933  
 " 331 " " " JULY 25, 1934

STATE OF VERMONT  
 STATE HIGHWAY DEPARTMENT

PLAN AND PROFILE OF PROPOSED  
 STATE HIGHWAY

FEDERAL AID PROJECT

TOWN OF CAMBRIDGE

JEFFERSONVILLE - CAMBRIDGE ROAD

BEGINNING AT A POINT 0.7 MILES WESTERLY OF THE JCT. OF ROUTES 108 & 15 & EXTENDING WESTERLY 1.202 MILES TO A POINT 1.5 MILES EASTERLY OF THE JCT. OF ROUTES 15 & 104

LENGTH OF PROJECT 6350.5 FT. 1.202 MI.

FED. ROAD DIST. NO.	STATE	FED. AID PROJ. NO.	FISCAL YEAR	SHEET NO.	TOTAL SHEETS
9	Vt.	122-A	1937	1	33

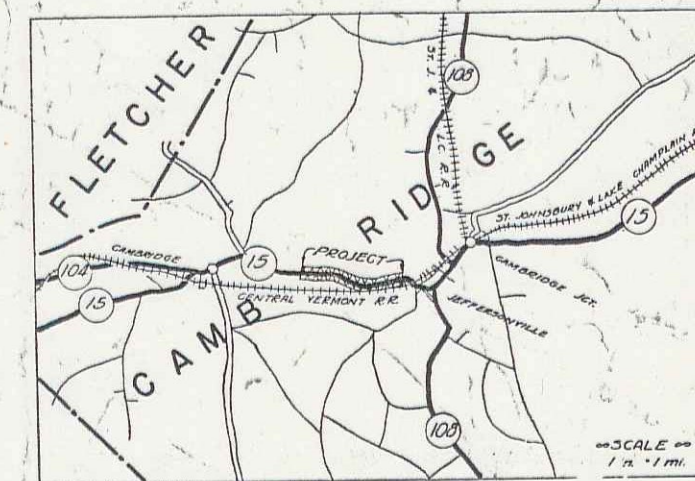

RECORD PLANS

BY R. O. MAY 4-15-38

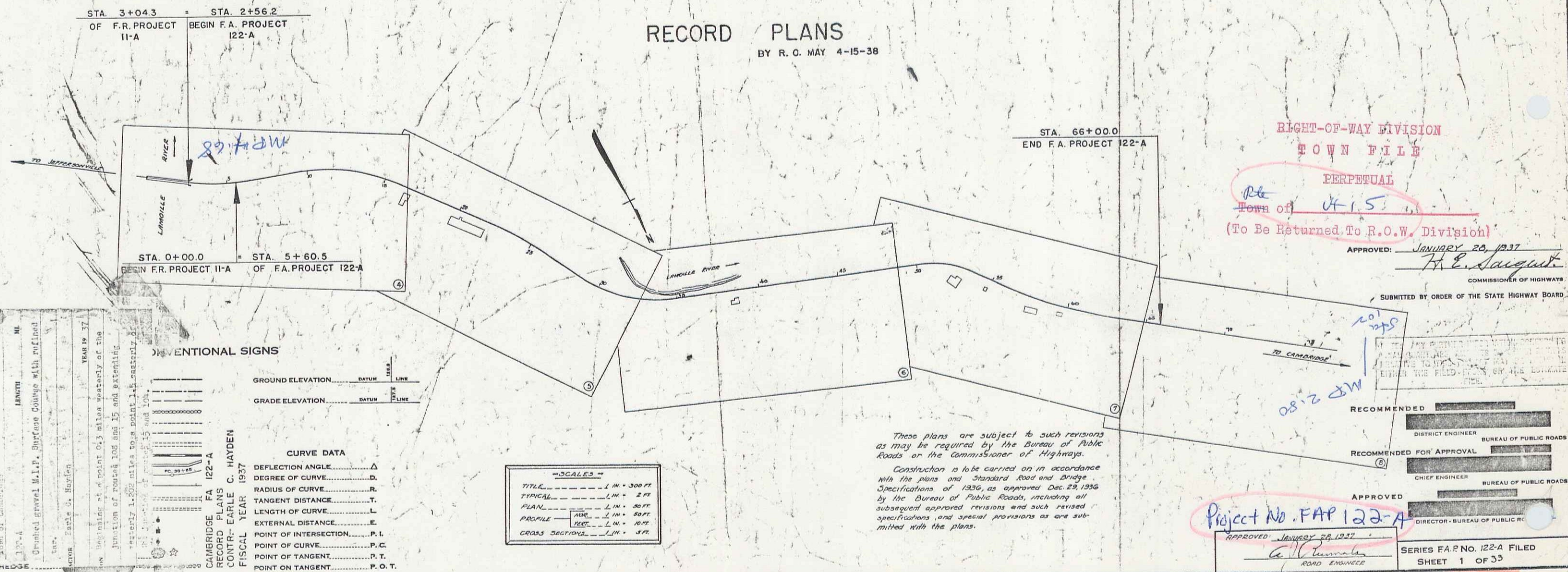

RIGHT-OF-WAY DIVISION  
 TOWN FILE  
 PERPETUAL  
 Town of U-1.5  
 (To Be Returned To R.O.W. Division)  
 APPROVED: JANUARY 20, 1937  
R. E. Saigant  
 COMMISSIONER OF HIGHWAYS  
 SUBMITTED BY ORDER OF THE STATE HIGHWAY BOARD  
 RECOMMENDED \_\_\_\_\_  
 DISTRICT ENGINEER BUREAU OF PUBLIC ROADS  
 RECOMMENDED FOR APPROVAL \_\_\_\_\_  
 CHIEF ENGINEER BUREAU OF PUBLIC ROADS  
 APPROVED \_\_\_\_\_  
 DIRECTOR - BUREAU OF PUBLIC ROADS  
 Project No. FAP 122-A  
 APPROVED: JANUARY 20, 1937  
R. O. May  
 ROAD ENGINEER  
 SERIES F.A.P. NO. 122-A FILED  
 SHEET 1 OF 33

These plans are subject to such revisions as may be required by the Bureau of Public Roads or the Commissioner of Highways.  
 Construction is to be carried on in accordance with the plans and Standard Road and Bridge Specifications of 1936, as approved Dec. 23, 1936 by the Bureau of Public Roads, including all subsequent approved revisions and such revised specifications and special provisions as are submitted with the plans.

SCALES

TITLE	1 in. = 300 FT.
TYPICAL	1 in. = 2 FT.
PLAN	1 in. = 30 FT.
PROFILE	1 in. = 30 FT.
CROSS SECTIONS	1 in. = 4 FT.