

FED. DIST. NO.	STATE	FED. AID PROJ. NO.	FISCAL YEAR	SHEET NO.	TOTAL SHEETS
3	VT	122(2)			

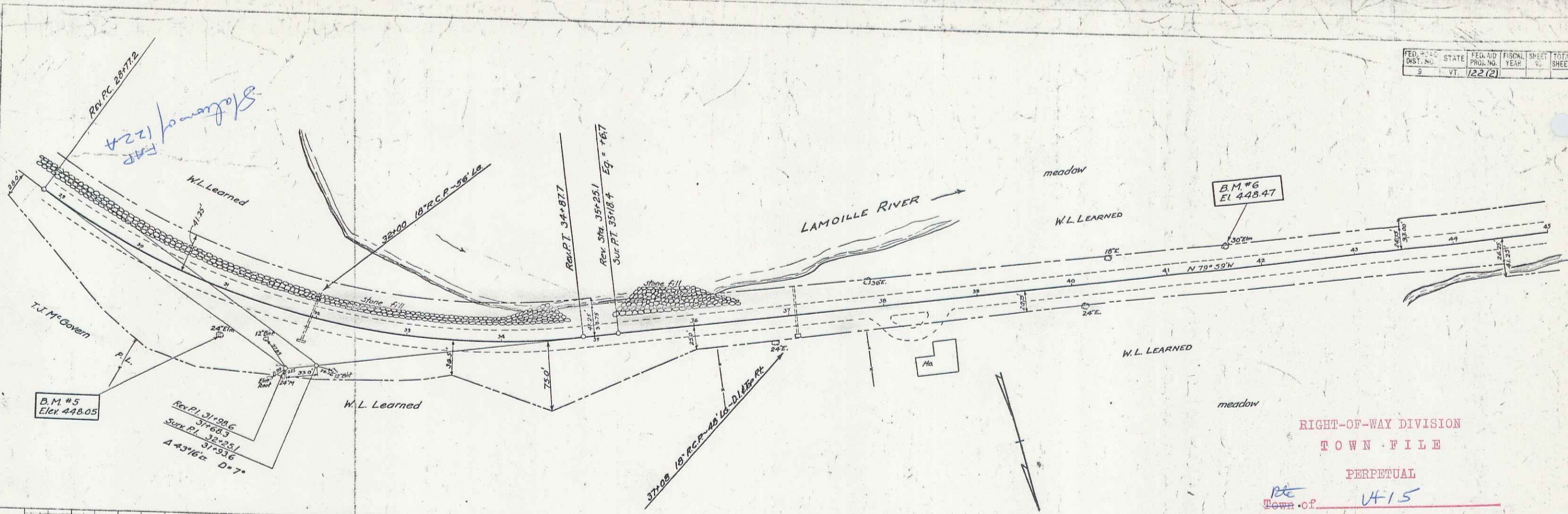

RIGHT-OF-WAY DIVISION
TOWN FILE
PERPETUAL
Town of VT 15
(To Be Returned To R.O.W. Division)

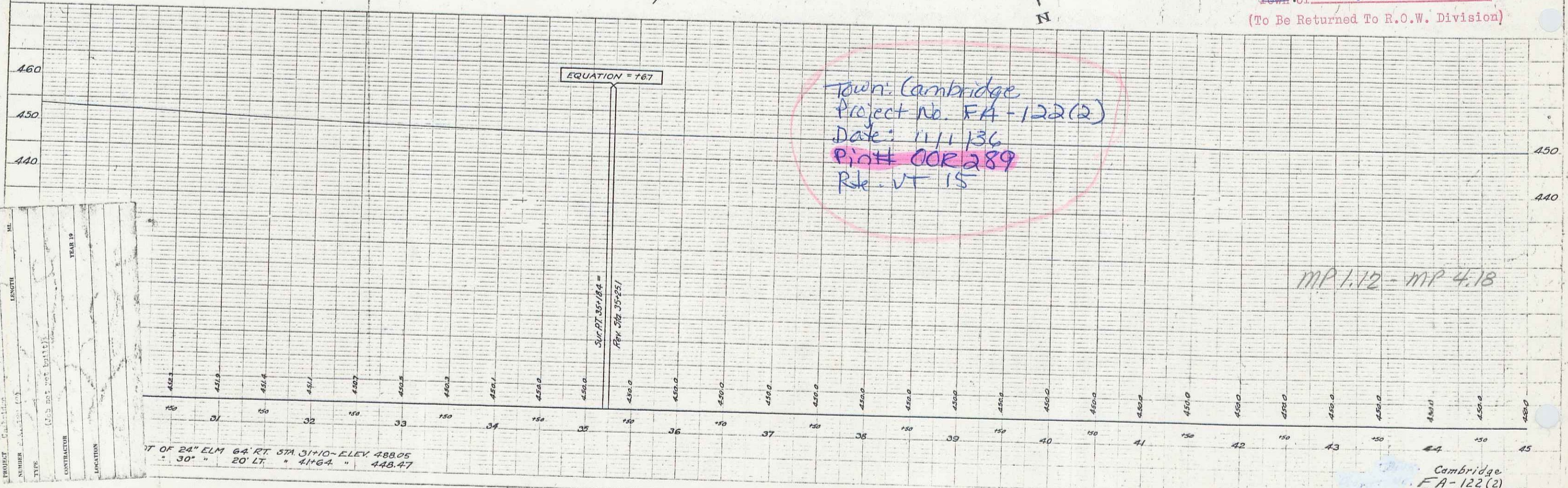

PT OF 24" ELM 64' RT STA 31+10 - ELEV. 488.05
" 30" " 20' LT. " 416.4 " 448.47

MP 1.12 - MP 4.18

Cambridge
FA-122(2)
Sheet 1 of 14 Sheets

PLAN
DATE: 11/1/36
DRAWN BY: [illegible]
CHECKED BY: [illegible]
NOTE BOOK
NO. OF SHEETS: 14

DATE	BY	REVISION

PROJECT	LOCATION	YEAR
Cambridge		
NUMBER	LENGTH	TYPE
122(2)		
CONTRACTOR	LOCATION	YEAR