

Sta. 159+00 to Sta. 161+50+ left embankments as shown on the cross-sections to be made from solid rock excavation encountered on the project between Sta. 50+00 and Sta. 190+00. This work will be paid for under the item of Solid Rock Excavation and also under the item of Stone Fill, Item 69, and the embankments shall be constructed in accordance with Item 69.

PARCEL INSTRUMENT	DATE	GRANTOR	GRANTEE	RECORDED	REMARKS
A-B-C	Q.C.A.	9-24-38	VERNE H. DARLING	STOFF.	
				WOLCOTT	
				BOOK 24	
				PAGE 192	
				DATE 9-25-38	CH. H. 30 18570-187

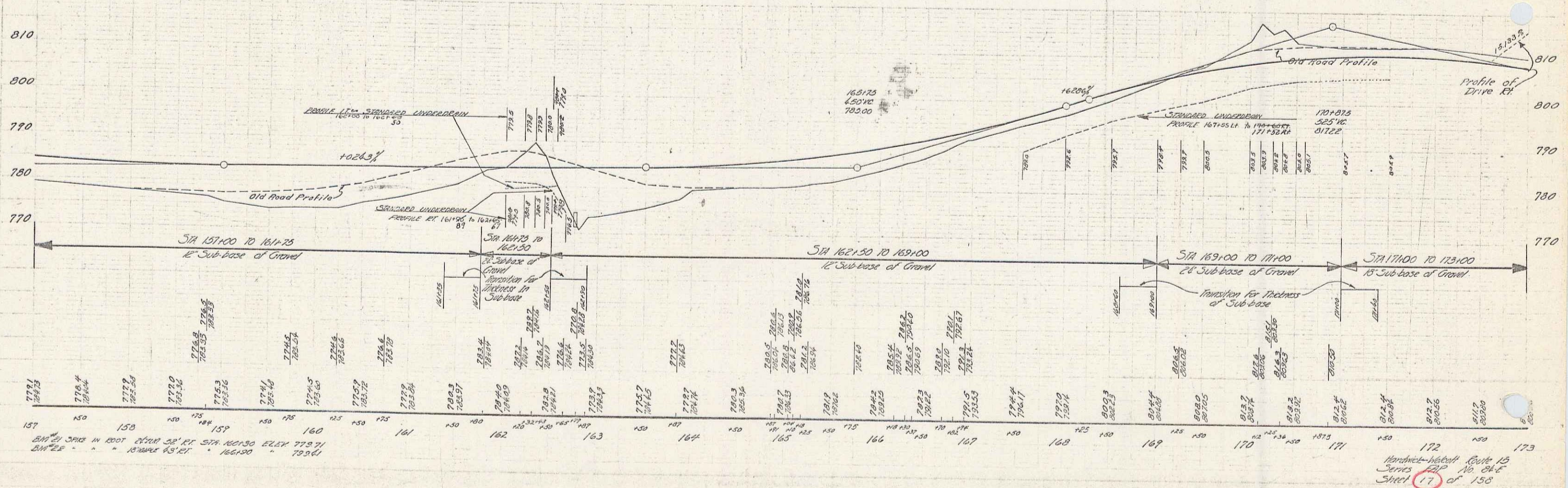

Handwritten notes at the bottom right of the profile view, including "Sheet 17 of 158" and "17".