

The attention of the contractor is called to the 14" water pipe across the road. A 2" cast iron pipe as a sleeve is to be laid at this location. The work to be done by the contractor of contract bid prices for the items involved except for the purchase of the sleeve which shall be an extra merit item. (The connections of above water pipe to be made by property owner.)

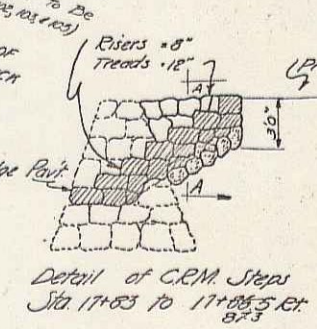

PARCEL	INSTRUMENT	DATE	GRANTOR	GRANTEE	RECORDED	REMARKS
A	CONDEN	9-16-38	ST. J. & L.C.R.R.	ST. OF VT.	108 23 2875 5836	
B-C	Q.C.D.	10-17-38	WALTER S. BROOKS & HADWICH TRUST CO.	ST. OF VT.	41 41-4 10-19-38	

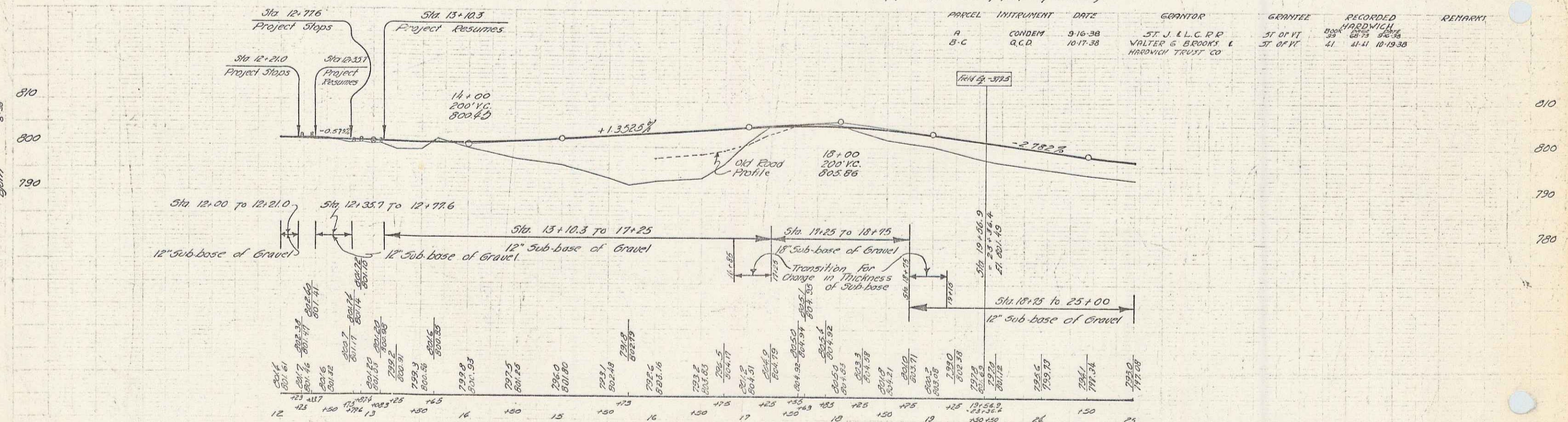

BM#2 Spot on Conc. Fdn 160' RT Sta 10+15' Elev 802.23
 BM#3 Spot in Road 270' RT Sta 13+15' Elev 803.13
 BM#4 Spot on Conc. Steps 60' LT Sta 18+25' Elev 807.79

Hadwicks-Wobcote Route 15
 Series E.P. No. 84 E
 Sheet 6 of 158