

SHEETS # 4 & 5 MISSING

INDEX OF SHEETS

SHEET NO. 1	TITLE PAGE
2	TYPICAL CROSS-SECTION OF IMPROVEMENT GRADING, BASE & CULVERT CONST.
3	BANKING AND WIDENING TABLES
4-8	PLAN AND PROFILE SHEETS
9	STANDARD STRUCTURE SHEET 5-20 PIPE CULVERTS
10	BARRICADES, SIGNS, AND LIGHTS SB-11
11-22	CROSS SECTIONS

FED. ROAD DIST. NO.	STATE	FED. AID PROJ. NO.	FISCAL YEAR	SHEET NO.	TOTAL SHEETS
9	VT.	E-81-C	1932	1	22

STATE OF VERMONT
STATE HIGHWAY DEPARTMENT

PLAN AND PROFILE OF PROPOSED
STATE HIGHWAY

FEDERAL AID PROJECT

TOWN OF DANVILLE *Pin# 001276*
WEST DANVILLE HARDWICK ROAD

FROM 2400 FEET WEST OF INTERSECTION
WITH ROUTE 18 IN WEST DANVILLE WESTERLY
1.013 MILES TO SIDE ROAD TO JOE'S POND
LENGTH OF PROJECT: 5348.8 FEET = 1.013 MILES

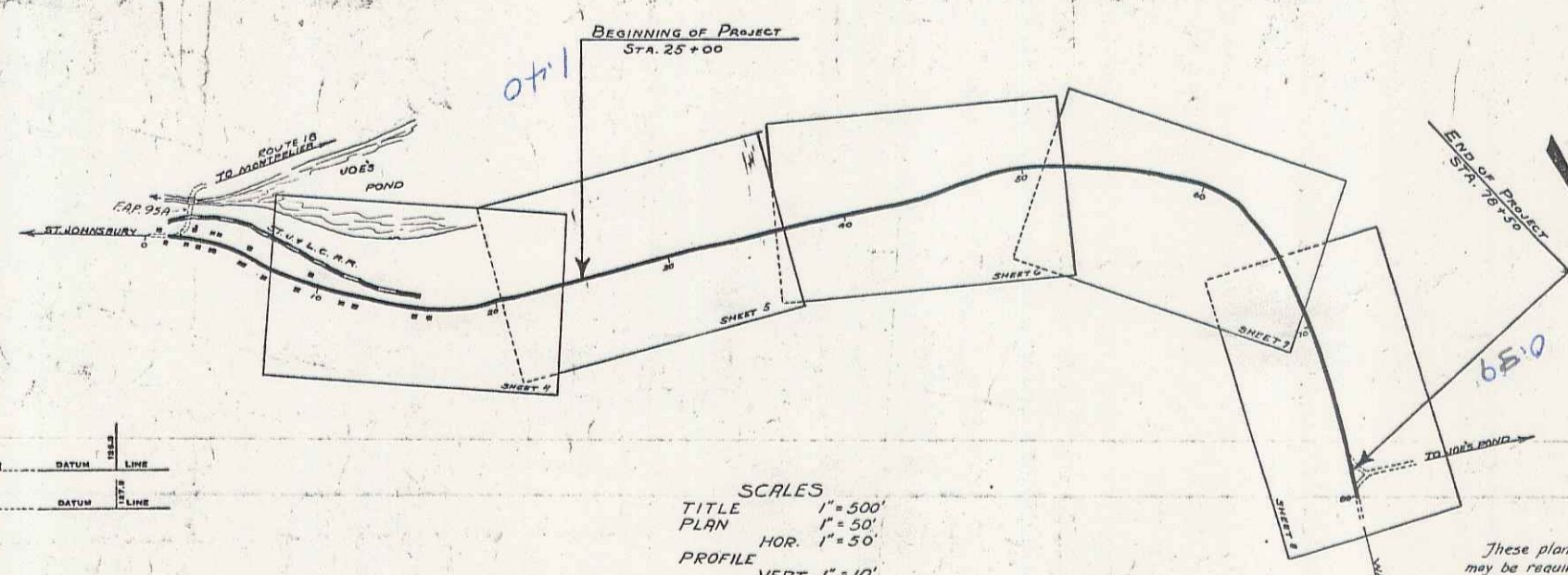
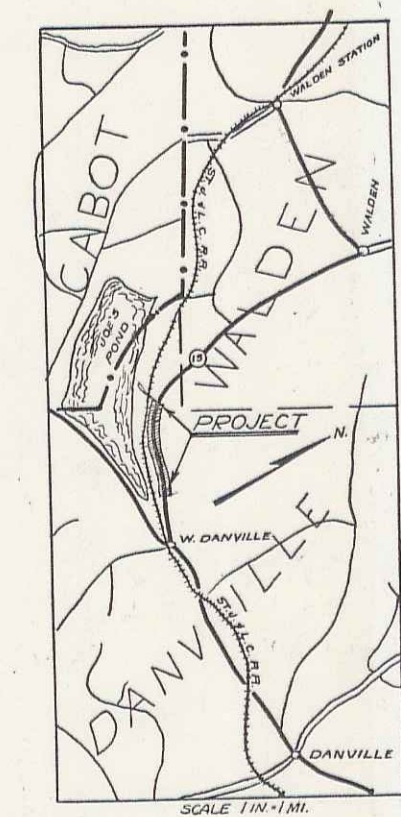

RECORD PLAN

APPROVED: *Oct 7 1932*
H. J. Sargent
COMMISSIONER OF HIGHWAYS

NOTE: ANY FURTHER INFORMATION CONCERNING FINAL QUANTITIES, AMOUNTS OR OTHER DETAILS RELATIVE TO THIS PROJECT MAY BE FOUND IN EITHER THE FIELD BOOKS OR THE ESTIMATE FILE.

NOTE: For sheets 4 & 5 of E-81-C see sheets 5 & 6-81-M

CONVENTIONAL SIGNS

COUNTY LINE
TOWN LINE
FENCE LINE
STONE WALL
UNFENCED PROPERTY
GUARD RAIL
TRAVELED WAY
RAILROAD
RETAINING WALL
CENTER LINE
SURVEY LINE
CULVERT
DROP INLET
TROLLEY POLE
POWER POLE
TELEPHONE POLE
TREES
HEDGE

CURVE DATA

DEFLECTION ANGLE Δ
DEGREE OF CURVE D
RADIUS OF CURVE R
TANGENT DISTANCE T
LENGTH OF CURVE L
EXTERNAL DISTANCE E
POINT OF INTERSECTION P. I.
POINT OF CURVE P. C.
POINT OF TANGENT P. T.
POINT ON TANGENT P. O. T.

SCALES

TITLE 1" = 500'
PLAN 1" = 50'
HOR. 1" = 50'
PROFILE VERT. 1" = 10'
CROSS SECTIONS 1" = 5'

DANVILLE E-81-C
ROGER POLKLANDER
1933

RIGHT-OF-WAY DIVISION
TOWN FILE

PERPETUAL
Town of *W-15*
(To Be Returned To R.O.W. Division)

These plans are subject to such revision as may be required by the Bureau of Public Roads or the Commissioner of Highways. Construction is to be carried on in accordance with the Standard Road and Bridge Specifications of 1930 with such revised specifications and special provisions as are submitted with these plans.

RECOMMENDED [Signature] DISTRICT ENGINEER BUREAU OF PUBLIC ROADS
RECOMMENDED FOR APPROVAL [Signature] CHIEF ENGINEER BUREAU OF PUBLIC ROADS
APPROVED [Signature] DIRECTOR - BUREAU OF PUBLIC ROADS

SERIES F. NO. E-81-C FILED
SHEET 1 OF 22

Project No. FE-81-C