

INDEX OF SHEETS

SHEET NO. 1	TITLE PAGE
" 2	TYPICAL CROSS-SECTION OF IMPROVEMENT
" 3	BANKING AND WIDENING TABLES
" 4-6	PLAN AND PROFILE SHEETS
" 7	STANDARD SHEET S20; PIPE CULVERTS
" 8	" " S29; BOX CULVERTS
" 9	" " S30; GUARD RAIL
" 10	" " S31; BOUNDARY MARKERS
" 11	" " S40; BARRICADES, SIGNS & LIGHTS
" 12-16	CROSS-SECTIONS

2" CRUSHED STONE MIXED-IN-PLACE SURFACE COURSE WITH
CUTBACK ASPHALT BINDER & PRIME COAT OF RETINED TAR-ITEM 24A
4" BASE COURSE OF CRUSHED GRAVEL-ITEM 12B (MODIFIED)

STATE OF VERMONT
STATE HIGHWAY DEPARTMENT

PLAN AND PROFILE OF PROPOSED
STATE HIGHWAY

FEDERAL AID PROJECT

TOWN OF WALDEN

Pin # 602272

WALDEN-HARDWICK ROAD-RT 15

FROM A POINT 225 FT. WEST OF THE OVERPASS, NORTHERLY
0.321 MILES TO A POINT 100 FT. SOUTH OF THE RESIDENCE OF
FRANK GRAVES.

FED. ROAD DIST. NO.	STATE	FED. AID PROJ. NO.	FISCAL YEAR	SHEET NO.	TOTAL SHEETS
9	Vt.	31 H	1934	1	16

Standard sheets S28 & S29 approved by the Chief Engineer on July 16, 1933

Standard sheet S30 approved by the Chief Engineer on Aug 15, 1933.

Standard sheet S31 approved by the Chief Engineer on July 25, 1934.

(To Be Returned To R.O.W. Division)

OWN FILE

RIGHT-OF-WAY DIVISION

LENGTH OF PROJECT 1699.7 FT. = 0.321 MILES

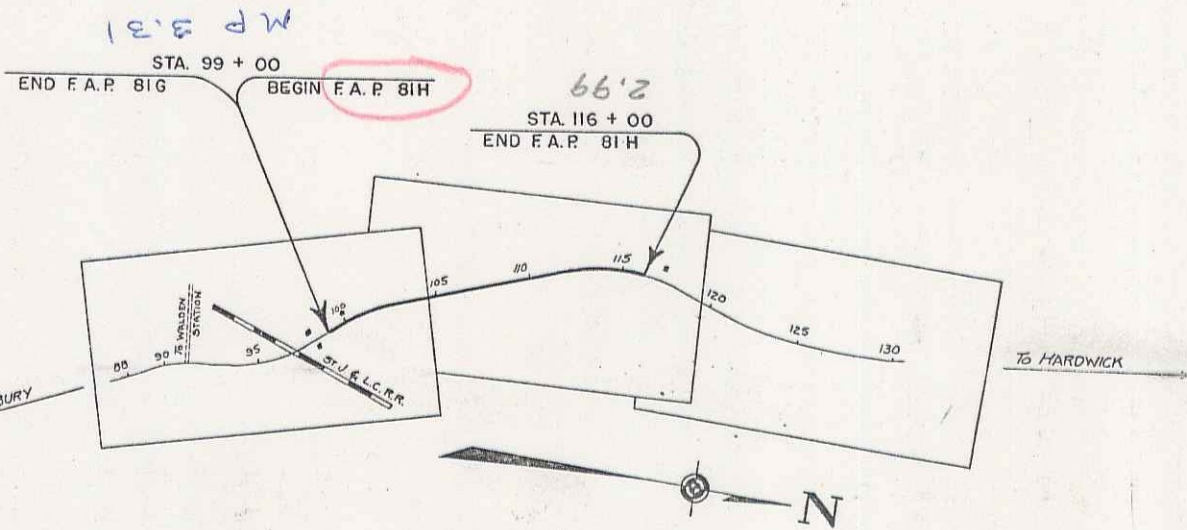
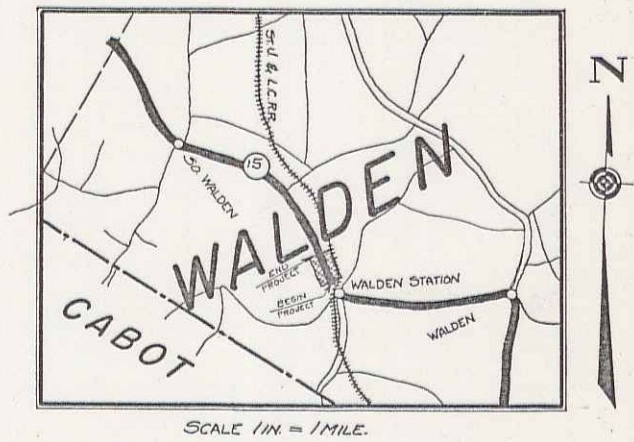

RIGHT-OF-WAY DIVISION
TOWN FILE
PERPETUAL
OWN FILE
(To Be Returned To R.O.W. Division)

APPROVED: *[Signature]*
COMMISSIONER OF HIGHWAYS
SUBMITTED BY ORDER OF THE STATE HIGHWAY BOARD

- CONVENTIONAL SIGNS
- COUNTY LINE
 - TOWN LINE
 - FENCE LINE
 - STONE WALL
 - UNFENCED PROPERTY
 - GUARD RAIL
 - TRAVELED WAY
 - RAILROAD
 - RETAINING WALL
 - CENTER LINE
 - SURVEY LINE
 - CULVERT
 - DROP INLET
 - TROLLEY POLE
 - POWER POLE
 - TELEPHONE POLE
 - TREES
 - HEDGE

- CURVE DATA
- DEFLECTION ANGLE.....Δ
 - DEGREE OF CURVE.....D
 - RADIUS OF CURVE.....R
 - TANGENT DISTANCE.....T
 - LENGTH OF CURVE.....L
 - EXTERNAL DISTANCE.....E
 - POINT OF INTERSECTION.....P.I.
 - POINT OF CURVE.....P.C.
 - POINT OF TANGENT.....P.T.
 - POINT ON TANGENT.....P.O.T.

SCALES

TITLE	1" = 500'
TYPICAL	1" = 2'
PLAN	1" = 50'
PROFILE	1" = 10'
CROSS-SECTIONS	1" = 5'

These plans are subject to such revisions as may be required by the Bureau of Public Roads or the Commissioner of Highways. Construction is to be carried on in accordance with the plans and Standard Road and Bridge Specifications of 1930 including all subsequent approved revisions and such revised specifications and special provisions as are submitted with the plans. Attention of the contractor is called to the fact that the State Highway Board reserves the right to extend this project northerly of the same contract prices and cost of extension not to exceed 25% of the amount of the contract.

RECOMMENDED
DISTRICT ENGINEER BUREAU OF PUBLIC ROADS
RECOMMENDED FOR APPROVAL
CHIEF ENGINEER BUREAU OF PUB. ROADS
APPROVED
DIRECTOR - BUREAU OF PUBLIC ROADS

CORRECT: *[Signature]*
ROAD ENGINEER
SERIES F.A.P. NO. 31 H FILED
SHEET 1 OF 16

2.99 - 3.31