

INDEX OF SHEETS

SHEET NO.	TITLE PAGE
1	TITLE PAGE
2	TYPICAL CROSS-SECTION OF IMPROVEMENT (See General Notes and Surface Course with Culvert)
3	BANKING AND WIDENING TABLES
4-21	PLAN AND PROFILE
22	STD. STRUCTURE SHEET S-28 PIPE CULVERTS
23	" " " S-30A STD. UNDERDRAIN
24	" " " S-31 C.G.M.D.I. A.G. WITH GRATES
25	" " " S-40 BARRICADES, SIGNS, & LIGHTS

Standard Structure Sheets Approved by the
 Civil Engineer
 5-23 July 14, 1939
 5-31 July 25, 1934

FED. ROAD DIST. NO.	STATE	FED. AID PROJ. NO.	SECTION	SHEET NO.	TOTAL SHEETS
0	Vt.	81B(2)	1510	1	25

STATE OF VERMONT
 STATE HIGHWAY DEPARTMENT

PLAN AND PROFILE OF PROPOSED
 STATE HIGHWAY

FEDERAL AID PROJECT

TOWNS OF WALDEN-HARDWICK

WALDEN-HARDWICK ROAD

BEGINNING AT A POINT 3.0 MI. SOUTHEASTERLY OF THE WALDEN-HARDWICK TOWN LINE AND EXTENDING NORTHWESTERLY 4.428 MI. TO A POINT 1.4 MI. NORTHWESTERLY OF THE WALDEN-HARDWICK TOWN LINE

LENGTH OF PROJECT ^{23,379.8} 23,380.6 FEET = 4.428 MILES

Pin# 00R271

Re. UT 15

Project No. FAPSIB(2)

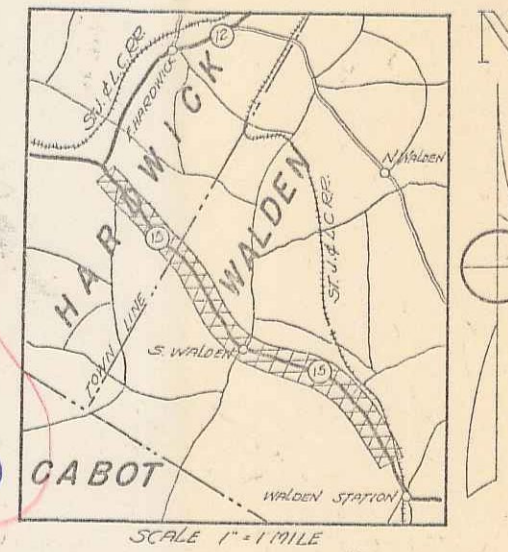

(To Be Returned to R.O.W. Division)
 Town of
 5-15
 PERMANENT
 HIGHWAY DIVISION

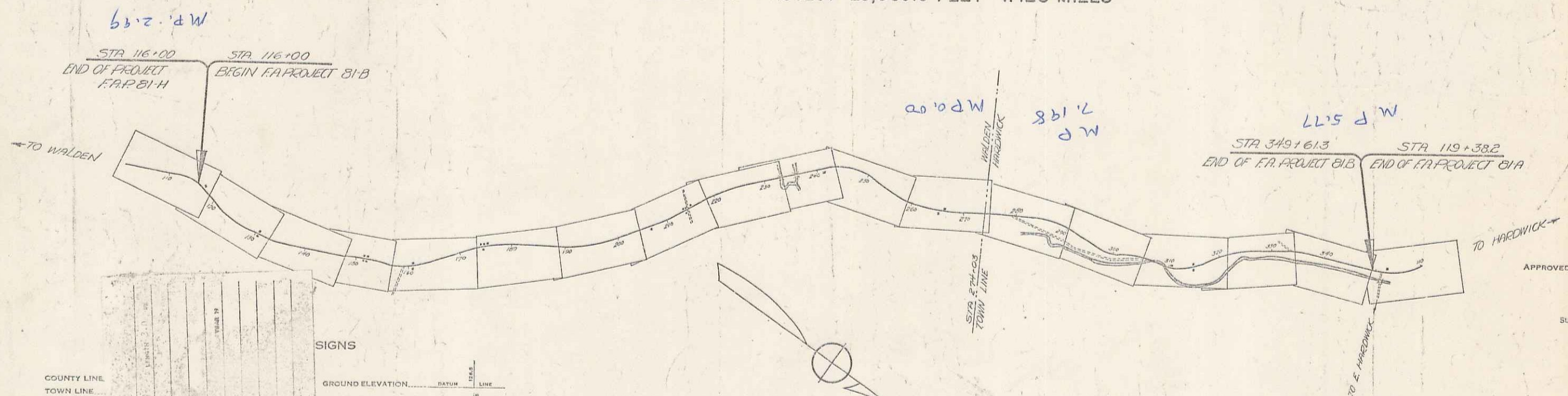

COUNTY LINE
 TOWN LINE
 FENCE LINE
 STONE WALL
 UNFENCED PR
 GUARD RAIL
 TRAVELED WA
 RAILROAD
 RETAINING WA
 CENTER LINE
 SURVEY LINE
 CULVERT
 DROP INLET
 TROLLEY POLE
 POWER POLE
 TELEPHONE PO
 TREES
 HEDGE

SIGNS

SIGN	DATUM	LINE
GROUND ELEVATION	DATUM	LINE
GRADE ELEVATION	DATUM	LINE

CURVE DATA

DEFLECTION ANGLE	Δ
DEGREE OF CURVE	D
RADIUS OF CURVE	R
TANGENT DISTANCE	T
LENGTH OF CURVE	L
EXTERNAL DISTANCE	E
POINT OF INTERSECTION	P.I.
POINT OF CURVE	P.C.
POINT OF TANGENT	P.T.
POINT ON TANGENT	P.O.T.

SCALES

TITLE	1" = 1000'
TYPICAL	1" = 2'
PLAN	1" = 50'
PROFILE	1" = 10'

These plans are subject to such revisions, as may be required by the Public Roads Administration or the Commissioner of Highways. Construction is to be carried on in accordance with the plans and Standard Road and Bridge Specifications of 1936 as approved December 29, 1936 by the Public Roads Administration including all subsequent approved revisions and such revised specifications and special provisions as are submitted with the plans.

APPROVED: *Sept. 16, 1937*
H. E. Sargent
 COMMISSIONER OF HIGHWAYS
 SUBMITTED BY ORDER OF THE STATE HIGHWAY BOARD

RECOMMENDED FOR APPROVAL

DISTRICT ENGINEER
 PUBLIC ROADS ADMINISTRATION
 FEDERAL WORKS AGENCY

APPROVED:

COMMISSIONER OF HIGHWAYS
 PUBLIC ROADS ADMINISTRATION
 FEDERAL WORKS AGENCY

APPROVED: *Sept. 16, 1937*
H. E. Sargent
 COMMISSIONER OF HIGHWAYS

APPROVED: *Sept. 16, 1937*
H. E. Sargent
 COMMISSIONER OF HIGHWAYS

SERIES FAP NO. 81B(2) FILED
 SHEET 1 OF 25

DIST #7 5-1