

WOOD GUARD RAIL REQUIRED
 CULVERT STATION LEFT RIGHT
 289+05 24 21

PLAN
 DATE
 DRAWN BY
 CHECKED BY
 APPROVED BY

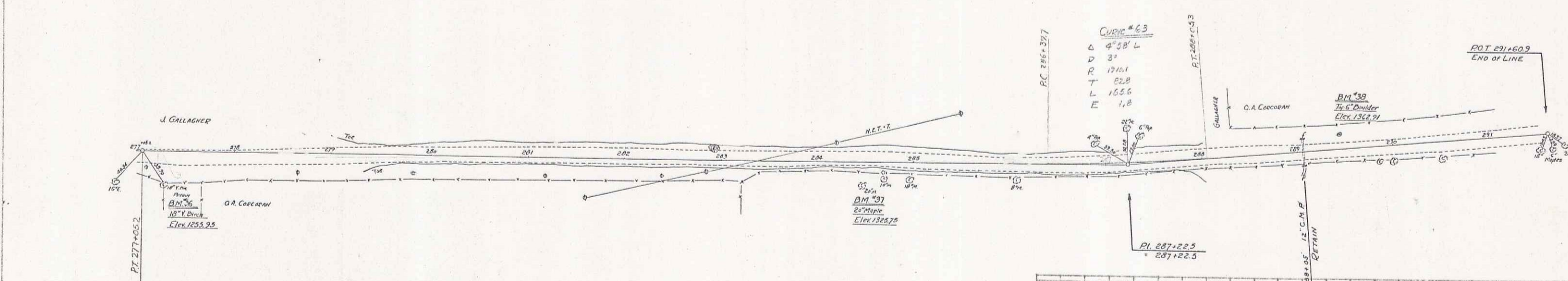

B.M. 36 18" Birch Sta. 277+23 R. Elev. 1255.95 (U.S. B.M.)
 B.M. 37 26" Maple Sta. 284+46 R. Elev. 1325.75
 B.M. 39 Top of Boulder Sta. 289+45 L. Elev. 1362.91

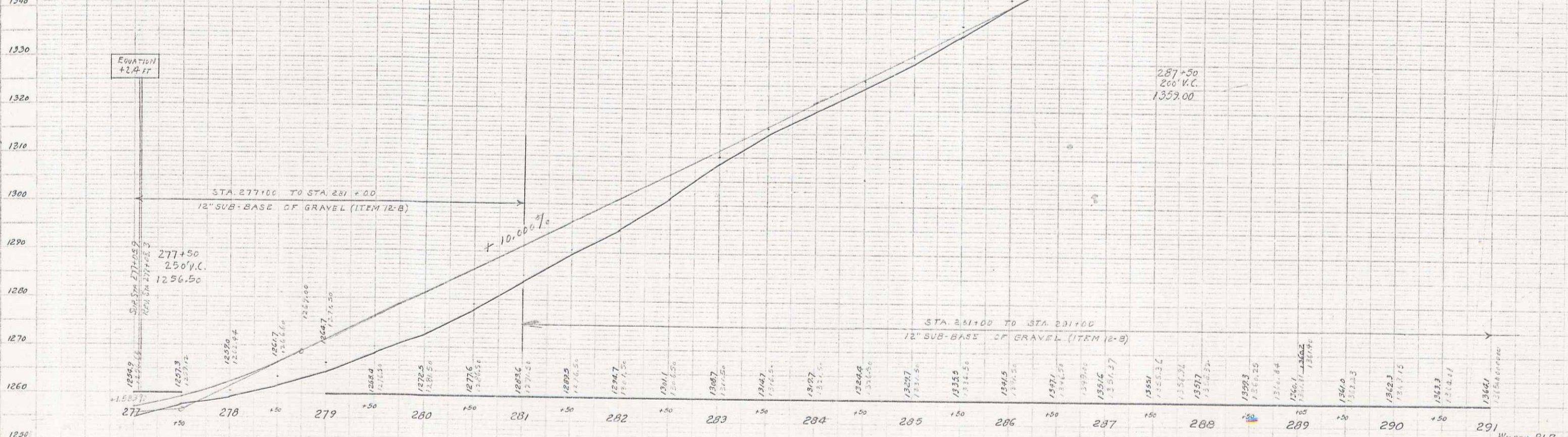

PROFILE
 DATE
 DRAWN BY
 CHECKED BY
 APPROVED BY

WALDEN 81 B
 SHEET 8 OF