

WOOD GUARD RAIL REQUIRED

| CULVERT STATION | LEFT | RIGHT |
|-----------------|------|-------|
| 189+25 | 24' | 24' |
| 193+33 | 24' | 24' |

NEW CORR GALV METAL PIPE CULVERTS REQUIRED

| STATION | SIZE | LENGTH | CONTENT | PILE MASS |
|---------|------|--------|------------|-----------|
| 189+25 | 14" | 32' | 2.5 cu yds | |
| 193+33 | 24" | 36' | 4.0 " | |

STATE ROAD DISTRICT SHEET TOTAL
 1933-1934 YEAR NO. SHEETS
 81-A 1933 16 20

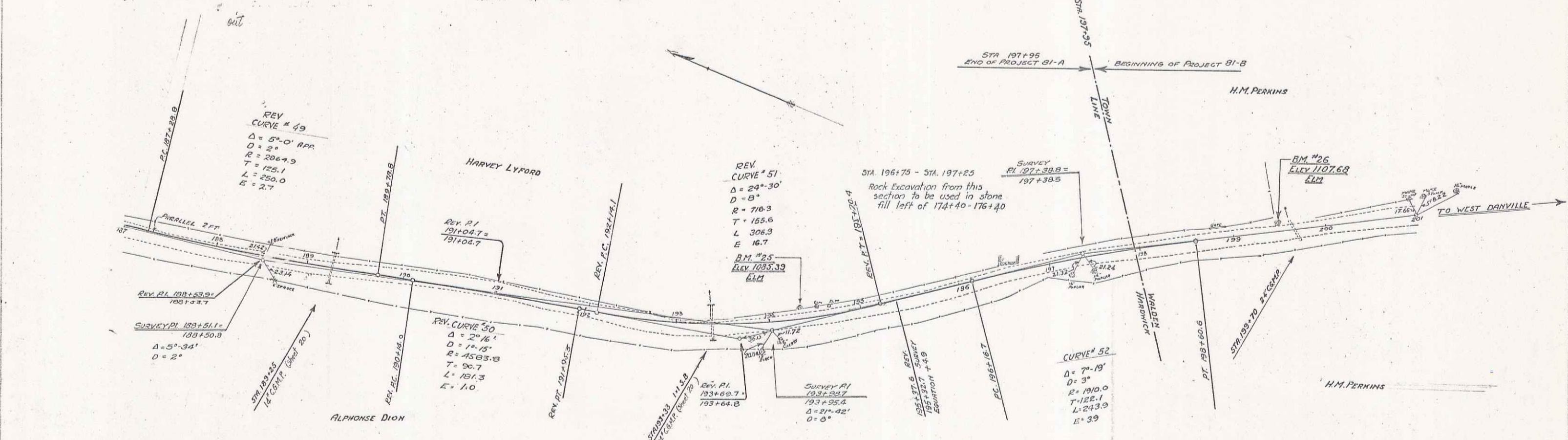

REVISIONS MADE 6-30-30 ACCORDING TO STAKING OUT NOTES

| CURVE #49 | CURVE #50 | CURVE #51 |
|-------------------|---------------------|-------------------|
| P.I. WAS 1801.500 | P.C. WAS 1901.14.7 | P.I. WAS 193169.2 |
| R WAS 2865.0 | ST. WAS 191194.7 | P.C. WAS 192118.6 |
| E WAS 2.8 | A WAS 2^{\circ} 15' | R.T. WAS 195119.9 |
| | R WAS 4330.4 | |
| | T WAS 90.0 | |
| | L WAS 180.0 | |
| | E WAS 0.9 | |

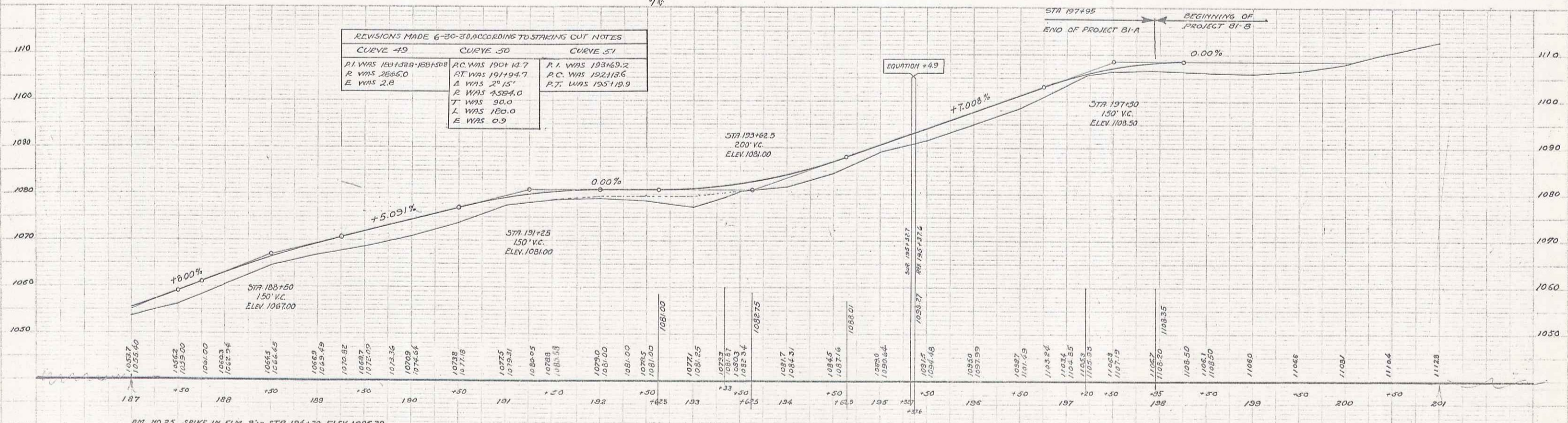

SERIES NO. 81-A
 SHEET 16 OF 29

R16
 24