

INDEX OF SHEETS

SHEET NO. 1	TITLE PAGE
2, 3, 4	TYPICAL CROSS-SECTION OF IMPROVEMENT GRADING, BASE, DRAINAGE & GUARD RAIL WITH BANKING AND WIDENING TABLES
5-23	PLAN AND PROFILE STA. 233+14.75
24	DETAILS OF BOX CULVERT EXTENSION STA. 233+14.75
25	PIPE CULVERTS
26	BOX CULVERTS
26A	BOX CULVERTS
26B	DETAIL OF 5 X 3 R.C. BOX EXTENSION
27	GUARD RAIL
28	BOUNDARY MARKERS
28A	CONCRETE CRIBBING
29	BARRICADES, SIGNS & LIGHTS
30-102	CROSS-SECTIONS

STANDARD STRUCTURE SHEETS APPROVED BY THE CHIEF ENGINEER
 S 28 - JULY 11, 1933
 S 30 - AUG 15, 1933
 S 31 - JULY 25, 1934

STATE OF VERMONT
 STATE HIGHWAY DEPARTMENT

PLAN AND PROFILE OF PROPOSED
 STATE HIGHWAY

FEDERAL AID PROJECT

TOWNS OF WALDEN-HARDWICK

WALDEN-HARDWICK ROAD

BEGINNING AT A POINT 30 MI. SOUTHEASTERLY OF THE WALDEN-HARDWICK TOWN LINE AND EXTENDING NORTHWESTERLY 4.428 MI. TO A POINT 1.4 MI. NORTHWESTERLY OF THE WALDEN-HARDWICK TOWN LINE

LENGTH OF PROJECT 23,380.6 FEET = 4.428 MILES

FED. ROAD DIST. NO.	STATE	FISCAL YEAR	SHEET NO.	TOTAL SHEETS
9	VT.	81-B	1	102

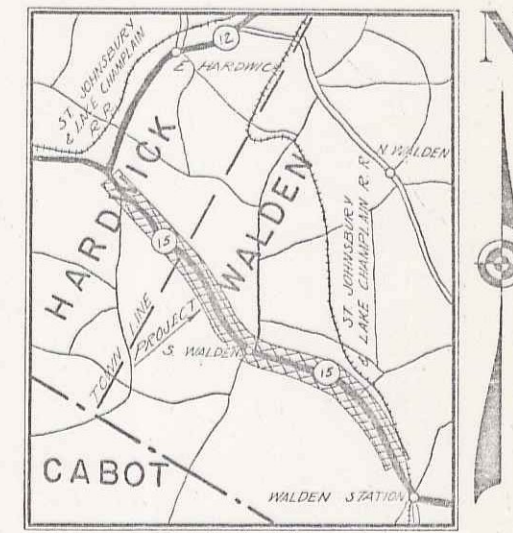

(To Be Returned to R.O.W. Division)
 415
 PERMIT
 RIGHT-OF-WAY DIVISION

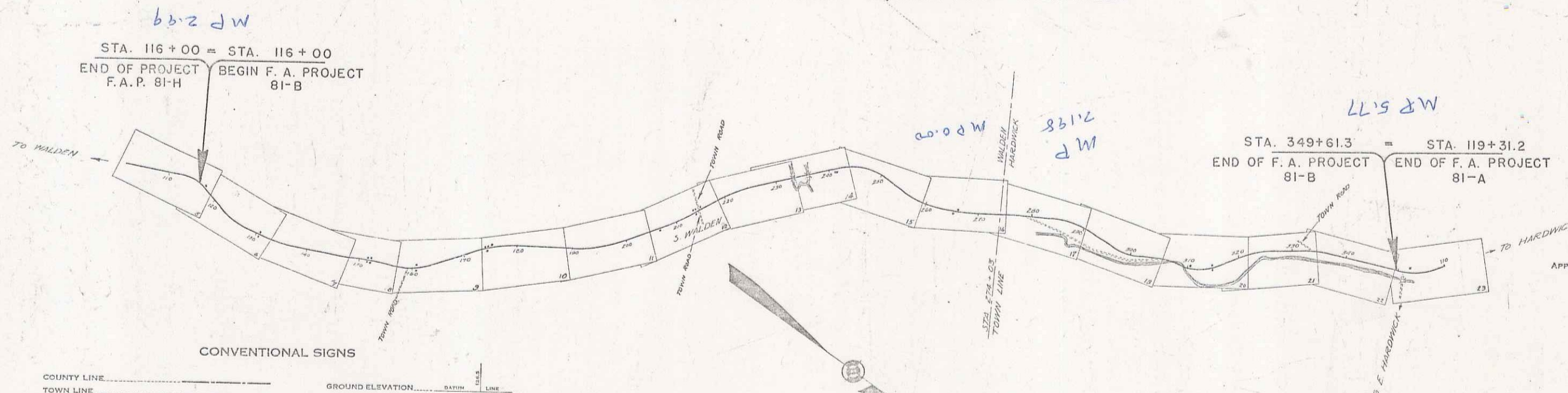

CONVENTIONAL SIGNS

COUNTY LINE	GROUND ELEVATION
TOWN LINE	GRADE ELEVATION
FENCE LINE	
STONE WALL	
UNFENCED PROPERTY	
GUARD RAIL	
TRAVELED WAY	
RAILROAD	
RETAINING WALL	
CENTER LINE	
SURVEY LINE	
CULVERT	
DROP INLET	
TROLLEY POLE	
POWER POLE	
TELEPHONE POLE	
TREES	
HEDGES	

CURVE DATA

DEFLECTION ANGLE	Δ
DEGREE OF CURVE	D
RADIUS OF CURVE	R
TANGENT DISTANCE	T
LENGTH OF CURVE	L
EXTERNAL DISTANCE	E
POINT OF INTERSECTION	P. I.
POINT OF CURVE	P. C.
POINT OF TANGENT	P. T.
POINT ON TANGENT	P. O. T.

SCALES

TITLE	1" = 1000'
TYPICAL	1" = 2'
PLAN	1" = 50'
PROFILE	1" = 10'
CROSS SECTION	1" = 5'

These plans are subject to such revisions as may be required by the Bureau of Public Roads or the Commissioner of Highways.
 Construction is to be carried on in accordance with the plans and Standard Road & Bridge Specifications of 1934, as approved December 29, 1936 by the Bureau of Public Roads, including all subsequent approved revisions and such revised specifications and special provisions as are submitted with the plans.
 Attention of the contractor is called to the fact that the State Highway Board reserves the right to extend this project at the same contract prices, said cost of extension not to exceed 25% of the amount of the contract.

APPROVED: *[Signature]*
 DECEMBER 1, 1936
 COMMISSIONER OF HIGHWAYS
 SUBMITTED BY ORDER OF THE STATE HIGHWAY BOARD

RECOMMENDED: _____
 DISTRICT ENGINEER BUREAU OF PUBLIC ROADS
 RECOMMENDED FOR APPROVAL: _____
 CHIEF ENGINEER BUREAU OF PUBLIC ROADS
 APPROVED: _____
 DIRECTOR - BUREAU OF PUBLIC ROADS

Project No. FAP 81-B
 Rte. VT 15

*PLOT SET INCLUDES
 HISTORICAL SURVEYS
 FOR 81A + 81B

CORRECT _____
 ROAD ENGINEER
 SERIES FAFNO. 81-B FILED
 SHEET 1 OF 102

DIST # 71