

INDEX OF SHEETS

SHEET NO. 1	TITLE PAGE	} ONE COURSE CEMENT CONCRETE PAVEMENT
" 2	TYPICAL CROSS-SECTION OF IMPROVEMENT	
" 3	DRAINAGE AND FINISHING TABLES	} GRADING, BASE AND CULVERT CONSTRUCTION
" 4-5	PLAN AND PROFILE SHEETS	
" 6	STANDARD STRUCTURE SHEET 5-28	PIRE CULVERTS
" 7	" " " " " "	5-30 GUARD END
" 8	" " " " " "	5-31 UNDERPASS
" 8-A	APPROPRIATES, SIGNS AND LIGHTS 5.8-11	
" 9-11	CROSS SECTIONS	

STANDARD SHEET 5-28 SUBMITTED TO THE CHIEF ENGINEER ON MAY 16, 1933.
 STANDARD SHEET 5-30 SUBMITTED TO THE CHIEF ENGINEER ON FEB. 15, 1933.

FED. ROAD DIST. NO.	STATE	PROJECT	FISCAL YEAR	SHEET NO.	TOTAL SHEETS
9	VT.	87-F	1933	1	1

STATE OF VERMONT
 STATE HIGHWAY DEPARTMENT

PLAN AND PROFILE OF PROPOSED
 STATE HIGHWAY
 NATIONAL RECOVERY MUNICIPAL PROJECT

VILLAGE OF HARDWICK *Pin # 000259*
 MILL STREET



FROM A POINT 203 FT. NORTH FROM ALBERT PINARD'S BLACKSMITH SHOP, SOUTHERLY 0.168 MILES TO THE VILLAGE LIMITS
 LENG. OF CONC. PAVE. CONST. = 500.0 FT. = 0.094 MILES
 LENG. OF SUB-BASE CONST. = 343.0 FT. = 0.065 MILES

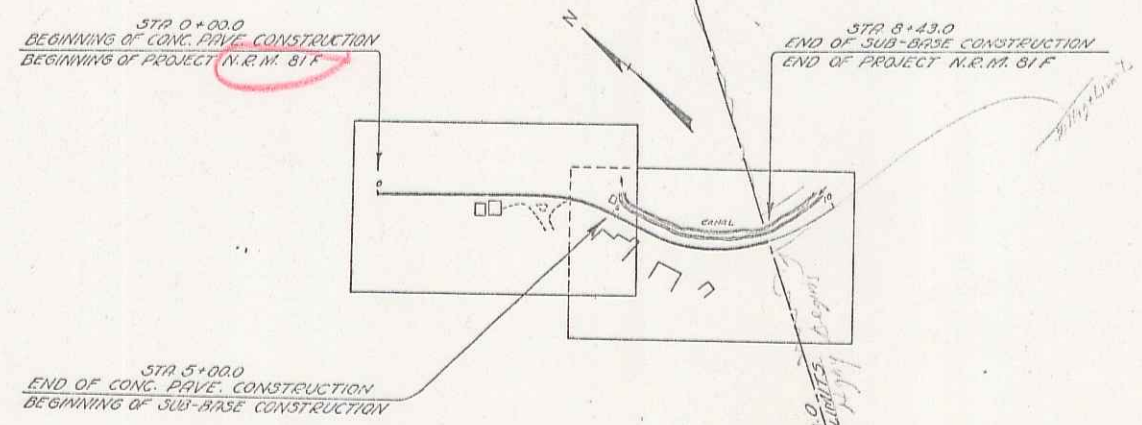

MP 3.65, 3.68
 RIGHT-OF-WAY DIVISION
 TOWN FILE
 PERPETUAL
 Town of 15
 (To Be Returned To R.O.W. Division)
 APPROVED: OCT 28 1933
At E. J. J. J.
 COMMISSIONER OF HIGHWAYS

CONVENTIONAL SIGNS

COUNTY LINE	GROUND ELEVATION	DATE	LINE
TOWN LINE	GRADE ELEVATION	DATE	LINE
FENCE LINE			
STONE WALL			
UNFENCED PROPERTY			
GUARD RAIL			
TRAVELED WAY			
RAILROAD			
RETAINING WALL			
CENTER LINE			
SURVEY LINE			
CULVERT			
DROP INLET			
TROLLEY POLE			
POWER POLE			
TELEPHONE POLE			
TREES			
HEDGE			

CURVE DATA

DEFLECTION ANGLE	Δ
DEGREE OF CURVE	D
RADIUS OF CURVE	R
TANGENT DISTANCE	T
LENGTH OF CURVE	L
EXTERNAL DISTANCE	E
POINT OF INTERSECTION	P. I.
POINT OF CURVE	P. C.
POINT OF TANGENT	P. T.
POINT ON TANGENT	P. O. T.

SCALES

TITLE	1" = 200.0'
PLANS	1" = 50.0'
PROFILE	1" = 10.0'
VERT. SECTIONS	1" = 5.0'

THESE PLANS ARE SUBJECT TO SUCH REVISIONS AS MAY BE REQUIRED BY THE BUREAU OF PUBLIC ROADS OF THE COMMISSIONER OF HIGHWAYS. CONSTRUCTION IS TO BE CARRIED ON IN ACCORDANCE WITH THE STANDARD ROAD AND BRIDGE SPECIFICATIONS OF 1930 WITH ALL SUBSEQUENT APPROVED REVISIONS AND SUCH SPECIFICATIONS AND SPECIAL PROVISIONS AS ARE SUBMITTED WITH THE PLANS.

RECOMMENDED
 DISTRICT ENGINEER
 BUREAU OF PUBLIC ROADS
 RECOMMENDED FOR APPROVAL
 CHIEF ENGINEER
 BUREAU OF PUBLIC ROADS
 APPROVED
 DIRECTOR - BUREAU OF PUBLIC ROADS

CONTRACT 87-F-1 SERIES N.R.M.N.O. 817 FILED
 ROAD ENGINEER SHEET 1 OF 11

Dist. # 7 1