

TOWN OF WOODSTOCK
 Project PWA 1020-2-FD
 Plan # 00R253
 Route VT 100
 Date 1/1/1939

CURVE # 4
 Δ - 17°20' Lt
 D - 173.27
 R - 173.27
 T - 21.84
 L - 433.3
 E - 16.5
 BANK 1/2 PER FT

PWA
 1020 P.F.D. 1939
 ST 23-L

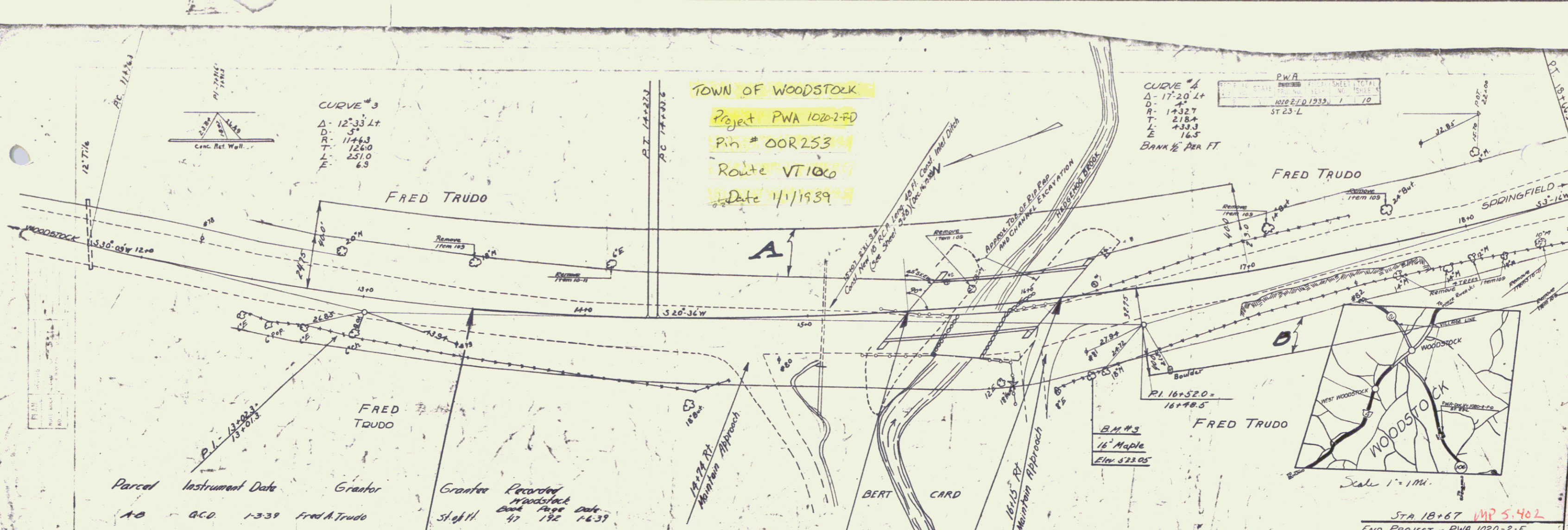

Parcel Instrument Date Grantor
 A-B G.C. 1-339 Fred A. Trudo

Grantor Recorded
 Woodstock
 Date Page Date
 47 192 1637

BRIDGE DATA		
TYPE	OLD	PROPOSED
TYPE	I. BM & BRIDGE I. CM CONC. FLOOR	
CLEAR SPAN	20'	65'
CLEAR HT.	7.5'	7'
WATERWAY	150"	230"
OVERALL		69'
ROADWAY	16.5'	24'

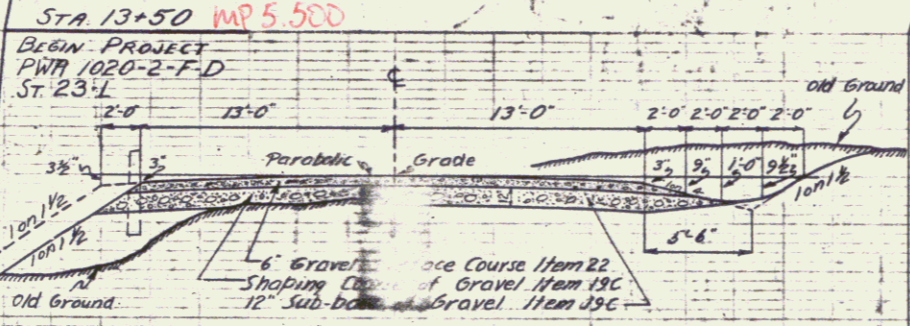

- INDEX OF SHEET NOS.
 1. PLAN & PROFILE
 1A. BANKING & WIDENING TABLES
 2. ABUTMENT DETAILS
 3. SUB 2A - 15" SKEW & BANK 1/2 PER 1'-0"
 4. SB 5C - CURB & RAIL
 5. SB 11 - BARRICADES, LIGHTS & SIGNS
 6. SB 20 - DETAILS C.E.K.L. & GENERAL NOTES
 7. 530 - CABLE GUARD RAIL
 7A 530 - PIPE CHIMNEY
 8-10. CROSS SECTIONS

No.	ESTIMATE OF QUANTITIES	QUANTITY	APPROVED
10	SOLID ROCK EXCAVATION	180 CY	
10-11	COMMON EXCAVATION INCL BORROW	500 CY	
12A	TRENCH EXCAVATION OF EARTH	10 CY	
12B	TRENCH EXCAVATION OF ROCK	5 CY	
15	CHANNEL EXCAVATION	522 CY	
16	STRUCTURE EXCAVATION	187 CY	
18	MAINTENANCE OF TRAFFIC	1 LS.	
19C	SUB-BASE OF GRAVEL	500 CY	
22	GRAVEL SURFACE COURSE	300 CY	
41A	CONCRETE CLASS A	112 CY	
42	REINFORCING STEEL	21,850 LBS.	
43B	STEEL SUPERSTRUCTURE (60,460)	1 LS.	
58	TEMPORARY BRIDGE	7 LS.	
57	REMOVAL OF PRESENT SUPERSTRUCTURE	1 LS.	
60	RIP-RAP FOR BANK PROT. (HEAVY TYPE)	158 CY	
60A	CABLE GUARD RAIL	534 L.F.	
60B	ANCHORS FOR CABLE GUARD RAIL	3 EA.	
109	CUTTING & REMOVING TREES	9 EA.	

PROFILE	CONDITION	NO.	ST. BEG.	ST. END	LENGTH	ML.
1	100% (100% 1000-0-P-D)					
2	100% (100% 1000-0-P-D)					
3	100% (100% 1000-0-P-D)					

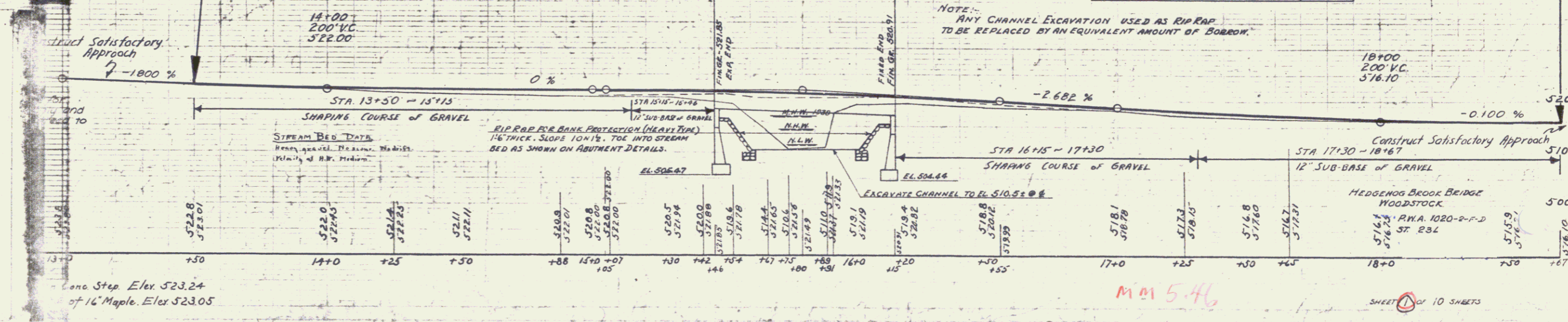

MM 5.46