

33+6	RT	L
33+24	RT	L
Tree Removal Item 109		
170	Pos	110
171.53	LT	110
171.77	LT	110

PARCEL	INSTRUMENT	DATE	GRANTOR	GRANTEE	RECORDED	READING	DATE	REMARKS
#4	A	3-1-49	BYRON DEXTER	ST OF VT.	33	349-350	3-7-49	
#5	A	3-19-49	CARL H. LILLIAN C. NELSON		33	355-378	3-22-49	
#6	A	2-28-49	ELSA AMSDEN		33	353-359	2-28-49	

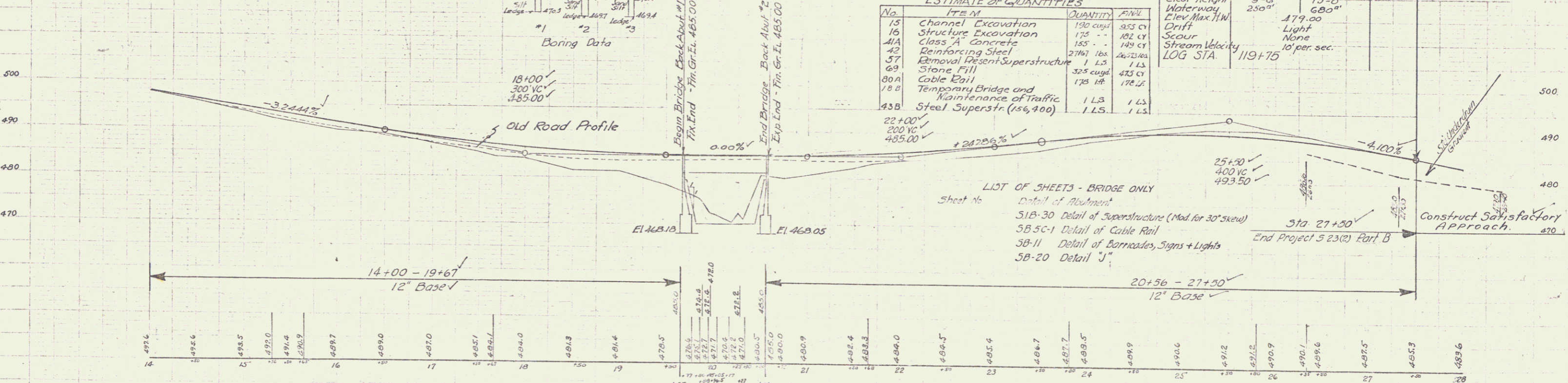
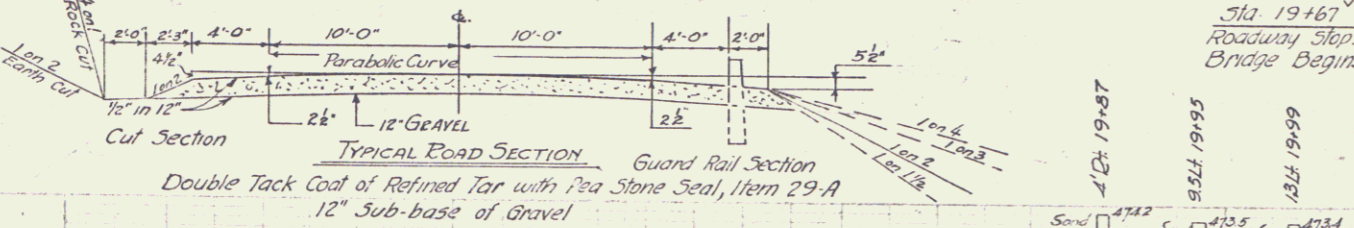
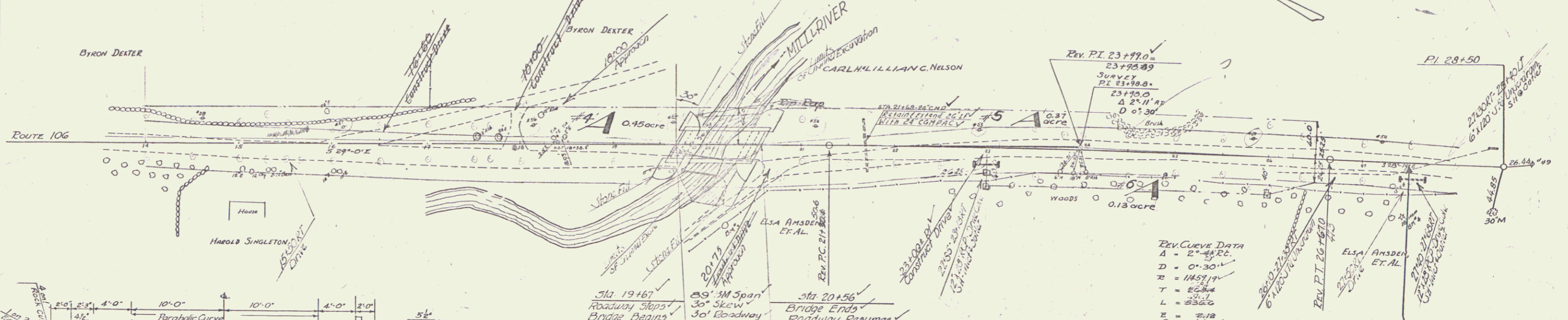

BRIDGE ONLY
ESTIMATE OF QUANTITIES

No.	ITEM	QUANTITY	UNIT
15	Channel Excavation	190 cuyd	953 CY
16	Structure Excavation	175	102 CY
41A	Class "A" Concrete	155	149 CY
42	Reinforcing Steel	2774	2672 lbs
57	Removal Present Superstructure	1	1 LS
69	Stone Fill	325 cuyd	433 CY
80A	Cable Pile	178	178 LF
78B	Temporary Bridge and Maintenance of Traffic	1	1 LS
43B	Steel Superstr (156,400)	1	1 LS

BRIDGE DATA

Type	Present	Proposed
Roadway	15'-0"	30'-0"
Overall Span	33'-0"	39'-0"
Clear Span	29'-6"	24'-4 1/2"
Clear Height	9'-6"	13'-0"
Waterway Elev. Max. H/W	250'	680'
Drift		477.00
Light		None
Scour		None
Stream Velocity		10' per sec.
LOG STA.	119+75	

LIST OF SHEETS - BRIDGE ONLY

Sheet No. Detail of Abutment
 5B-30 Detail of Superstructure (Mod for 30° skew)
 5B-5C-1 Detail of Cable Rail
 5B-11 Detail of Barricades, Signs + Lights
 5B-20 Detail "J"

Reading-Woodstock S-23(2)
 PART B
 ROUTE VT. 106
 LOG STA. 119+75
 Series S No. 23(2)
 Sheet 16 of 62