

CORPS OF ENGINEERS

U.S. ARMY

Three Cable Guard Rail with Steel Posts
54 + 00 Rt. to 56 + 24 Rt.

3/4" Copper Tubing &
Sleeve for Water Pipe
Sta. 64 + 18
(Approximate Station and
actual Locations will be
determined in the field.)

CURVE DATA

$\Delta = 15^\circ - 28' - 00''$ LT.
 $D = 1^\circ - 00' - 00''$
 $R = 3229.65'$
 $T = 727.21'$
 $L = 1946.67'$
 $E = 16.0'$
Bank = 1/4" Per Ft.

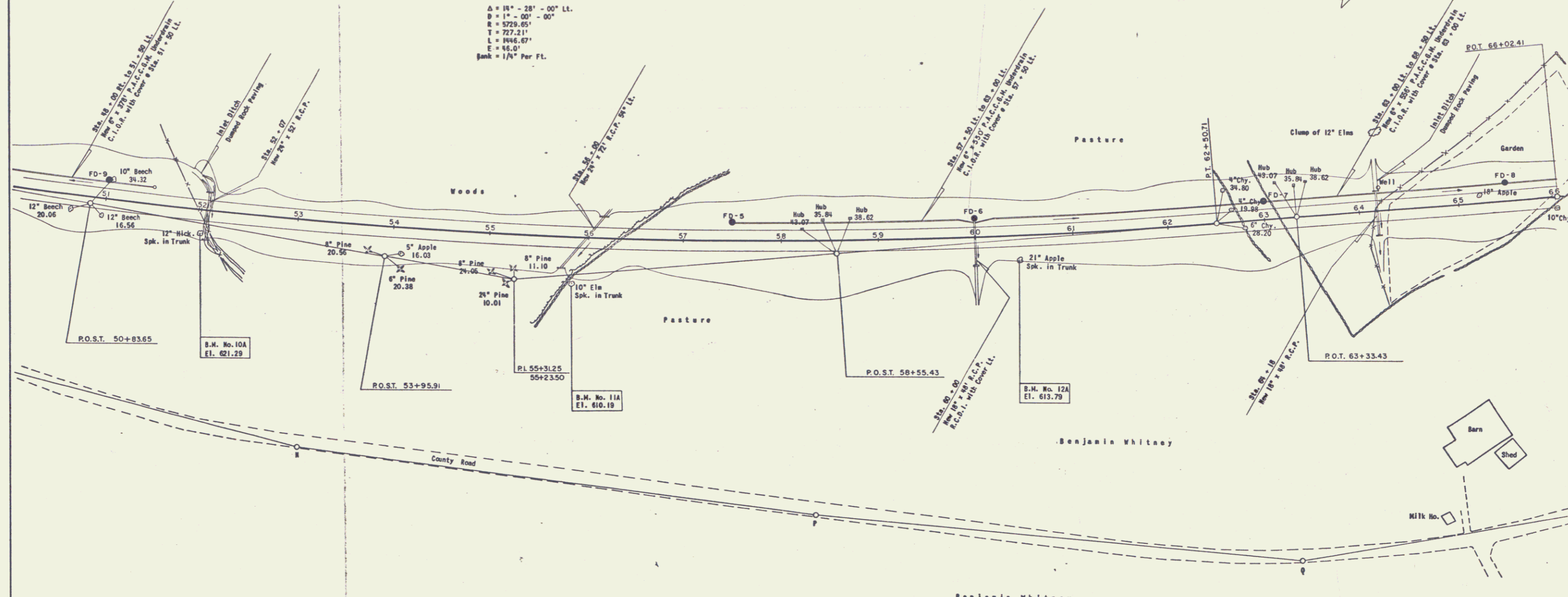

REVISION	DATE	DESCRIPTION	BY

CLARKESON ENGINEERING CO., INC. BOSTON MASS.	CORPS OF ENGINEERS U.S. ARMY OFFICE OF THE DIVISION ENGINEER NEW ENGLAND DIVISION BOSTON MASS.
DRAWN BY: J.N.	CONNECTICUT RIVER FLOOD CONTROL
TRACED BY: F.I.	ROAD RELOCATIONS
CHECKED BY: R.C.A. G.R.I.E.C.	NORTH SPRINGFIELD DAM
APPROVED BY: <i>[Signature]</i>	ROUTE 106 RELOCATION
APPROVED BY: <i>[Signature]</i>	SPRINGFIELD - WEATHERSFIELD
	PLAN, GRADING AND DRAINAGE
	STA. 50 + 50 TO STA. 66 + 00
	VERMONT
	DATE: JULY 1958
	SCALE: 1" = 50'
	DRAWING NUMBER: CT-1-4470
	SHEET 18 OF 99

10