

CORPS OF ENGINEERS

U. S. ARMY

Demolition and Removal of Buildings  
Sta. 39 + 90 Rt.  
Sta. 41 + 70 LL.

Three Cable Guard Rail with Steel Posts  
49+06 Rt. to 51+30 Rt.  
49+55 Lt. to 57+55 Lt.

Plank Guard Rail with Preservative Treatment  
44+25 Rt. to 45+85 Rt.

TO SPRINGFIELD

TO FELCHVILLE

CURVE DATA  
Δ = 43° - 50' - 25" LL.  
D = 5° - 30' - 00"  
R = 1042.14'  
T = 419.37'  
L = 797.10'  
E = 81.21'  
Bank 3/4" Per Ft.

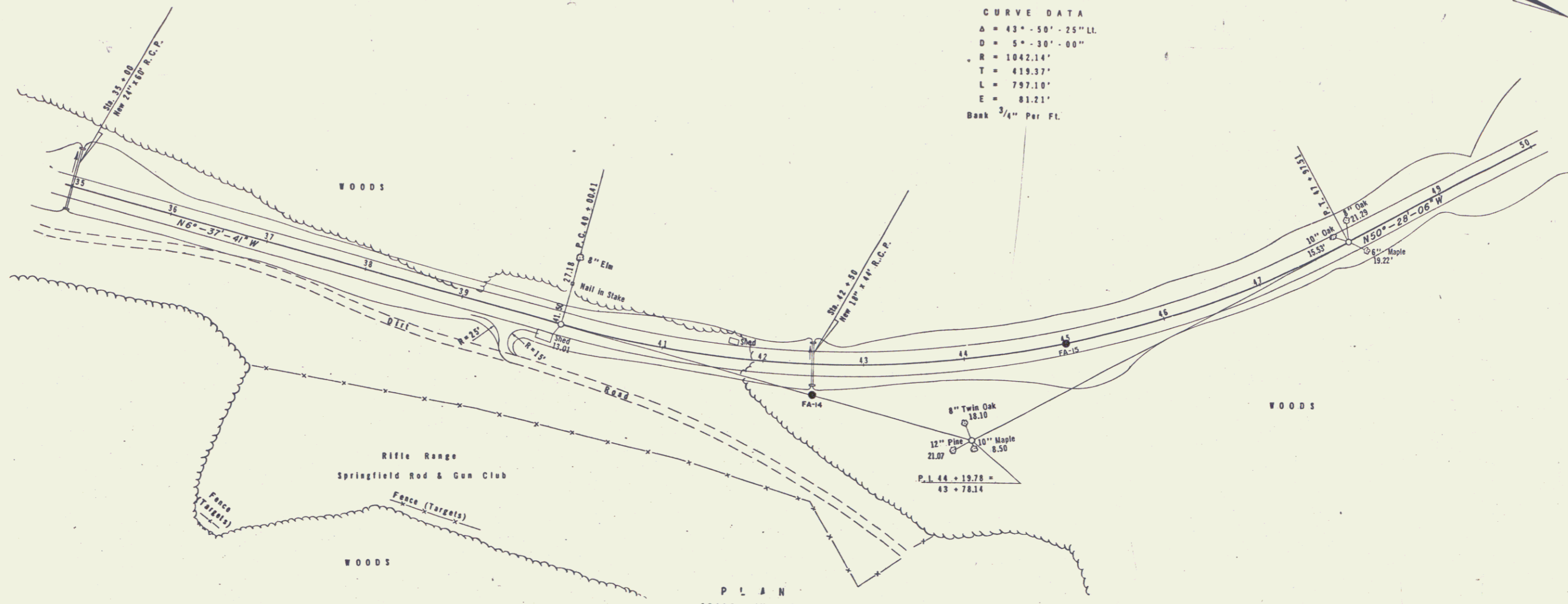

PLAN  
SCALE: 1" = 50'

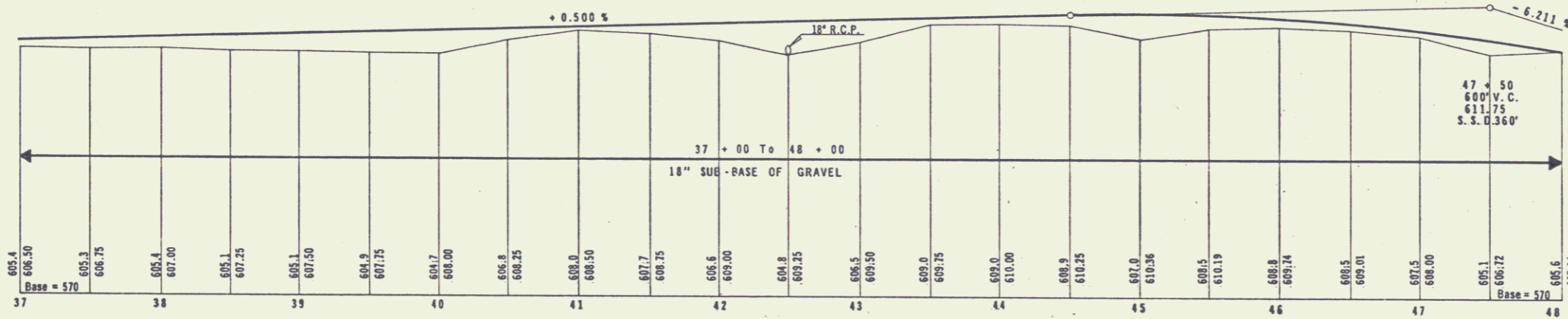

PROFILE  
SCALE  
Vert: 1" = 10'  
Hor: 1" = 50'

T. B. M. #2 R. R. Spike in Root of Stump  
12' Ahead of P.I. 44 + 19.78 Elev. = 608.59

REVISION	DATE	DESCRIPTION	BY

CLARKESON ENGINEERING CO., INC. BOSTON, MASS.	CORPS OF ENGINEERS U.S. ARMY OFFICE OF THE DIVISION ENGINEER NEW ENGLAND DIVISION BOSTON, MASS.
DRAWN BY: R.C.H.	CONNECTICUT RIVER FLOOD CONTROL ROAD RELOCATIONS NORTH SPRINGFIELD DAM
CHECKED BY: F.I.	ROUTE 106 RELOCATION-WEATHERSFIELD PLAN, PROFILE, GRADING AND DRAINAGE
PROJECT NO. R.C.A., G.R., I.E.C.	STA. 37 + 00 TO STA. 48 + 00
APPROVED BY: [Signature]	BLACK RIVER
DATE	JULY 1958
SCALE: AS SHOWN	SPEC. NO. GIVING 19-06-93-5
DRAWING NUMBER	CT-1-4462
SHEET	TO OF 99