

INDEX OF SHEETS

1. Title Sheet
2. Typical Sections
3. Drainage and Item Quantity Sheet
4. Earthwork and Earthwork Summary
- 5-6. R.O.W. Detail Sheets
- 7-8. Plan-Profile Sheets
9. B - 5 Typical Slope Grading 3/10/65 A
10. B - 10 Embankment on a Slope 3/10/65 A
11. B - 13 Drive Intersection 4/5/71 R
12. D - 2 Manholes 3/3/71 A
13. D - 6 R.C.D.I.'s w/Grates 12/2/66 A
14. D - 11 Type A Grates 12/2/69 R
15. E - 32 Road Construction Signs 5/6/71 R
16. E - 31 On-Project Construction Signs 5/6/71 R
17. G - 1 Std. Steel Beam Guard Rail w/ Steel Posts 4/28/70 R
18. J - 1 Project Markers - Boundary Markers 3/10/65 A
19. Blank
- 20-27. Cross Sections

RECORD PLANS MATERIALS

PAVEMENT AREA
4,096 S.Y.

SUBBASE OF GRAVEL—DAVIS-BURKE PIT—WEATHERSFIELD, VT.
TACK COAT TYPE III—MOBIL OIL CO.—ALBANY, N.Y.
GRITS—VERMONT MARBLE—SHELBURNE, VT.
BITUMINOUS CONCRETE PAVEMENT—L.M. PIKE (PLANT 804)—W.LEBANON, N.H.
CONCRETE CLASS B—CHARLESTOWN READY MIX, INC.—CHARLESTOWN, N.H.
REINFORCING STEEL—TUCKER CONST. CORP.—LUDLOW, VT.
METAL CULVERT PIPE & STEEL BEAM GUARD RAIL—NORTHEASTERN CULVERT CORP.—WESTMINSTER, VT.
CAST IRON GRATES—E.L. LEBARON FOUNDRY CO.—BROCKTON, MA.
BOUNDARY & PROJECT MARKERS—HUME PIPE CO.—WINDSOR, VT.
EROSION CONTROL ITEMS—TUCKER CONST. CORP.—LUDLOW, VT.

CONTRACTOR
TUCKER CONSTRUCTION CORP.
LUDLOW, VT.
RES. ENG.—STEPHEN H. LANGILL.
RECORD PLANS—S. H. LANGILL.

CONTRACT
DATED—JANUARY 3, 1972.
STARTED—APRIL 11, 1972.
COMPLETED—JULY 22, 1972.
ACCEPTED—JULY 22, 1972.

STATE OF VERMONT
DEPARTMENT OF HIGHWAYS
Proposed Improvement

TOWNS OF
WEATHERSFIELD - CAVENDISH
COUNTY OF WINDSOR
VERMONT ROUTE 106
SPRINGFIELD - WOODSTOCK ROAD

BEGINNING 78 FEET SOUTH OF THE WEATHERSFIELD - CAVENDISH TOWN LINE
AND EXTENDING NORTHERLY 0.317 MILE.

1969 ADT	= 1290
1989 ADT	= 2250
1989 DHV	= 340
D	= 53%
T	= 5%
V	= 50 MPH

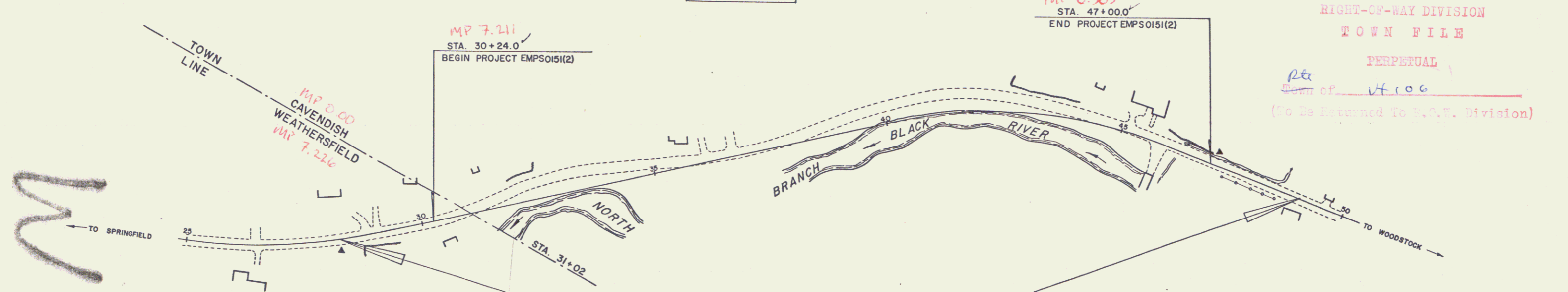
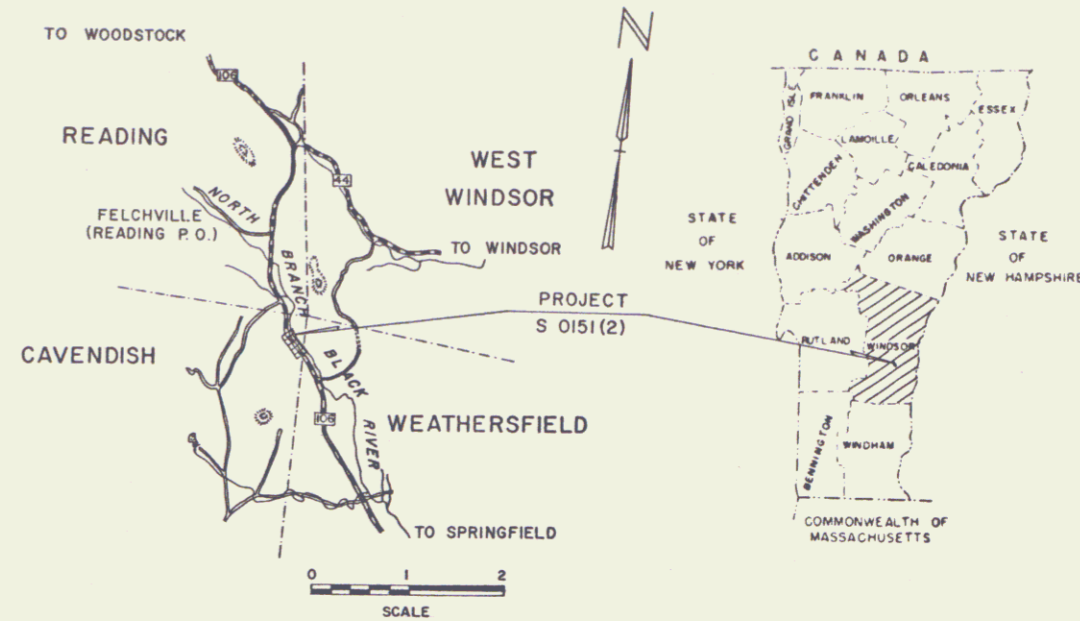

CONVENTIONAL SIGNS

POINT OF ACCESS	X
LIMITS OF ACCESS	---
COUNTY LINE	---
TOWN LINE	---
FENCE LINE	---
STONE WALL	---
UNFENCED PROPERTY	---
GUARD RAIL	---
TRAVELED WAY	---
RAILROAD	---
RETAINING WALL	---
CENTER LINE	---
SURVEY LINE	---
CULVERT	---
DROP INLET	---
TROLLEY POLE	---
POWER POLE	---
TELEPHONE POLE	---
TREES	---
HEDGE	---
F.A. CONSTRUCTION IDENTIFICATION SIGNS	---

WEATHERSFIELD-CAVENDISH—EMP S 0151(2)
CONTRACTOR—TUCKER CONST. CORP.
LUDLOW, VT.
CONST. COMP.—JULY 22, 1972.

GROUND ELEVATION	---
GRADE ELEVATION	---
CURVE DATA	---
DEFLECTION OF ANGLE	Δ
DEGREE OF CURVE	D
RADIUS OF CURVE	R
TANGENT DISTANCE	T
LENGTH OF CURVE	L
EXTERNAL DISTANCE	E
POINT OF INTERSECTION	P.I.
POINT OF CURVE	P.C.
POINT OF TANGENT	P.T.
POINT ON TANGENT	P.O.T.
POINT ON SUB-TANGENT	P.O.S.T.
R.O.W. LIMITS	---

FOR RIGHT OF WAY DETAILS,
SEE RIGHT OF WAY PLANS FOR THIS PROJECT.

CONSTRUCTION AREA
28+24 - 49+00

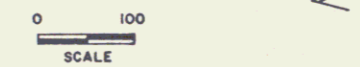

MP 0.303
STA. 47+00.0
END PROJECT EMP S 0151(2)

RIGHT-OF-WAY DIVISION
TOWN FILE
PERPETUAL
Pin # 00R240
(To Be Returned To E.O.T. Division)

THESE PLANS ARE SUBJECT TO SUCH REVISIONS AS MAY BE
REQUIRED BY THE FEDERAL HIGHWAY ADMINISTRATION OR THE CHIEF
ENGINEER.
CONSTRUCTION IS TO BE CARRIED ON IN ACCORDANCE WITH
THESE PLANS AND THE STANDARD SPECIFICATIONS FOR HIGHWAY AND BRIDGE
CONSTRUCTION DATED APRIL, 1964, AS APPROVED BY THE BUREAU OF
PUBLIC ROADS ON OCTOBER 12, 1964, INCLUDING ALL SUBSEQUENT
APPROVED REVISIONS AND SUCH REVISED SPECIFICATIONS AND SPECIAL
PROVISIONS AS ARE INCORPORATED IN THESE PLANS.

DEPARTMENT OF TRANSPORTATION
FEDERAL HIGHWAY ADMINISTRATION

APPROVED _____ DATE _____
DIVISION ENGINEER

PROJECT EMP S NO. 0151(2)
SHEET 1 OF SHEETS 27

APPROVED *R.H. Arnold*
DATE 5/4/70
SUBMITTED BY ORDER OF THE STATE HIGHWAY BOARD