

Three Cable Guard Rail With Steel Posts  
Item 543  
STA 270+00 TO STA 275+00 LT  
269+80 - 276+00 LT  
273+40 - 276+00 RT

Construct Drive  
266+60 LT  
277+00 RT  
273+20 RT

CONSTRUCT SPECIAL DITCH  
274+25 RT - 275+25 RT  
273+75 RT - 276+00 RT  
274+00 LT - 276+00 LT

PUB. NO.	STATE	FED. AID PROJECT	FISCAL YEAR	SHEET TOTAL
1	VT	F 53 (C)	1954	22 136

#26 J LESLIE & G GRACE GIDDINGS  
(A.4.23) STA 258+00 - 269+37.2  
CULVERT RIGHTS STA 258+00 - 266+00  
W.D.O.E. 11/27/56  
RECORDED: SPRINGFIELD BK 56 PG 241,242 12/12/56

#27-A HARRY F & ERLA H OLNEY  
(A.4.71) STA 269+03 - 283+56  
W.D.O.E. 11/27/56  
RECORDED: SPRINGFIELD BK 56 PG 252 1/4/57

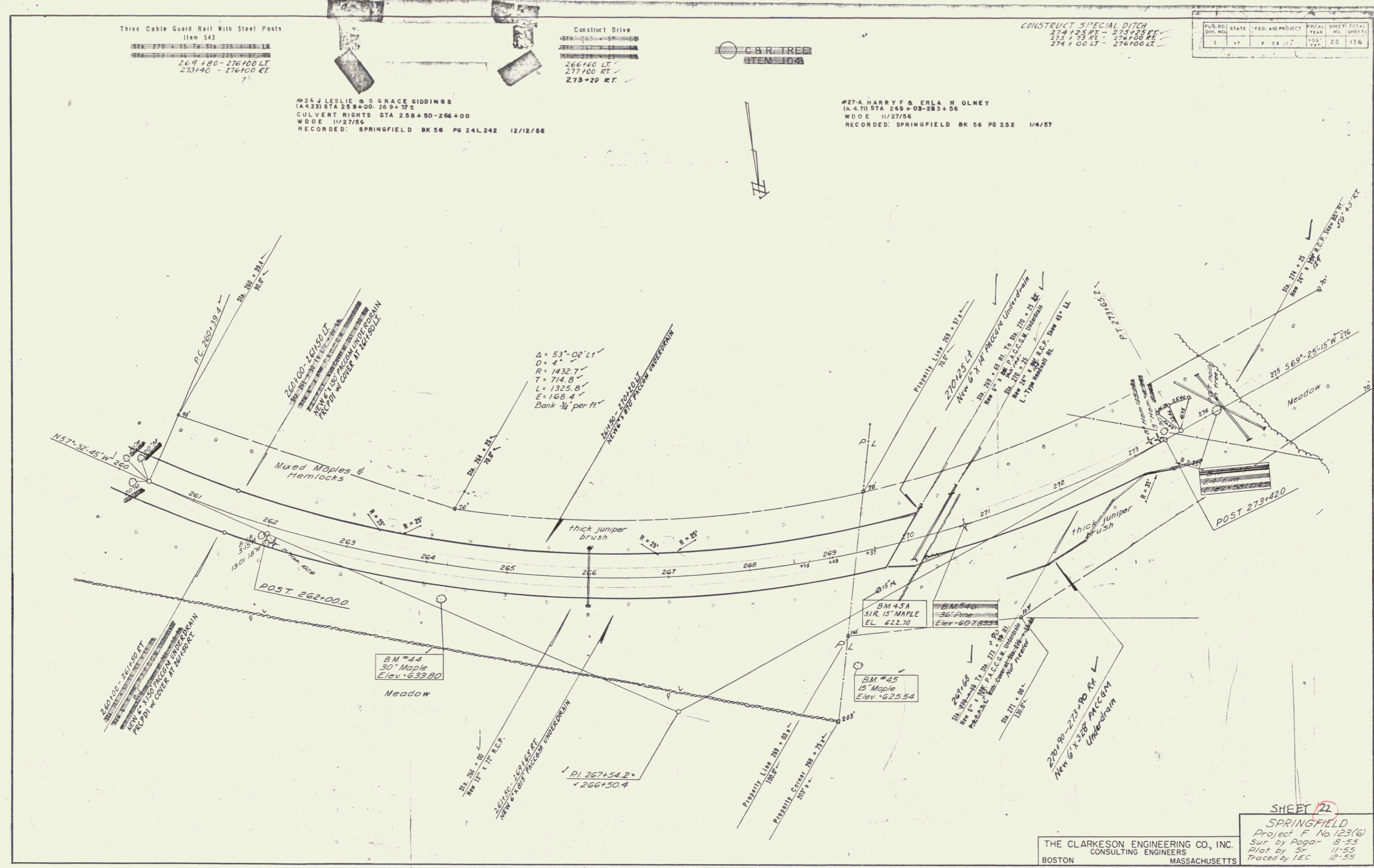

THE CLARKSON ENGINEERING CO., INC.  
BOSTON CONSULTING ENGINEERS MASSACHUSETTS

SHEET 22  
SPRINGFIELD  
Project F No 123(G)  
Sur by Pogor 8-55  
Plat by SF 11-55  
Traced by IEC 12-55