

FORMERLY PARCEL 17B ERVIN & GRACE B. OLNEY ACQUIRED
BY W.D. DATED NOVEMBER 27, 1956. REC. DECEMBER 12, 1956
IN BK. 56 PG. 236 IN THE SPRINGFIELD LAND RECORDS.

BARTLEY, LEONARD M. & MARJORIE J.

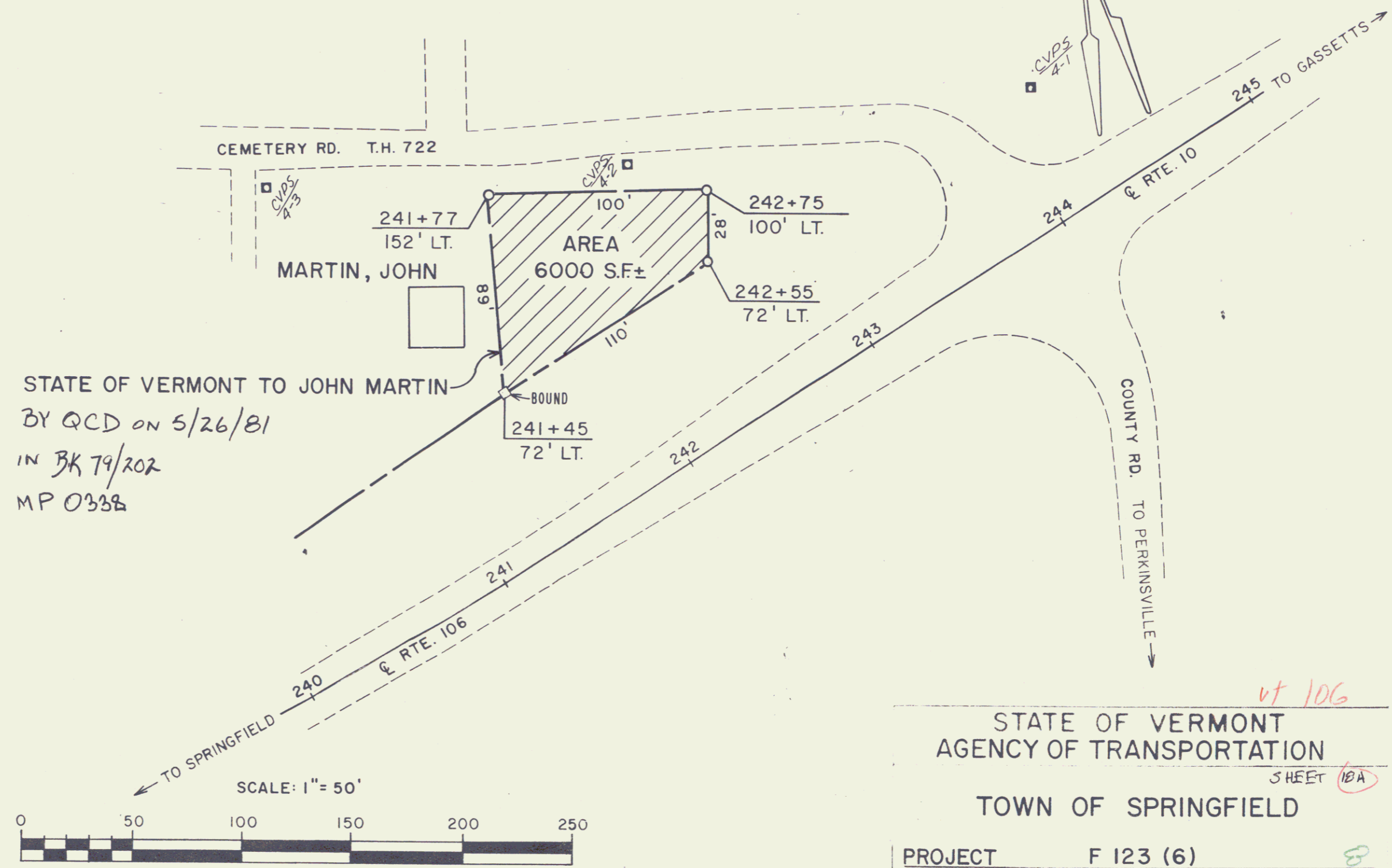

STATE OF VERMONT
AGENCY OF TRANSPORTATION

SHEET 10A

TOWN OF SPRINGFIELD

PROJECT F 123 (6)

SCALE 50'	DATE 5/5/81	DRAWN BY B.A.M.
-----------	-------------	-----------------

122