

INDEX OF SHEETS

SHEET NO. 1	TITLE PAGE
2	TYPICAL CROSS-SECTION OF IMPROVEMENT (GRADING, DRAINAGE AND BASE CONSTRUCTION)
3	BANKING AND WIDENING TABLES
4-5	PLAN AND PROFILE SHEETS
6	STANDARD STRUCTURE SHEET 5-20 PIPE CULVERTS
7	BARRICADES, SIGNS, & LIGHTS 5B-11
8-10	CROSS SECTIONS
10A	STD. STRUCTURE SHEET 5-22 STD. UNDERDRAINS

FED. ROAD DIST. NO.	STATE	FED. AID PROJ. NO.	FISCAL YEAR	SHEET NO.	TOTAL SHEETS
9	VT.	E-137-A	1932	1	10

STATE OF VERMONT
STATE HIGHWAY DEPARTMENT

PLAN AND PROFILE OF PROPOSED
STATE HIGHWAY

FEDERAL AID PROJECT

TOWN OF RICHFORD

RICHFORD-EAST RICHFORD ROAD

FROM 3900 FEET NORTH OF CANADIAN PACIFIC RAILWAY
UNDERPASS NORTHERLY 1300 FEET TO A POINT
2577 FEET SOUTH OF THE LUCAS BROOK BRIDGE
LENGTH OF PROJECT: 1300 FEET = .246 MILE

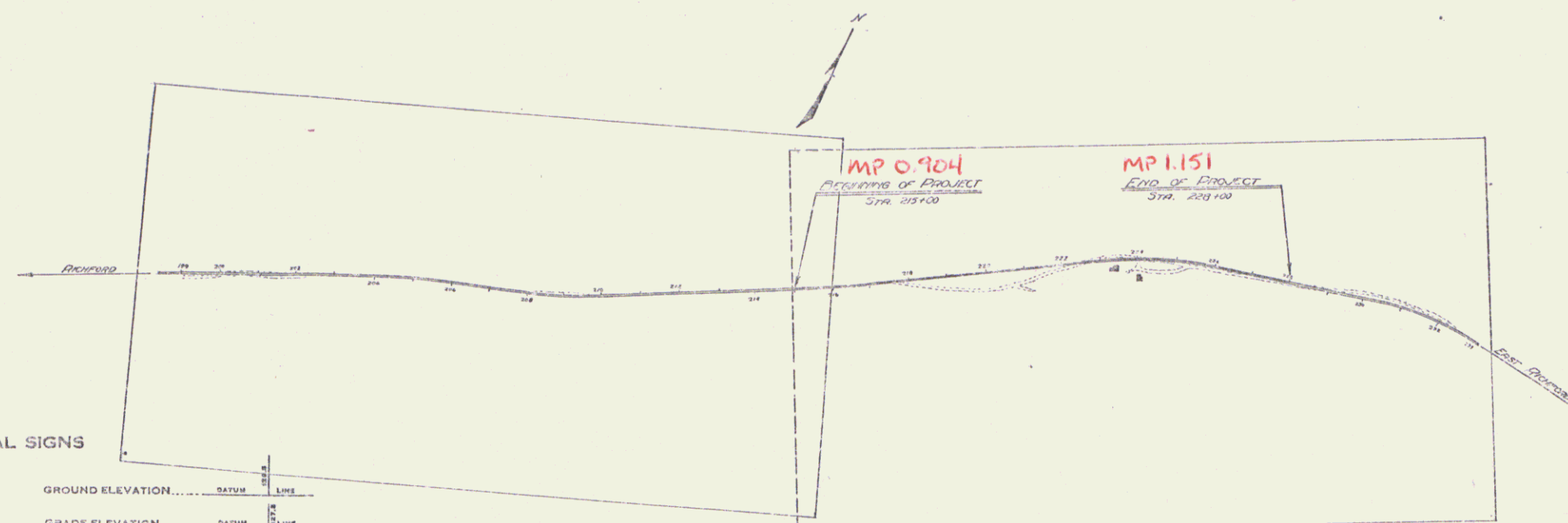
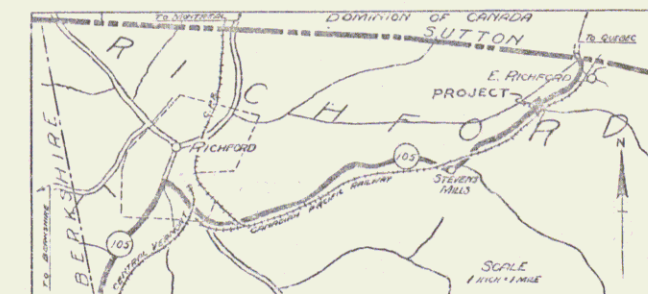

CONVENTIONAL SIGNS

- COUNTY LINE
- TOWN LINE
- PEACE LINE
- STONE WALL
- UNFENCED PROPERTY
- GUARD RAIL
- TRAVELD WAY
- RAILROAD
- RETAINING WALL
- CENTER LINE
- SURVEY LINE
- CULVERT
- DROP INLET
- DRISLEY POLE
- POWER POLE
- TELEPHONE POLE
- TREES
- HEDGE

GROUND ELEVATION DATUM LINE

GRADE ELEVATION DATUM LINE

CURVE DATA

- DEFLECTION ANGLE Δ
- DEGREE OF CURVE D
- RADIUS OF CURVE R
- TANGENT DISTANCE T
- LENGTH OF CURVE L
- EXTERNAL DISTANCE E
- POINT OF INTERSECTION P. I.
- POINT OF CURVE P. C.
- POINT OF TANGENT P. T.
- POINT ON TANGENT P. O. T.

SCALE
TITLE: "1"=200'
PLAN: "1"=50'
PROFILE: 1"=10'
CROSS SECTIONS: "1"=5'

These plans are subject to such revisions as may be required by the Bureau of Public Roads, or the Commissioner of Highways. Construction is to be carried on in accordance with the Standard Road and Bridge Specifications of 1930 with such revised specifications and special provisions as are submitted with these plans.

RIGHT-OF-WAY DIVISION
TOWN FILE
PERPETUAL
Town of UT 105A
(To Be Returned To R.O.W. Division)

APPROVED: Sept. 15, 1932
W. S. [Signature]
COMMISSIONER OF HIGHWAYS

Pin # 00R220
Route VT 105A

RECOMMENDED FOR APPROVAL: [Signature]
DISTRICT ENGINEER BUREAU OF PUBLIC ROADS

RECOMMENDED FOR APPROVAL: [Signature]
CHIEF ENGINEER BUREAU OF PUBLIC ROADS

APPROVED: [Signature]
DIRECTOR BUREAU OF PUBLIC ROADS

DESIGNED: Sept. 15, 1932 SERIES: NO. 137A FILED
SHEET 1 OF 10

