

CURVES REVISED AS PER STAKING UNIT DATA OF JUNE 3, 1933

PI	217+400	222+210
PC	218+216	222+468
PT	220+583	225+948
Δ	341'14"	1702'48"
D	0°30'	5°
R	11459.2	1758
T	318.8	3680
L	636.7	13.3
E	4.4	

PARCEL	INSTRUMENT	DATE	GRANTOR	GRANTEE	RECORDED BOOK	RECORDED PAGE	RECORDED DATE	REMARKS
A	G.C.O.	12-12-32	W & BERNA BLAIR	ST. OF FT.	37	16	12-12-32	

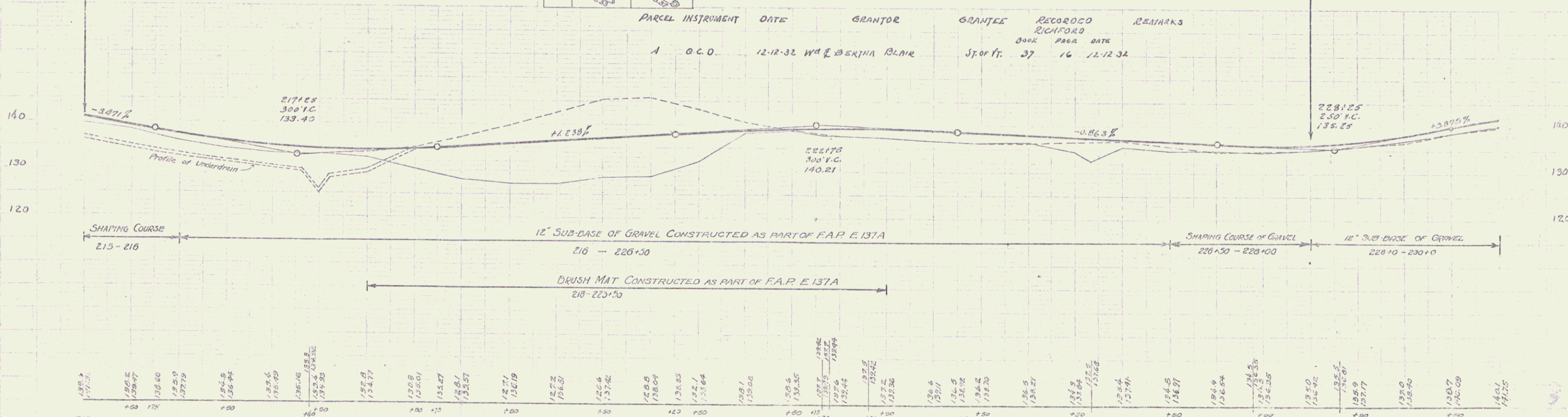

STATION	ELEVATION	STATION	ELEVATION	STATION	ELEVATION	STATION	ELEVATION	STATION	ELEVATION	STATION	ELEVATION	STATION	ELEVATION	STATION	ELEVATION
215	141.5	216	138.47	217	138.40	218	138.40	219	138.40	220	138.40	221	138.40	222	138.40
223	138.40	224	138.40	225	138.40	226	138.40	227	138.40	228	138.40	229	138.40	230	138.40