

STA 233+77 - STA 254+62.3  
**CONCRETE TEE BEAM BRIDGE**  
 (2 SPANS)  
 LENGTH OVERALL 218.5 FT  
 CLEAR SPAN 81.3 -  
 ROADWAY WIDTH 20.0 -  
 CONSTRUCTED IN 1930 - P.S.C. #1595  
 IN GOOD CONDITION - RETAIN

257.65  
 157.58  
 142.07  
 204.14

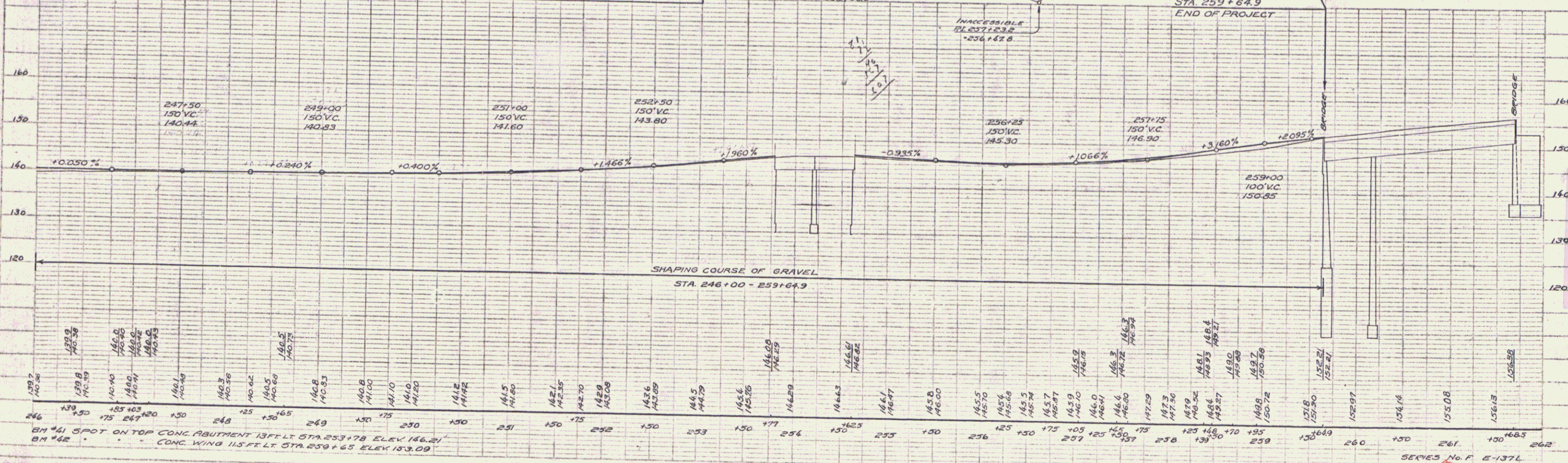

PLAN  
 DATE 1932  
 DRAWN BY  
 CHECKED BY

PROFILE  
 DATE 1932  
 DRAWN BY  
 CHECKED BY