

INDEX OF SHEETS

SHEET NO.	TITLE PAGE
1	TITLE PAGE
2	TYPICAL CROSS-SECTION OF IMPROVEMENT (2 1/2" CRUSHED GRAVEL MIXED IN PLACE SURFACE)
3	BANKING AND WIDENING TABLES (COURSE WITH REFINED TAR. ITEMS 25 & 30)
4	PLAN AND PROFILE STA.
5	STANDARD STRUCTURE SHEET 3-28 PIPE CULVERTS
6	STANDARD STRUCTURE SHEET 3-30 GUARD RAIL
7	STANDARD STRUCTURE SHEET 3-30A F.A. MARKERS
8	STANDARD STRUCTURE SHEET 3-40 SIGNS, LIGHTS, & BARRICADES
9	STANDARD STRUCTURE SHEET 3-41 ROUNDING OF SLOPES
10-11	CROSS SECTIONS

STANDARD STRUCTURE SHEETS  
 APPROVED BY THE CHIEF ENGINEER  
 3-28 JULY 11, 1933  
 3-30 AUG. 15, 1934

(To Be Returned To H.O.W. Division)

RIGHT-OF-WAY DIVISION  
 TOWN FILE  
 PERPETUAL  
 Town of W. H. O. S.

These plans are subject to such revisions as may be required by the Bureau of Public Roads or the Comm. of Highways. Construction is to be carried on in accordance with the plans & Standard Road & Bridge Specifications of 1936 as approved Dec 29, 1936 by the Bureau of Public Roads including all subsequent approved revisions & such revised specifications & special provisions as are submitted with the plans.

STATE OF VERMONT  
 STATE HIGHWAY DEPARTMENT

PLAN AND PROFILE OF PROPOSED  
 STATE HIGHWAY

FEDERAL AID PROJECT

TOWN OF CHARLESTON Pin# 00R209

BRIGHTON—CHARLESTON ROAD

BEGINNING AT A POINT 1.728 MI. N. WESTERLY FROM THE BRIGHTON—CHARLESTON TOWN LINE & EXTENDING 0.157 MI. N. WESTERLY.

FED. ROAD DIST. NO.	STATE	FED. AID PROJ. NO.	FISCAL YEAR	SHEET NO.	TOTAL SHEETS
9	VT.	207	1939	1	11

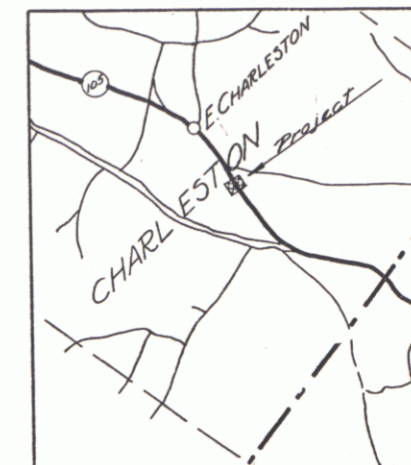

LENGTH OF PROJECT 727.8 FT. = 0.137 MI.

RECORD PLANS

RIGHT-OF-WAY DIVISION  
 TOWN FILE

PERPETUAL  
 Town of W. H. O. S.  
 (To Be Returned To H.O.W. Division)

APPROVED: April 30, 1938

COMMISSIONER OF HIGHWAYS  
 SUBMITTED BY ORDER OF THE STATE HIGHWAY BOARD

NOTE: ANY FURTHER INFORMATION CONCERNING FIGS., QUANTITIES, MEASURES OR OTHER DETAILS RELATIVE TO THIS PROJECT MAY BE FOUND IN EITHER THE FIELD BOOKS OR THE ESTIMATE FILE.

SCALES

Plan	1" = 100'
Profile	1" = 2'
Plan	1" = 50'
Profile	Hor. 1" = 50'
	Ver. 1" = 10'
X Sections	1" = 5'

CONVENTIONAL SIGNS

COUNTY LINE	GROUND ELEVATION	DATUM	LINE
TOWN LINE	GRADE ELEVATION	DATUM	LINE
FENCE LINE			
STONE WALL			
UNFENCED PROPERTY			
GUARD RAIL			
TRAVELED WAY			
RAILROAD			
RETAINING WALL			
CENTER LINE			
SURVEY LINE			
CULVERT			
DROP INLET			
TROLLEY POLE			
POWER POLE			
TELEPHONE POLE			
TREES			
HEDGE			

CURVE DATA

DEFLECTION ANGLE	Δ
DEGREE OF CURVE	D
RADIUS OF CURVE	R
TANGENT DISTANCE	T
LENGTH OF CURVE	L
EXTERNAL DISTANCE	E
POINT OF INTERSECTION	P. I.
POINT OF CURVE	P. C.
POINT OF TANGENT	P. T.
POINT ON TANGENT	P. O. T.

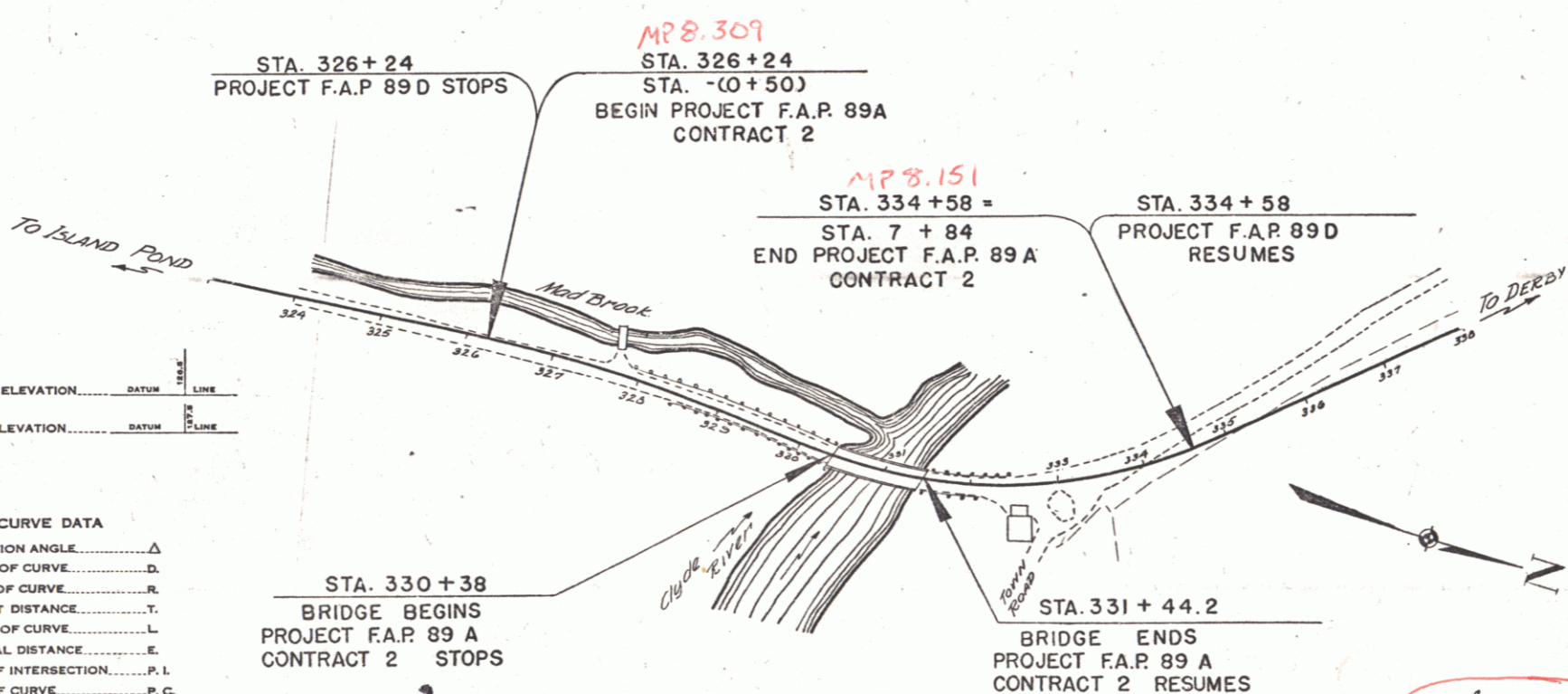

CORRECT April 25, 1938 DISTRICT HIGHWAY COMMISSIONER  
 CORRECT April 29, 1938 ROAD ENGINEER  
 SERIES F.A.P. NO. 89A FILED SHEET 1 OF 11

DIST. # 9 Plans  
 1