

INDEX OF SHEETS

| SHEET NO. | TITLE PAGE  |
|-----------|---|
| 1         | TITLE PAGE  |
| 2         | TYPICAL CROSS-SECTION OF IMPROVEMENT WITH REFINED TAR ITEMS 25 & 30 |
| 3         | BANKING AND WIDENING TABLES   |
| 4-10      | PLAN AND PROFILE SHEETS   |
| 11        | STANDARD STRUCTURE SHEET S 28 PIPE CULVERTS                         |
| 12        | " " " " SCW 2-3 BOX CULVERTS  |
| 13        | " " " " SC 2-4 " "  |
| 14        | " " " " S 30 GUARD RAIL   |
| 15        | " " " " S 30 A STANDARD UNDERDRAIN                                  |
| 16        | " " " " S 31 BOUNDARY MARKERS                                       |
| 17        | " " " " S 40 BARRICADES SIGNS & LIGHTS                              |
| 18        | " " " " S 41 ROUNDING OF SLOPES                                     |
| 19        | DETAILS 10 X 4 R.C. BOX STA. 557+98                                 |
| 20-56     | CROSS SECTIONS  |

STANDARD STRUCTURE SHEET S 28 APPROVED BY THE CHIEF ENGINEER ON JULY 11, 1933, S 30 AUGUST 15, 1933, S 31 JULY 25, 1934

| FED. ROAD DIST. NO. | STATE | FED. AID PROJ. NO. | FISCAL YEAR | SHEET NO. | TOTAL SHEETS |
|---------------------|-------|--------------------|-------------|-----------|--------------|
| 9                   | VT.   | 702(V)             | 1940        | 1         | 56           |

STATE OF VERMONT  
STATE HIGHWAY DEPARTMENT

PLAN AND PROFILE OF PROPOSED  
STATE HIGHWAY

FEDERAL AID PROJECT

TOWN OF CHARLESTON Pin# 00R204

ISLAND POND DERBY ROAD  
BEGINNING AT A POINT ON ROUTE 105 1.857 MILES  
EASTERLY OF THE JUNCTION OF ROUTES 105 & 5A  
AND EXTENDING WESTERLY 1.730 MILES TO A POINT  
0.127 MILES EASTERLY OF THE JUNCTION OF  
ROUTES 105 & 5A.

LENGTH OF PROJECT 9137.7 FT. = 1.730 MILES

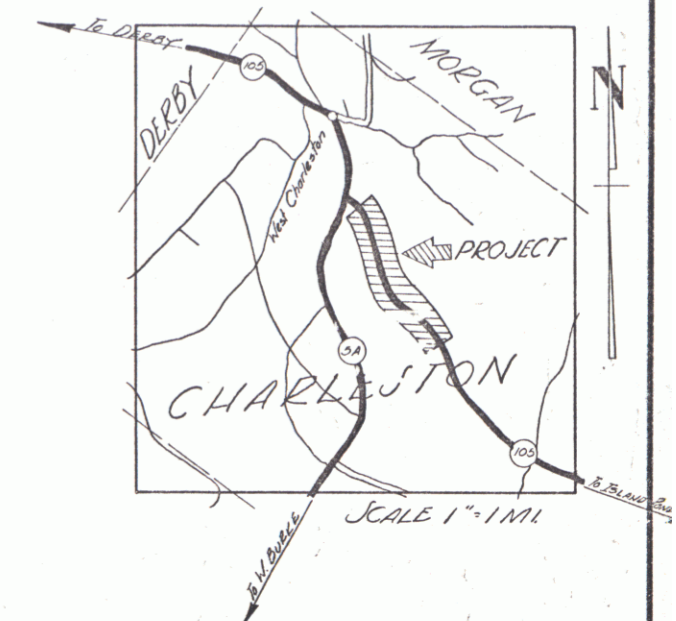

(To Be Returned To R.O.W. Division)  
Town of VT 105  
PERPETUAL  
TOWN FILE  
RIGHT-OF-WAY DIVISION

RECORD PLANS

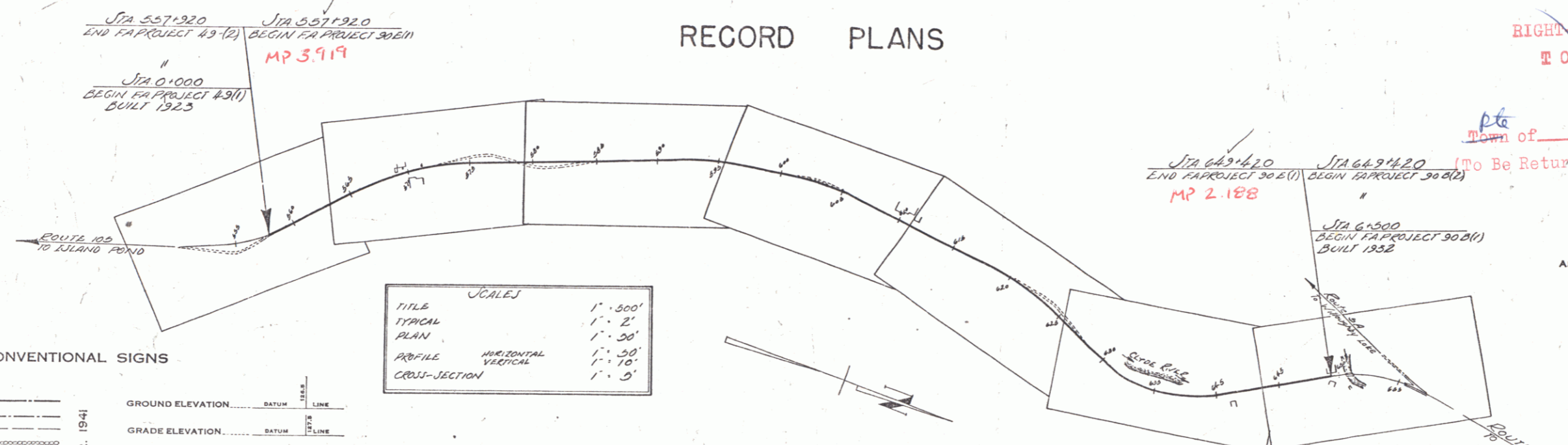

RIGHT-OF-WAY DIVISION  
TOWN FILE  
PERPETUAL  
Town of VT 105  
(To Be Returned To R.O.W. Division)

APPROVED: Sept 16 1939  
H.E. Dargatz  
COMMISSIONER OF HIGHWAYS

SUBMITTED BY ORDER OF THE STATE HIGHWAY BOARD

NOTE: ANY FURTHER INVESTIGATION CONCERNING FINAL QUANTITIES, AMOUNTS OR OTHER DETAILS RELATIVE TO THIS PROJECT MAY BE FOUND IN EITHER THE FIELD BOOKS OR THE ESTIMATE FILE.

These plans are subject to such revisions as may be required by the Public Roads Administration or the Commissioner of Highways. Construction is to be carried on in accordance with the plans and Standard Road and Bridge Specifications of 1936 as approved December 29 1936 by the Public Roads Administration, including all subsequent approved revisions and such revised specifications and special provisions as are submitted with the plans.

RECOMMENDED FOR APPROVAL:  
DISTRICT ENGINEER  
PUBLIC WORKS ADMINISTRATION  
FEDERAL WORKS AGENCY  
APPROVED:  
COMMISSIONER  
PUBLIC WORKS ADMINISTRATION  
FEDERAL WORKS AGENCY

SCALES

|               |           |
|---------------|-----------|
| TITLE         | 1" = 500' |
| TYPICAL PLAN  | 1" = 2'   |
| PLAN          | 1" = 20'  |
| PROFILE       | 1" = 20'  |
| CROSS-SECTION | 1" = 5'   |

CONVENTIONAL SIGNS

|                       |            |
|-----------------------|------------|
| GROUND ELEVATION      | BATHY LINE |
| GRADE ELEVATION       | BATHY LINE |
| DEFLECTION ANGLE      | △          |
| DEGREE OF CURVE       | D          |
| RADIUS OF CURVE       | R          |
| TANGENT DISTANCE      | T          |
| LENGTH OF CURVE       | L          |
| EXTERNAL DISTANCE     | E          |
| POINT OF INTERSECTION | P. I.      |
| POINT OF CURVE        | P. C.      |
| POINT OF TANGENT      | P. T.      |
| POINT ON TANGENT      | P. O. T.   |

CHARLESTON, FAP 90 E (I)  
RECORD PLANS - J. J. PINE, MAR. 1941  
CONTR. - FOME CONST. CO.  
FISCAL YEAR 1940

CONTRACTOR: Lorne Construction Co.  
YEAR 1940  
LOCATION: Island Pond Derby road, beginning at junction of Rts. 105 & 5A  
TYPE: 2 1/2" Crushed Gravel Mixed in Place Surface Course  
WITH REFINED TAR ITEMS 25 & 30

APPROVED: Sept 16 1939  
H.E. Dargatz  
COMMISSIONER OF HIGHWAYS

SERIES F.A.P. NO. 702(V) FILED  
SHEET 1 OF 56