

F.A.P. 90-C
WOOD GUARD RAIL

STATION	LT	RT
356+7.33	28'	28'

FEDERAL STATE
90-C 1936 12 15

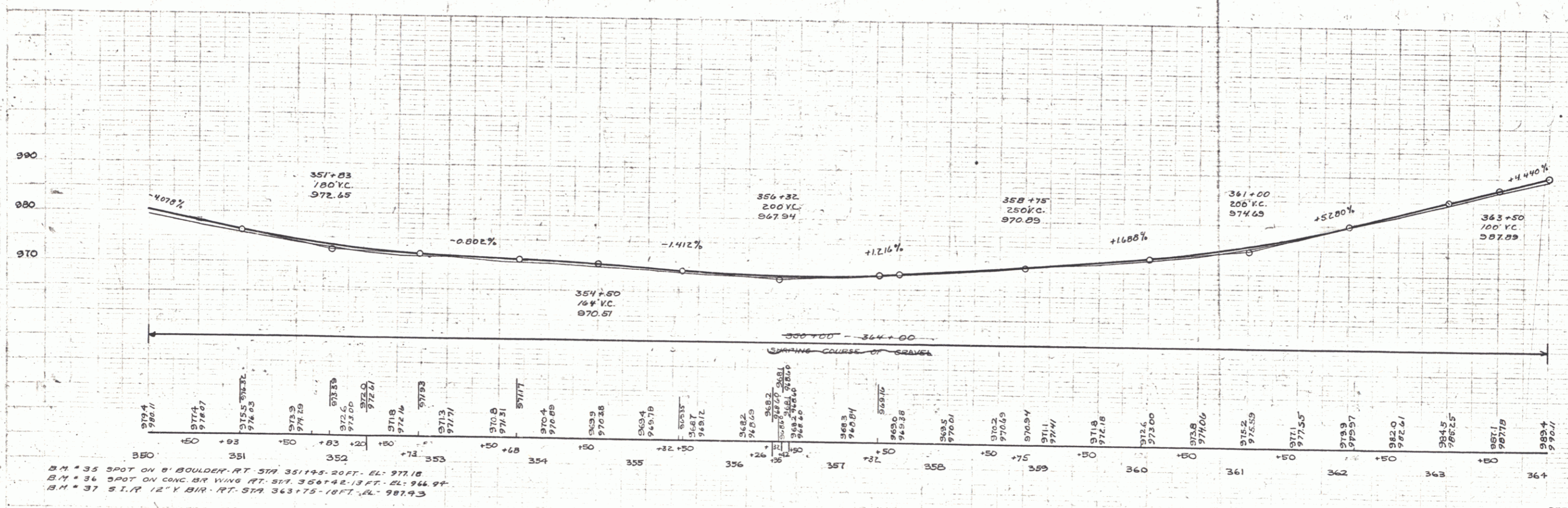
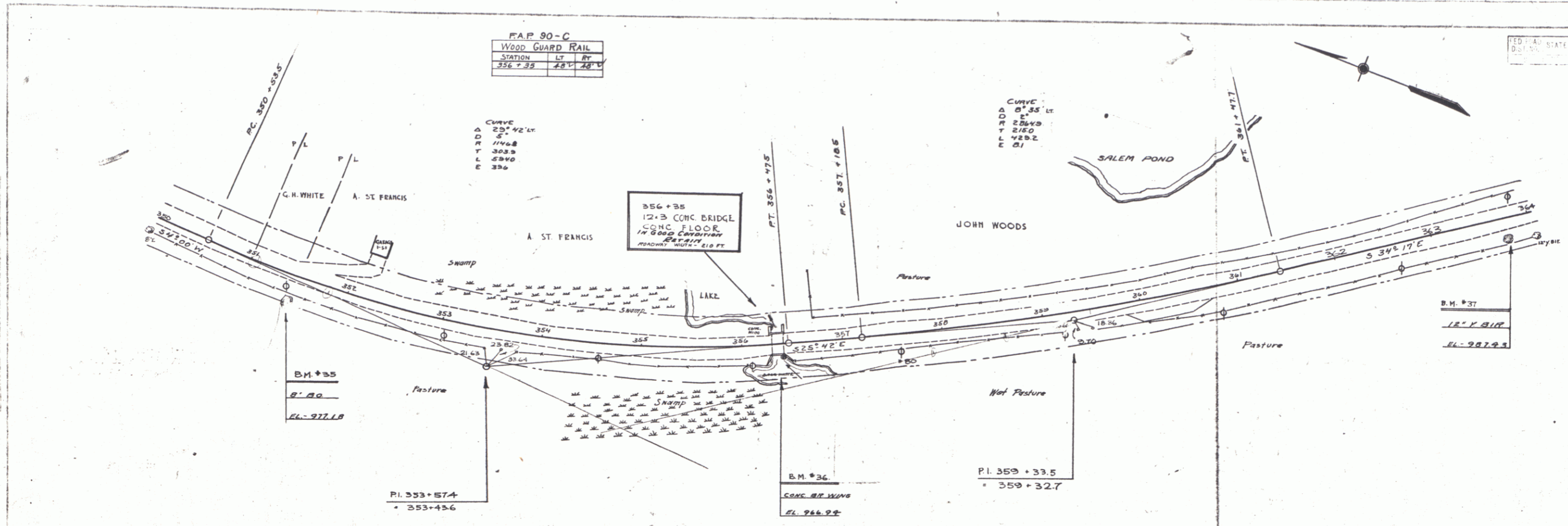

TEACED
D. MACCHI
5/17/34

D. MACCHI
5/17/34

B.M. # 35 SPOT ON B' BOULDER AT STA 351+45.20 FT. EL. 977.18
B.M. # 36 SPOT ON CONC BR WING AT STA 354+42.13 FT. EL. 944.94
B.M. # 37 S.T.R. 12" V BIR AT STA 363+75.10 FT. EL. 987.93

SERIES F.A.P. No. 90-C
SHEET 12 OF 15