

INDEX OF SHEETS

SHEET NO.	TITLE PAGE
1	TYPICAL CROSS-SECTION OF IMPROVEMENT
2	PLAN AND PROFILE STA. 0+00 to 0+25
3	BRIDGE PLANS STA. 11+71 to 13+01
4-10	Cross Sections

FED. ROAD DIST. NO.	STATE	FED. AID PROJECT NO.	YEAR	SHEET NO.	TOTAL SHEETS
9	Vt.	307	1926	1	10

STATE OF VERMONT
STATE HIGHWAY DEPARTMENT

PLAN AND PROFILE OF PROPOSED
STATE HIGHWAY
FEDERAL AID PROJECT

TOWN OF DERBY
NEWPORT, VT.-NO. STRATFORD, N.H. ROAD
BRIDGE OVER CLYDE RIVER
DERBY, VT.

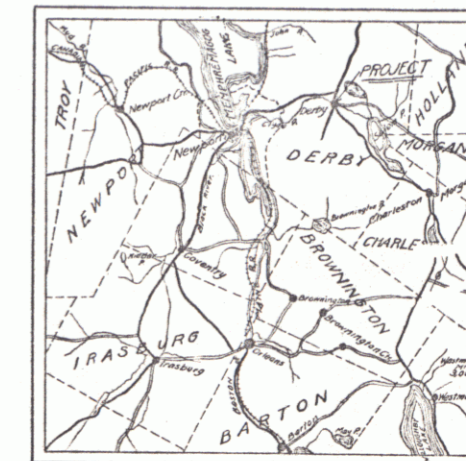

Scales:-
Plan 1 in. = 50 ft.
Profile Horiz. 1 in. = 50 ft.
Vert. 1 in. = 10 ft.
Cross Sections - 1 in. = 5 ft.

LAYOUT
SEE SHEET 3.

Brt # 64
MP 0.761-0.671
RIGHT-OF-WAY DIVISION
TOWN FILE
PERPETUAL
Town of VT 105
(To Be Returned To R.O.W. Division)

Date: May 10, 1926
APPROVED: [Signature]
Chief Engineer.

SUBMITTED BY ORDER OF THE STATE HIGHWAY BOARD
MAY 10, 1926
[Signature]
Commissioner of Highways.

Pin # 00R200

RECOMMENDED
DISTRICT ENGINEER
BUREAU OF PUBLIC ROADS
RECOMMENDED FOR APPROVAL
CHIEF ENGINEER
BUREAU OF PUBLIC ROADS
APPROVED
DIRECTOR - BUREAU OF PUBLIC ROADS

SERIES F No 004 FILED
SHEET (1) OF 10

CONVENTIONAL SIGNS

COUNTY LINE	-----	GROUND ELEVATION	DATUM	LINE
TOWN LINE	-----	GRADE ELEVATION	DATUM	LINE
FENCE LINE	-----			
STONE WALL	-----			
UNFENCED PROPERTY	-----			
GUARD RAIL	-----			
TRAVELED WAY	-----			
RAILROAD	-----			
RETAINING WALL	-----			
CENTER LINE	-----			
SURVEY LINE	-----			
CULVERT	-----			
DROP INLET	-----			
TROLLEY POLE	-----			
POWER POLE	-----			
TELEPHONE POLE	-----			
TREES	-----			
HEDGE	-----			

CURVE DATA	
DEFLECTION ANGLE	Δ
DEGREE OF CURVE	D.
RADIUS OF CURVE	R.
TANGENT DISTANCE	T.
LENGTH OF CURVE	L.
EXTERNAL DISTANCE	E.
POINT OF INTERSECTION	P. I.
POINT OF CURVE	P. C.
POINT OF TANGENT	P. T.

DIST. # 9 PLANS
1

WOOD GUARD RAIL REQUIRED
 ~ LEFT ~
 STA 11+31 to STA 11+71 LENGTH 40 FT.
 13+03 13+27 24'
 ~ RIGHT ~
 STA 11+23 to STA 11+71 LENGTH 48 FT.
 13+03 13+27 24'
 TOTAL → 136 FT

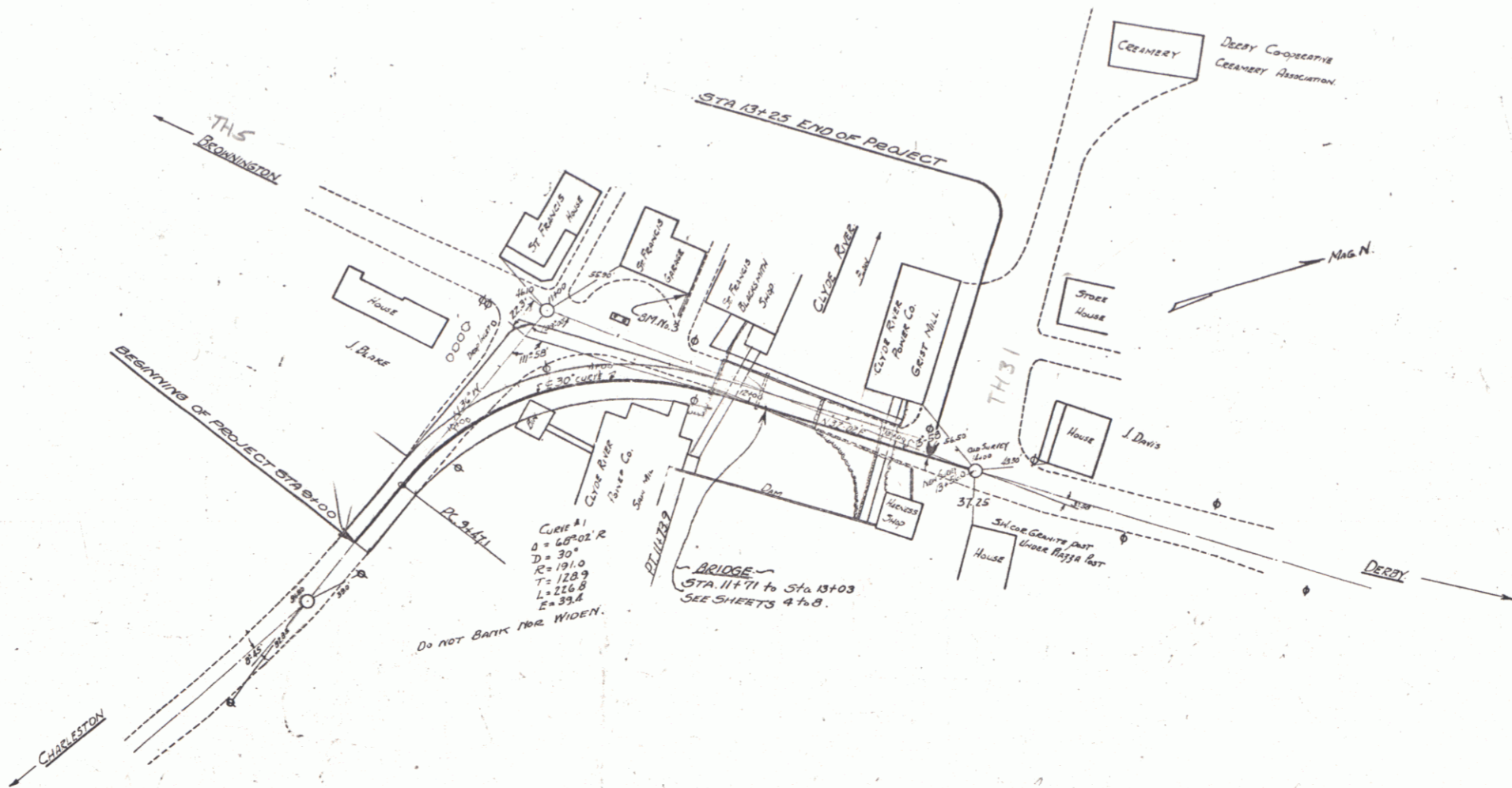

NOTE
 EMBANKMENT NECESSARY FOR APPROACHES
 TO BE MADE FROM STRUCTURE EXCAVATION.

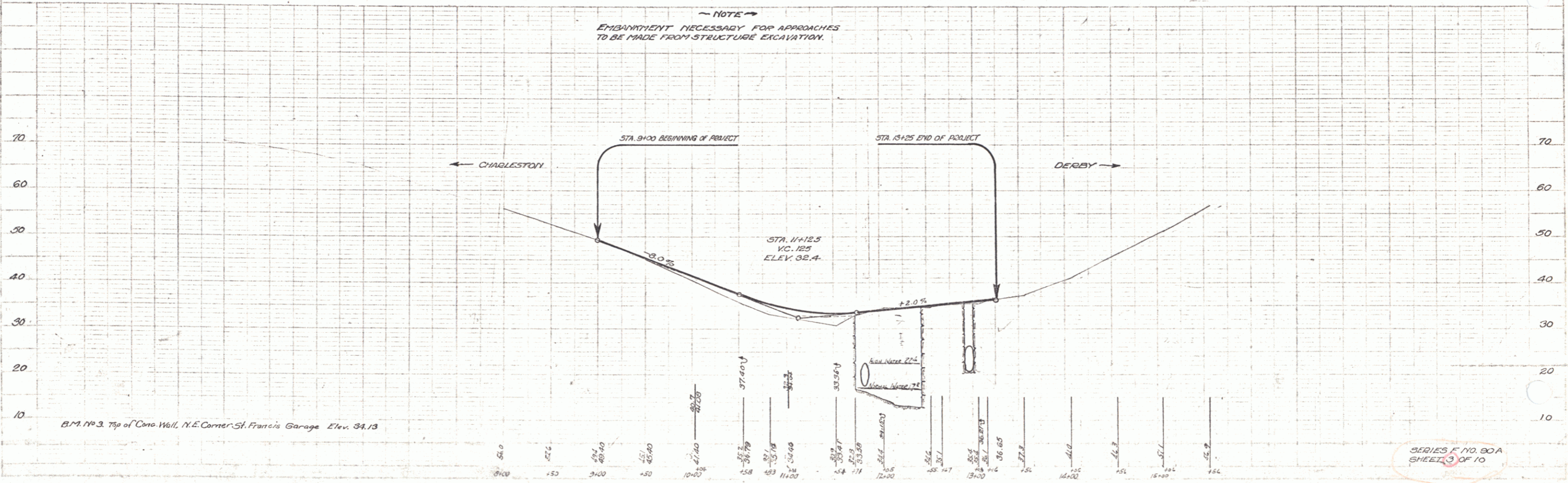

SERIES F. NO. 90A
 SHEET 3 OF 10