

WOOD GUARD RAIL REQUIRED  
 ~ LEFT ~  
 STA 11+31 to STA 11+71 LENGTH 40 FT.  
 13+03 13+27 24'  
 ~ RIGHT ~  
 STA 11+23 to STA 11+71 LENGTH 48 FT.  
 13+03 13+27 24'  
 TOTAL → 136 FT

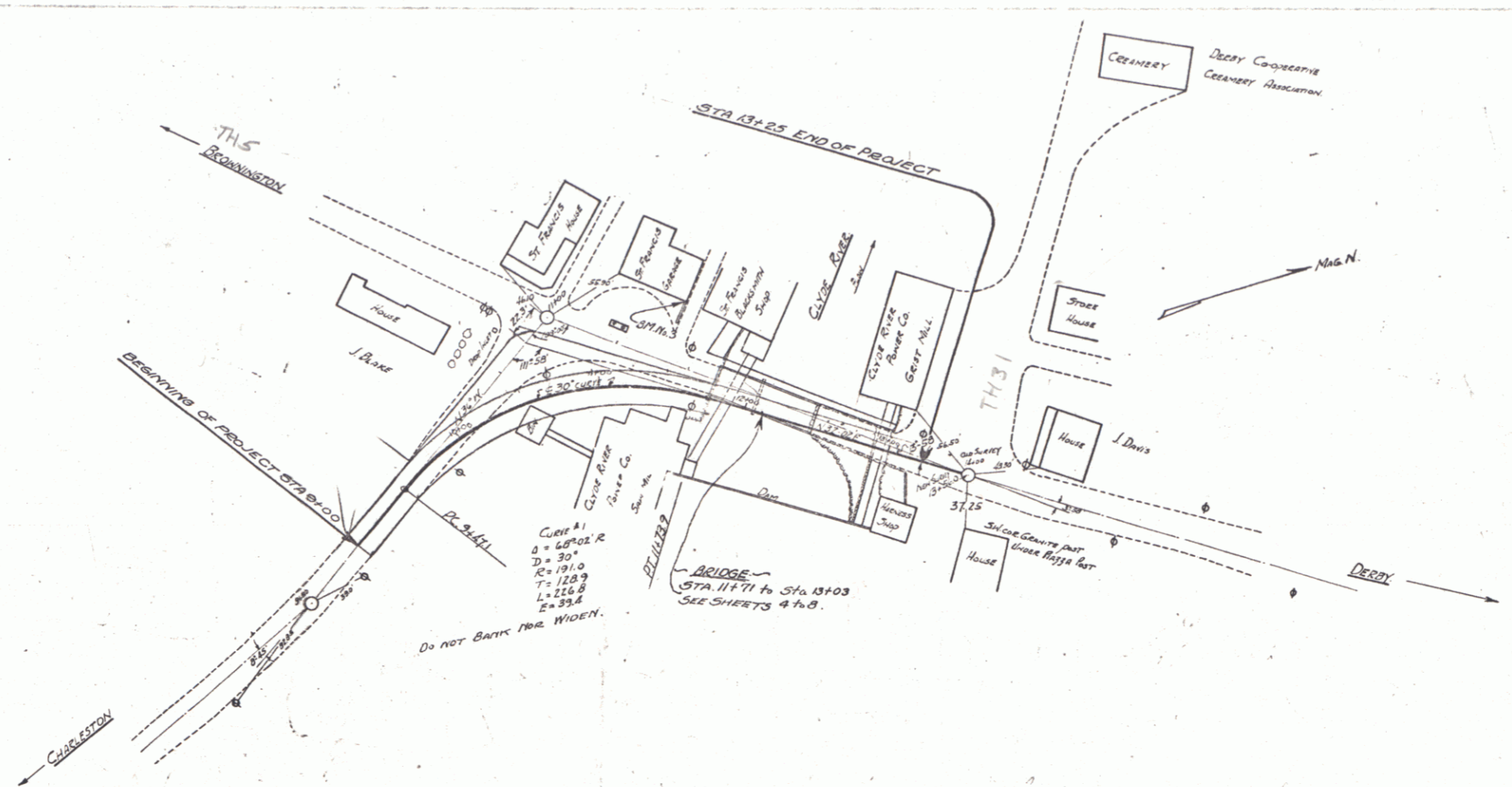

NOTE  
 EMBANKMENT NECESSARY FOR APPROACHES  
 TO BE MADE FROM STRUCTURE EXCAVATION.

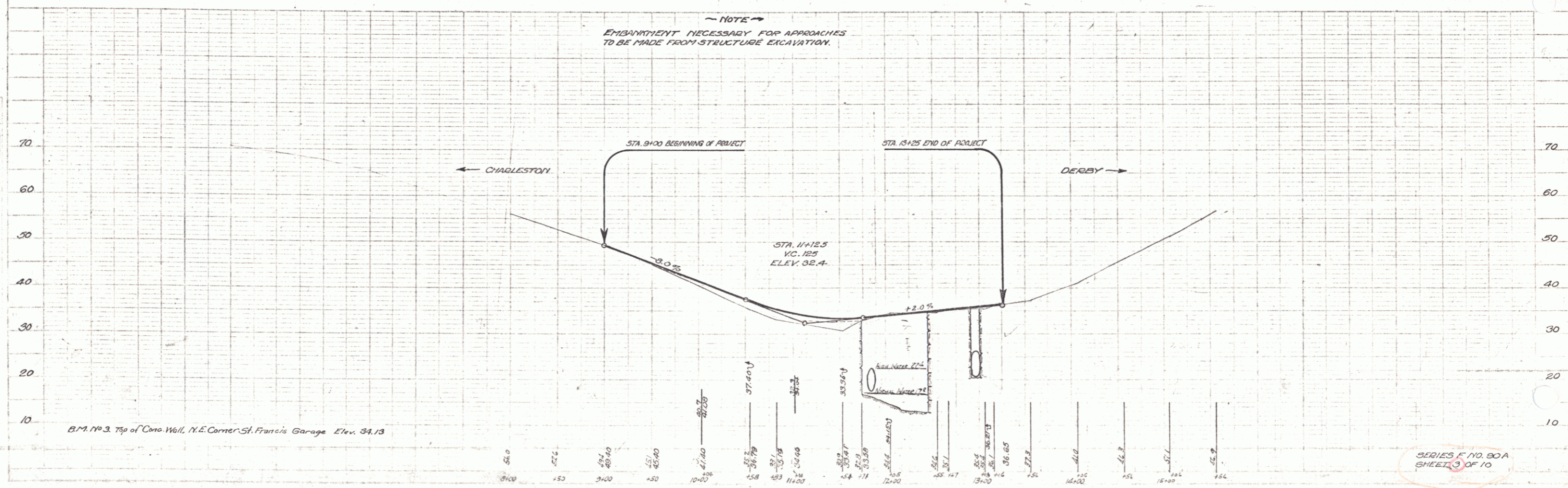

SERIES F. NO. 90A  
 SHEET 3 OF 10