

INDEX OF SHEETS

SHEET NO.	TITLE PAGE	EXTRA SHEETS
1	TYPICAL CROSS SECTION OF IMPROVEMENT. BITUMINOUS CONCRETE PAVEMENT, ITEM 361-B, MODIFIED	5A REVISED EARTHWORK SHEET
2	QUANTITY SHEET	7A REVISED EARTHWORK SHEET
3	ITEM DETAIL AND DRAINAGE SHEET.	8A-F FINAL EARTHWORK SHEETS
4	EARTHWORK SHEETS.	116A, 117A, 118A, 119A & 120A REVISED SECTIONS
5-7	EARTHWORK SUMMARY SHEET.	10 SHEETS OF STEEL PLANS
8	PLAN AND PROFILE SHEETS.	7 EXTRA X SECTION SHEETS
9-21	DETAILS OF 180" CULVERTS - STA. 96+10.	
22	PRELIMINARY INFORMATION SHEET - STA. 153+77 TO 154+10.	
23	PLAN AND ELEVATION SHEET, BRIDGE	
24	DETAILS OF ABUTMENT NO. 1.	
25	DETAILS OF ABUTMENT NO. 2.	
26	DETAILS OF SUPERSTRUCTURE.	
27	REINFORCING STEEL SCHEDULE.	
28	EARTHWORK SHEET, BRIDGE	
29	PRELIMINARY INFORMATION SHEET - STA. 163+63 TO 164+62.	
30	PLAN AND ELEVATION SHEET, BRIDGE	
31	DETAILS OF ABUTMENT NO. 1.	
32	DETAILS OF ABUTMENT NO. 2.	
33	REINFORCING STEEL SCHEDULE.	
34	PRELIMINARY INFORMATION SHEET - STA. 208+55 TO 209+09.	
35	PLAN AND ELEVATION SHEET, BRIDGE	
36	DETAILS OF SUPERSTRUCTURE.	
37	REINFORCING STEEL SCHEDULE.	
38	DETAILS OF ABUTMENT NO. 1.	
39	DETAILS OF ABUTMENT NO. 2.	
40	BRIDGE QUANTITIES AND ABUTMENT DETAILS.	
41	REINFORCING STEEL SCHEDULE.	
42	EARTHWORK SHEET, BRIDGE	
43	STANDARD DRAWING C-2 A (SIDEWALKS-DRIVE ENTRANCES)	
44	STANDARD DRAWING B-1 (BANKING TABLES).	
45	STANDARD DRAWING B-3 (TYPICAL SLOPE GRADING).	
46	STANDARD DRAWING D-8 (METAL PIPE DETAILS).	
47	STANDARD DRAWING D-9 (R.C.D.I. WITH GRATES).	
48	STANDARD DRAWING D-9 (R.C.D.I. TOP WITH GRANITE CURB).	
49	STANDARD DRAWING D-10 (DETAILS OF GRATES AND COVERS FOR USE WITH CATCH BASINS AND DRAIN INLETS).	
50	STANDARD DRAWING C-1 (CURBS).	
51	STANDARD DRAWING D-1 (PRECAST R.C.P.D.'S AND GRATES).	
52	STANDARD DRAWING D-2 (HEADWALLS AND UNDERDRAIN).	
53	STANDARD DRAWING D-3 (GUTTERS).	
54	STANDARD DRAWING G-3 (3 CABLE GUARD RAIL WITH STEEL POSTS AND ANCHORS).	
55	STANDARD DRAWING J-1 (WOOD AND STEEL MARKER AND GUIDE POSTS AND PLANK GUARD RAIL).	
56	STANDARD DRAWING J-2 (ERECTOR OF PROJECT AND BOUNDARY MARKERS).	
57	STANDARD DRAWING RS-56-13.	
58	STANDARD DRAWING BS-56-2.	
59	STANDARD DRAWING SGB-30-59 (DETAILS OF 30' ROADWAY).	
60	STANDARD DRAWING SB-20-56 WF BM DETAILS.	
61	STANDARD DRAWING SB-9-57 DETAILS OF RAILING.	
62	STANDARD DRAWING E-1 BARRICADE, SIGNS AND LIGHTS.	

STATE OF VERMONT
DEPARTMENT OF HIGHWAYS
PROPOSED IMPROVEMENT

TOWNS OF NEWPORT - TROY
COUNTY OF ORLEANS
NEWPORT - NORTH TROY ROAD VT. RTE. 105

BEGINNING AT A POINT APPROXIMATELY 2.670 MILES
SOUTHEASTERLY OF THE TROY-NEWPORT TOWN LINE
AND EXTENDING NORTHWESTERLY 3.053 MILES.

LENGTH OF ROADWAY 15,932.8 FT. = 3.018 MILES
LENGTH OF BRIDGES 186.0 FT. = 0.035 MILE
LENGTH OF PROJECT 16,118.8 FT. = 3.053 MILES

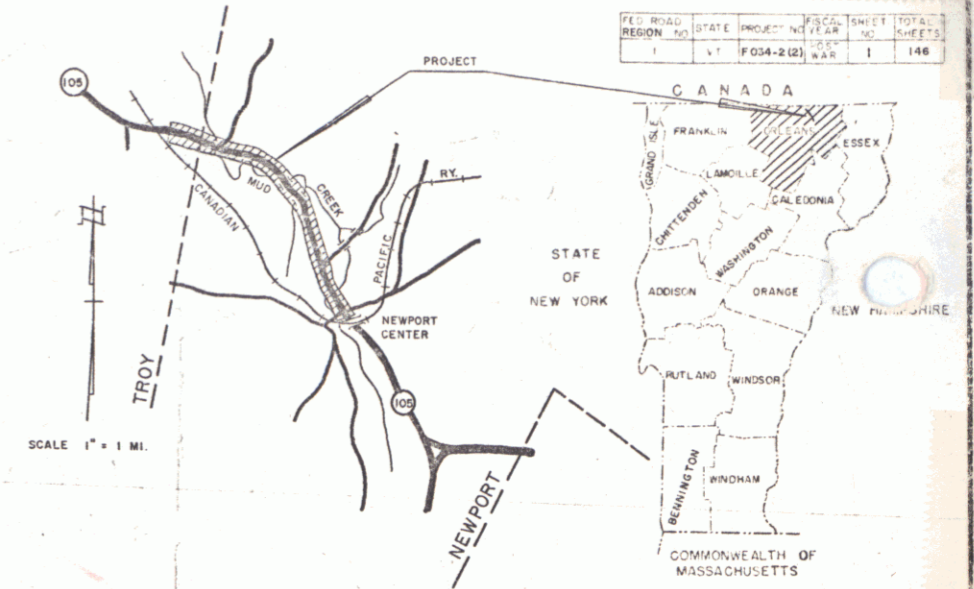

ADT 1958	675 - 800
ADT 1980(EST)	1000-1225
DIV 1980	155 - 195
D	60% TO 65%
T	8%
V	50 MPH

121-166 CHANNEL SECTIONS

PROJECT NAME & NUMBER	TYPE PAVEMENT AREA
NEWPORT-TROY F 034-2(2)	3" BIT. CONCRETE 41,227 S.Y.

RECORD PLANS MATERIALS

SUB-BASE OF GRAVEL - PERCEY'S PIT, CHAPUT PIT - NEWPORT, VT.
SMITH PIT - NO. TROY, VT.

SUB-BASE OF SAND - PERCEY'S PIT - NEWPORT, VT.
SMITH PIT - NO. TROY, VT.

CRUSHED GRAVEL & GRAVEL FOR SHOULDERS - CALKINS PLANT - NEWPORT, VT.
REFINED TAR & CUTBACK ASPHALT - MOBIL OIL CO. - E. PROVIDENCE, R.I.
BITUMINOUS CONCRETE - NORTHEASTERN PAVING INC. - WESTBROOK, MAINE.
CONCRETE CLASS "B" - ANDERSON READY MIX - WATERBURY, VT.
REINFORCING STEEL - VT. STRUCTURAL STEEL CO. - BURLINGTON, VT.
REINFORCING STEEL - VT. CONCRETE PIPE CO. - WINDSOR, VT.
A.C.C.S. METAL PIPE - NEW ENGLAND METAL PIPE CO. - ESSEX JCT., VT.
THREE CABLE GUARD RAIL, STEEL MARKER & GUIDE POSTS & BRIDGE
RAILING - S.T. GRISWOLD CO. INC. - ESSEX JUNCTION, VT.
GRANITE CURB - ROCK OF AGES CORP. - BARRE, VT.

CONTRACTOR - RALPH B. GOODRICH INC.
50, BURLINGTON, VT.
RES. ENG. - E. C. GLYSSON
INSPECTOR - FRED H. REED
RECORD PLANS - E. C. GLYSSON.

CONTRACT DATED - DEC. 9, 1959.
STARTED - JAN. 27, 1960.
COMPLETED - AUG. 1, 1961.
ACCEPTED - AUG. 1, 1961.

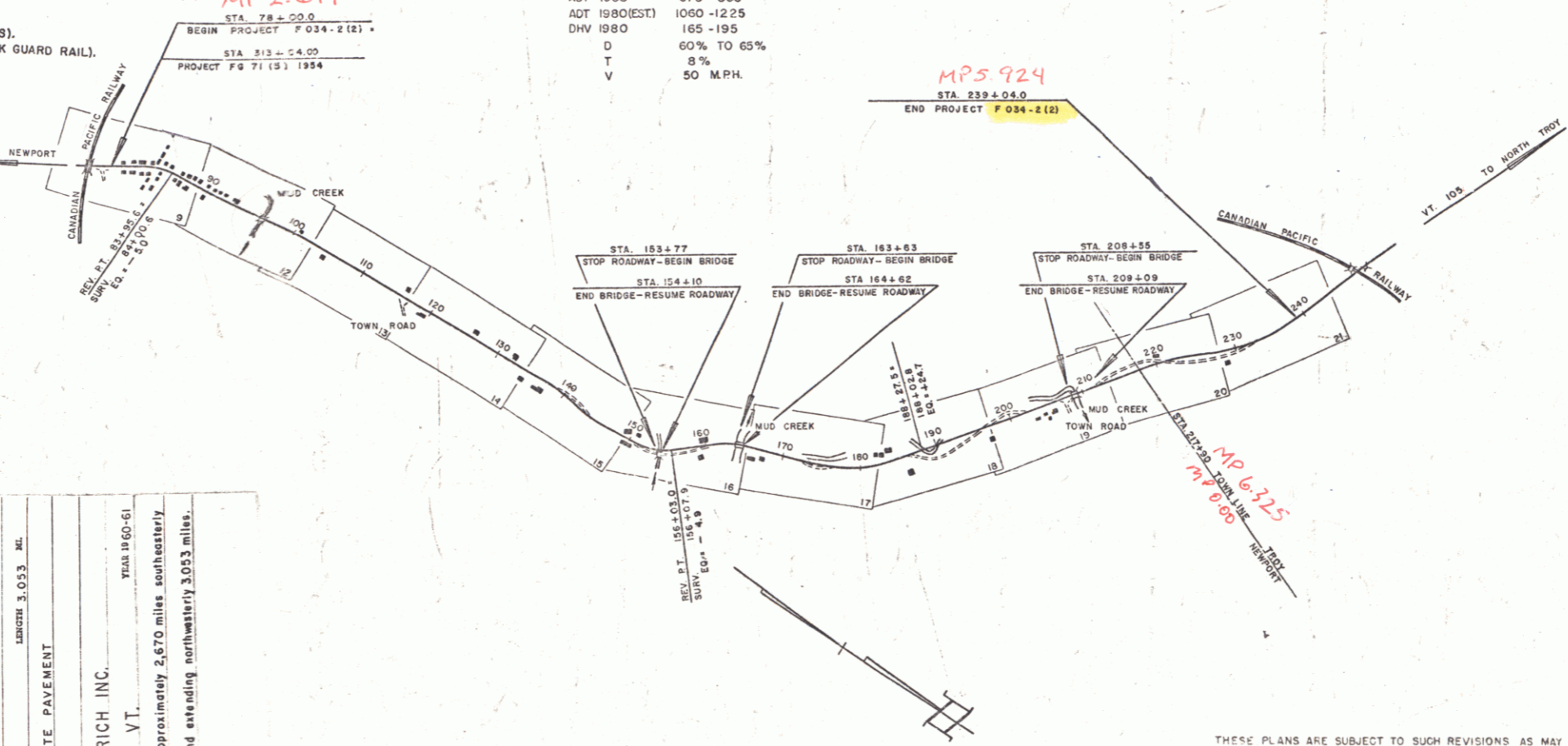

CONVENTIONAL SIGNS

R.O.W.	---
COUNTY LINE	---
TOWN LINE	---
FENCE LINE	---
STONE WALL	---
UNFENCED PROPERTY	---
GUARD RAIL	---
TRAVELED WAY	---
RAILROAD	---
RETAINING WALL	---
CENTER LINE	---
SURVEY LINE	---
CULVERT	---
DROP INLET	---
TROLLEY POLE	---
POWER POLE	---
TELEPHONE POLE	---
TREES	---
HEDGE	---

CONTRACTOR RALPH B. GOODRICH INC.
50, BURLINGTON, VT.
RECORD PLANS E. C. GLYSSON
COMPLETED AUGUST 1, 1961.

PROJECT NEWPORT-TROY
ITEM F. 034-2(2)
TYPE 3" BITUMINOUS CONCRETE PAVEMENT
CONTRACTOR RALPH B. GOODRICH INC.
50, BURLINGTON, VT.
STARTED 1960-51
Location Beginning at a point approximately 2.670 miles southeasterly
of the Troy-Newport Town Line and extending northwesterly 3.053 miles.

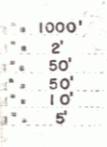

THESE PLANS ARE SUBJECT TO SUCH REVISIONS AS MAY BE
REQUIRED BY THE BUREAU OF PUBLIC ROADS OR THE COMMISSIONER
OF HIGHWAYS.

CONSTRUCTION IS TO BE CARRIED ON IN ACCORDANCE WITH
THE PLANS AND THE STANDARD SPECIFICATIONS FOR HIGHWAY AND BRIDGE
CONSTRUCTION OF JANUARY 1956 SUBMITTED TO THE BUREAU OF
PUBLIC ROADS AS APPROVED JULY 5, 1956, INCLUDING ALL SUBSEQUENT
APPROVED REVISIONS AND SUCH REVISED SPECIFICATIONS AND SPECIAL
PROVISIONS AS ARE SUBMITTED WITH THE PLANS.

NOTE: ANY FURTHER INFORMATION CONCERNING
FINAL QUANTITIES, AMOUNTS AND OTHER DETAILS
RELATIVE TO THIS PROJECT MAY BE FOUND IN
EITHER THE FIELD BOOKS OR THE ESTIMATE
FILE.

DEPARTMENT OF COMMERCE
BUREAU OF PUBLIC ROADS

APPROVED DATE	APPROVED DATE	APPROVED DATE	APPROVED DATE	APPROVED DATE	APPROVED DATE
SECONDARY ENGINEER	CONSTRUCTION ENGINEER	BRIDGE ENGINEER	DISTRICT ENGINEER	HIGHWAY ENGINEER	CITY ENGINEER
	Nov 21, 1958	Nov 24, 1958	12/1/58	11/21/58	Nov 24, 1958

APPROVED

DIVISION ENGINEER

PROJECT F NO. 034

SHEET 1 OF 146 SHEETS